

WAT EPA
EPAX 800
9110-1990.3
0054
C2

United States
Environmental Protection
Agency

Office of Water
(WH-550B)

March 1990



Federal Reporting Data System (FRDS-II)

Data Entry Instructions

#24527364

HEADQUARTERS LIBRARY
ENVIRONMENTAL PROTECTION AGENCY
WASHINGTON, D.C. 20460

DEC 17 1991



Release Log

Change Notice

[illegible]

FRDS DATA ENTRY INSTRUCTIONS

TABLE OF CONTENTS

CHAPTER	TITLE	PAGE
---------	-------	------

General Information

	Introduction.....	1
I	Forms Description.....	2
II	Data Transfer File.....	25
III	Position Concept.....	31
IV	Data Base Registration Requirement.....	33
V	Data Element Removal vs. Data Base Record Deletion.....	36
VI	Record Identification and Maximum Occurrences.....	38
VII	General Coding Instructions.....	45

Detail Information

VIII	Detailed Coding Instructions.....	50
------	-----------------------------------	----

Data Capture Form A

Section A1 - System Address.....	51
Section A2 - Public Water System Characteristics.....	55
Section A3 - Other Address(es).....	62

Data Capture Form B

Section B1 - Source / Entity Data.....	67
Section B2 - Treatment Data.....	76

Data Capture Form C

Section C1 - Geographic Areas Served.....	81
Section C2 - Service Areas.....	85
Section C3 - On-Site Visits.....	88

FRDS DATA ENTRY INSTRUCTIONS

TABLE OF CONTENTS

CHAPTER	TITLE	PAGE
VIII (cont.)	Data Capture Form D	
	Section D1 - Violation Data.....	92
	Data Capture Form E	
	Section E1 - Enforcement Data.....	99
	Data Capture Form F	
	Section F1 - Variances, Exemptions & Other Related Data.....	106
	Section F2 - VE Schedule.....	111
	Data Capture Form G	
	Section G1 - State Discretionary Data...	116
IX	Record Deletion Form.....	120
	Appendixes	
	Appendix A - Examples of Data Capture Form / Data Transfer File.....	A-1
	Appendix B - Edit/Update.....	B-1
	Appendix C - Anytown, USA, Coded Source/Entity Examples.....	C-1
	Appendix D - Data Base Registration/Grant Eligibility At-A-Glance.....	D-1

FRDS DATA ENTRY INSTRUCTIONS

TABLE OF CONTENTS

Figures

Figure 1 (Section A1 DBR Relationship).....	5
Figure 2 (Section A2 DBR Relationship).....	6
Figure 3 (Section A3 DBR Relationship).....	7
Figure 4 (Section B1 DBR Relationship).....	9
Figure 5 (Section B2 DBR Relationship).....	10
Figure 6 (Section C1 DBR Relationship).....	13
Figure 7 (Section C2 DBR Relationship).....	14
Figure 8 (Section C3 DBR Relationship).....	15
Figure 9 (Section D1 DBR Relationship).....	17
Figure 10 (Section E1 DBR Relationship).....	19
Figure 11 (Section F1 DBR Relationship).....	21
Figure 12 (Section F2 DBR Relationship).....	22
Figure 13 (Section G1 DBR Relationship).....	24
Figure 14 (FORM A).....	66
Figure 15 (TOWNSHIP/RANGE).....	72
Figure 16 (FORM B).....	80
Figure 17 (FORM C).....	91
Figure 18 (FORM D).....	98
Figure 19 (FORM E).....	105
Figure 20 (FORM F).....	115
Figure 21 (FORM G).....	119
Figure 22 (RECORD DELETION FORM).....	122

FRDS-II DATA ENTRY INSTRUCTIONS

INTRODUCTION

The FRDS-II Data Capture Forms are designed to assist the FRDS-II System users in their data collection efforts. It should be noted that these forms are intended for data collection only and not for direct input to the FRDS-II System, which will be accomplished via the FRDS-II Data Transfer Format. It is hoped that the way in which data is presented on these forms will assist the user in the transition to the FRDS-II Data Transfer Format.

These data entry instructions are meant to be as comprehensive as possible. However, there are issues related to FRDS-II data that are programmatic in nature, and these issues are not generally discussed here. A more comprehensive and detailed discussion of programmatic versus technical issues, definitions of data elements, table references, and glossary may be found in the Federal Reporting Data System Data Element Dictionary.

This document is arranged into two major parts. The first part (consisting of Chapters I through VII) contains general information that pertains to all Data Capture Forms and to the FRDS-II System as a whole. The second part (Chapters VIII and IX) contains all of the detailed information that pertains to each individual Data Capture Form.

FRDS-II DATA ENTRY INSTRUCTIONS

GENERAL INFORMATION

CHAPTER I

FORMS DESCRIPTION

FRDS-II DATA ENTRY INSTRUCTIONS

GENERAL INFORMATION

FORMS DESCRIPTION

There are eight different FRDS-II Data Capture Forms (Forms A - G and a Record Deletion Form). The following is an overview of forms A - G, their sections, and the information contained therein. The Record Deletion form is discussed in Chapter IX, "Record Deletion Form."

o FORM A

Section A1 - SYSTEM ADDRESS (See Figure 1)

This section is used to enter facility name and address information for a public water system. Where multiple facilities exist for a public water system at different locations, this section should be used to enter address information for the system as a whole. The following data may be entered via this section:

DATA ELEMENT #	FORM REFERENCE NAME
C131	- SYSTEM NAME
C133	- ADDRESS LINE 1
C135	- ADDRESS LINE 2
C137	- CITY
C139	- STATE
C141	- ZIP CODE + 4
C143	- TELEPHONE (AREA CODE & NUMBER)

Section A2 - PUBLIC WATER SYSTEM CHARACTERISTICS (See Figure 2)

This section is used to enter data related to the various physical characteristics of the public water system. The following data may be entered via this section:

DATA ELEMENT #	FORM REFERENCE NAME
C105	- PWS TYPE
C107	- ACTIVITY FLAG
C111	- SYSTEM BEGIN (YR & MO)
C113	- DEACTIVATION DATE (YR & MO)
C117	- RETAIL POPULATION SERVED
C121	- PERCENT SURFACE
C123	- PERCENT GROUND
C125	- PERCENT PURCHASED SURFACE
C127	- PERCENT PURCHASED GROUND
C147	- RETAIL SERVICE CONNECTIONS
C159	- NON-COMMUNITY SEASON BEGIN (MO & DAY)
C161	- NON-COMMUNITY SEASON END (MO & DAY)
C163	- OWNER TYPE
C165	- REGULATING ENTITY

FORMS DESCRIPTION

Section A3 - OTHER ADDRESS(ES) (See Figure 3)

This section is used to enter additional address information, such as an owner address or related facility addresses. The following data may be entered via this section:

DATA ELEMENT #	FORM REFERENCE NAME
C301	- ADDRESS ID
C303	- ADDRESS TYPE
C305	- ADDRESSEE NAME
C307	- ADDRESS LINE 1
C309	- ADDRESS LINE 2
C311	- CITY
C313	- STATE
C315	- ZIP CODE + 4

FRDS - II DATA CAPTURE FORM TO DATA BASE RECORD RELATIONSHIP



Public Water System
Data Capture Form A

FWS ID: _____ ACTION CODE: _____ BATTERY DATE: _____
 NAME: _____ CITY: _____ STATE: _____ ZIP CODE: _____
 ADDRESS: _____ TELEPHONE: _____
 C-101

**SECTION A1
SYSTEM ADDRESS**

SYSTEM ADDRESS: _____
 ALJUR NO. LINE 1: _____
 ALJUR NO. LINE 2: _____
 CITY: _____ STATE: _____ ZIP CODE: _____
 ALJUR CODE: _____ TELEPHONE: _____
 C-102

**SECTION A2
PUBLIC WATER SYSTEM CHARACTERISTICS**

SYSTEM TYPE: _____
 SYSTEM SIZE: _____
 SYSTEM LOCATION: _____
 SYSTEM STATUS: _____
 SYSTEM COMMENTS: _____
 C-103

**SECTION A3
OTHER ADDRESSES (ES)**

ADDRESS 1: _____
 ADDRESS 2: _____
 ADDRESS 3: _____
 ADDRESS 4: _____
 ADDRESS 5: _____
 ADDRESS 6: _____
 ADDRESS 7: _____
 ADDRESS 8: _____
 ADDRESS 9: _____
 ADDRESS 10: _____
 ADDRESS 11: _____
 ADDRESS 12: _____
 ADDRESS 13: _____
 ADDRESS 14: _____
 ADDRESS 15: _____
 ADDRESS 16: _____
 ADDRESS 17: _____
 ADDRESS 18: _____
 ADDRESS 19: _____
 ADDRESS 20: _____
 ADDRESS 21: _____
 ADDRESS 22: _____
 ADDRESS 23: _____
 ADDRESS 24: _____
 ADDRESS 25: _____
 ADDRESS 26: _____
 ADDRESS 27: _____
 ADDRESS 28: _____
 ADDRESS 29: _____
 ADDRESS 30: _____
 ADDRESS 31: _____
 ADDRESS 32: _____
 ADDRESS 33: _____
 ADDRESS 34: _____
 ADDRESS 35: _____
 ADDRESS 36: _____
 ADDRESS 37: _____
 ADDRESS 38: _____
 ADDRESS 39: _____
 ADDRESS 40: _____
 ADDRESS 41: _____
 ADDRESS 42: _____
 ADDRESS 43: _____
 ADDRESS 44: _____
 ADDRESS 45: _____
 ADDRESS 46: _____
 ADDRESS 47: _____
 ADDRESS 48: _____
 ADDRESS 49: _____
 ADDRESS 50: _____
 ADDRESS 51: _____
 ADDRESS 52: _____
 ADDRESS 53: _____
 ADDRESS 54: _____
 ADDRESS 55: _____
 ADDRESS 56: _____
 ADDRESS 57: _____
 ADDRESS 58: _____
 ADDRESS 59: _____
 ADDRESS 60: _____
 ADDRESS 61: _____
 ADDRESS 62: _____
 ADDRESS 63: _____
 ADDRESS 64: _____
 ADDRESS 65: _____
 ADDRESS 66: _____
 ADDRESS 67: _____
 ADDRESS 68: _____
 ADDRESS 69: _____
 ADDRESS 70: _____
 ADDRESS 71: _____
 ADDRESS 72: _____
 ADDRESS 73: _____
 ADDRESS 74: _____
 ADDRESS 75: _____
 ADDRESS 76: _____
 ADDRESS 77: _____
 ADDRESS 78: _____
 ADDRESS 79: _____
 ADDRESS 80: _____
 ADDRESS 81: _____
 ADDRESS 82: _____
 ADDRESS 83: _____
 ADDRESS 84: _____
 ADDRESS 85: _____
 ADDRESS 86: _____
 ADDRESS 87: _____
 ADDRESS 88: _____
 ADDRESS 89: _____
 ADDRESS 90: _____
 ADDRESS 91: _____
 ADDRESS 92: _____
 ADDRESS 93: _____
 ADDRESS 94: _____
 ADDRESS 95: _____
 ADDRESS 96: _____
 ADDRESS 97: _____
 ADDRESS 98: _____
 ADDRESS 99: _____
 ADDRESS 100: _____
 C-104

Federal Reporting Data System (FRDS II)
Structure Chart

FRDS II
Part 1

FRDS II
Part 2

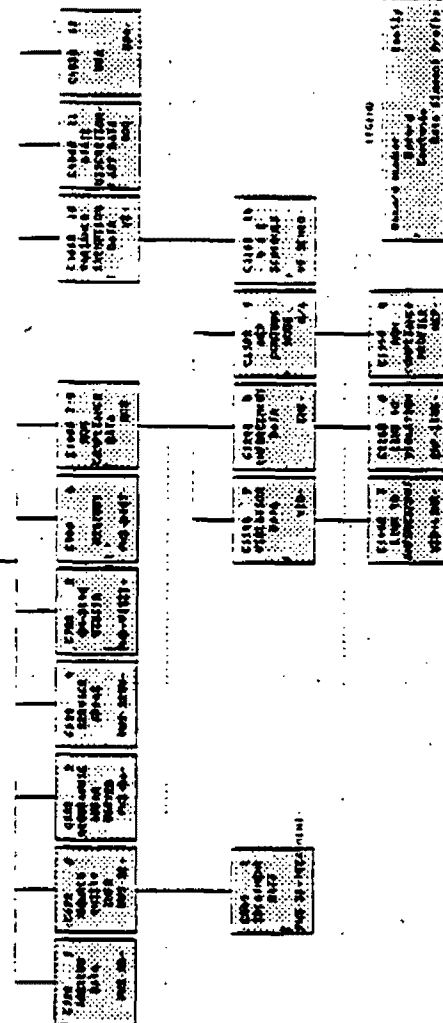

FRDS - 11



ESTADO LIBRE

PUBLIC WATER SYSTEM CHARACTERISTICS

OTHER ADDRESSES



SECTION A2

11 - SCNY

DATE

SECTION A3

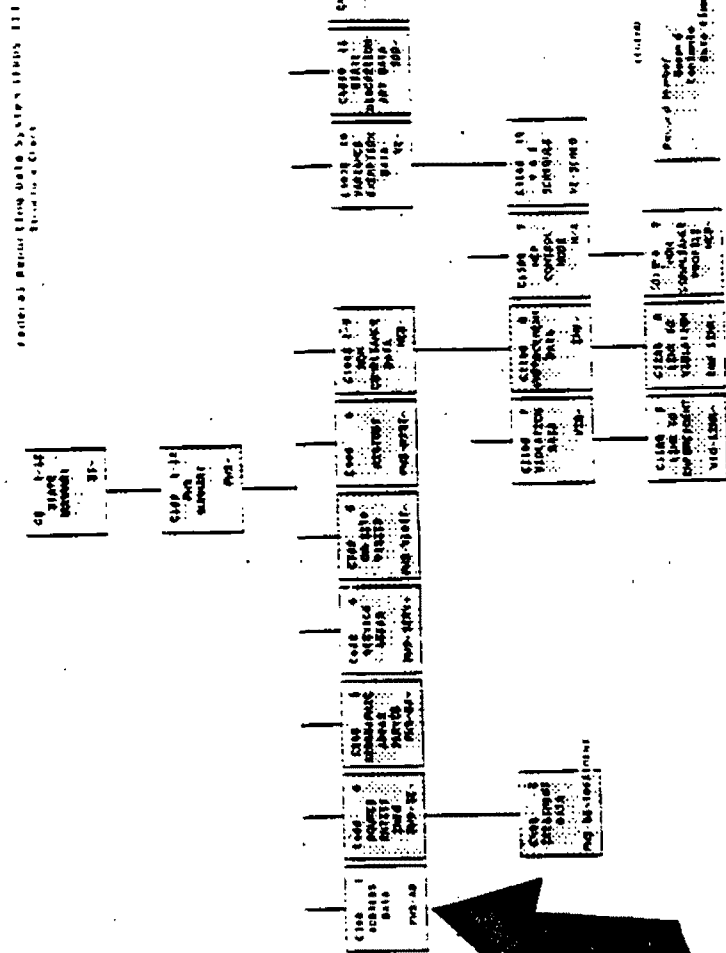
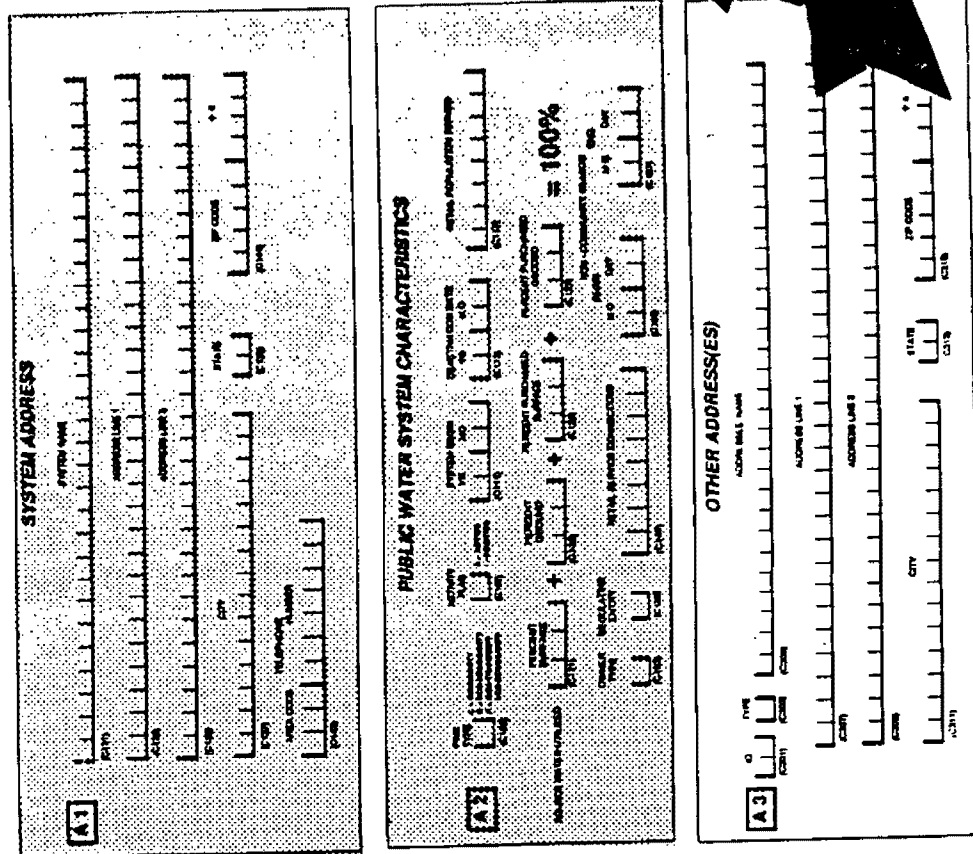



DATA CAPTURE FORM TO DATA BASE RECORD RELATIONSHIP

Public Water System
Data Capture Form B



SECTION B1 SOURCE / ENTITY DATA

Public Water System Data Capture Form B

SECTION B1 SOURCE / ENTITY DATA

B1

NAME: _____

DATE: _____

TIME: _____

LOCATION: _____

STATUS: _____

REMARKS: _____

B2

TREATMENT DATA

DATE: _____

TIME: _____

LOCATION: _____

STATUS: _____

REMARKS: _____

Public Water System Data Capture Form B

SECTION B2 SOURCE / ENTITY DATA

B1

NAME: _____

DATE: _____

TIME: _____

LOCATION: _____

STATUS: _____

REMARKS: _____

B2

TREATMENT DATA

DATE: _____

TIME: _____

LOCATION: _____

STATUS: _____

REMARKS: _____

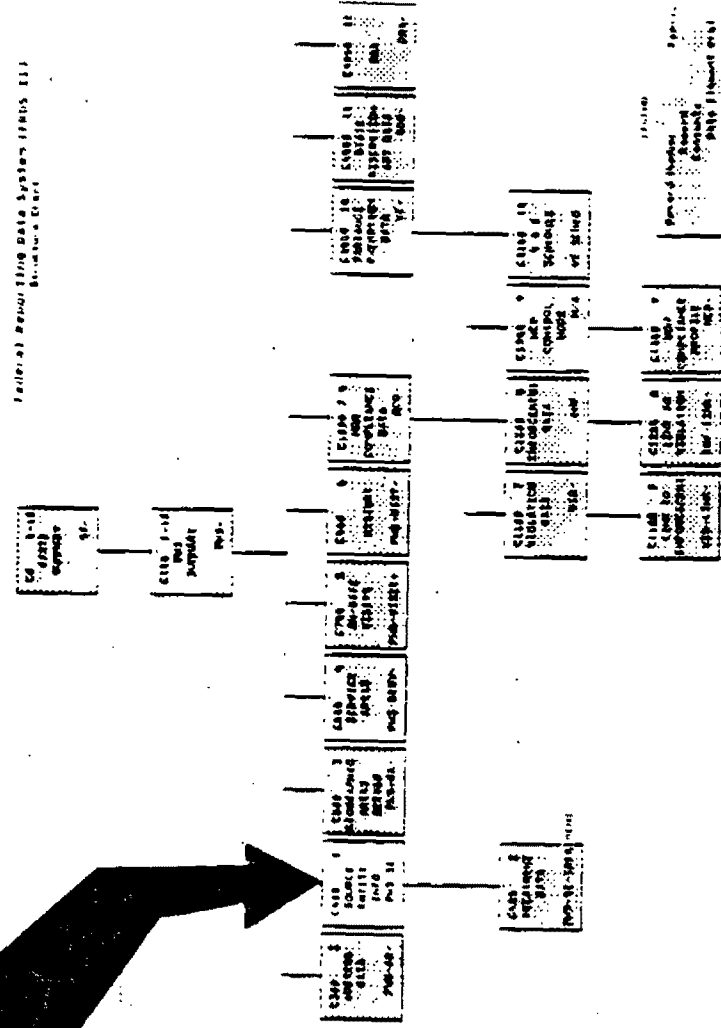
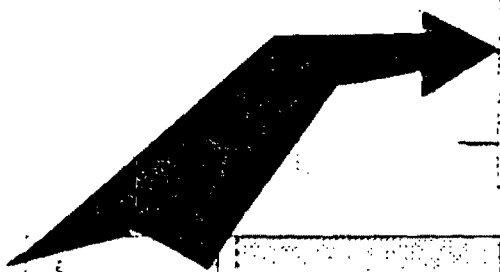

FRDS - II

SECTION B2



100

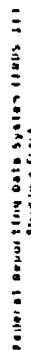

FORMS DESCRIPTION

FORM C

Section C1 - GEOGRAPHIC AREAS SERVED (See Figure 6)

This section is used to enter data that identifies geographic areas or jurisdictions served by a public water system. All data elements within a single geographic areas served record should be valued with related data, which describe a single geographic area. For example, if city "X" is in county "A", they both should be included in the same geographic areas served record. Conversely, if city "X" is outside of county "A", they each should be included in a separate record. The FRDS-II Data Base has one geographic areas served record for each geographic area served that has been reported to EPA. The following data may be entered via this section:

DATA ELEMENT #	FORM REFERENCE NAME
C501	- GA ID
C503	- ADMIN REGION
C505	- ADMIN DISTRICT
C507	- FEDERAL CONGRESS DISTRICT
C509	- F/S COUNTY
C513	- CITY
C515	- INDIAN RESERVATION

Section C2 - SERVICE AREAS (See Figure 7)

This section is used to enter data that characterizes the type of area served by the public water system. The FRDS-II Data Base has one record for each type of area served that is reported to EPA and must have one service area designated as primary for non-transient, non-community and non-community public water systems. The following data may be entered via this section:

DATA ELEMENT #	FORM REFERENCE NAME
C601	- SERV ID
C603	- TYPE/CAT
C605	- PRIMARY SERVICE FLAG

FORMS DESCRIPTION

Section C3 - ON-SITE VISITS (See Figure 8)

This section is used to enter data that is related to on-site visits made to a public water system. The FRDS-II Data Base has one on-site visit record for each on-site visit (such as a sanitary survey), that has been reported to EPA. The following data may be entered via this section:

DATA ELEMENT #	FORM REFERENCE NAME
C701	- VISIT ID
C703	- VISIT DATE (MO, DAY, & YR)
C705	- VISIT REASON

FKDS - 11

10/01/89

Release Number: 1.0

Page: 13

Public Water System
Data Capture Form C

11. Activity Code
 12. Activity Code
 13. Activity Code
 14. Activity Code
 15. Activity Code
 16. Activity Code
 17. Activity Code
 18. Activity Code
 19. Activity Code
 20. Activity Code
 21. Activity Code
 22. Activity Code
 23. Activity Code
 24. Activity Code
 25. Activity Code
 26. Activity Code
 27. Activity Code
 28. Activity Code
 29. Activity Code
 30. Activity Code
 31. Activity Code
 32. Activity Code
 33. Activity Code
 34. Activity Code
 35. Activity Code
 36. Activity Code
 37. Activity Code
 38. Activity Code
 39. Activity Code
 40. Activity Code
 41. Activity Code
 42. Activity Code
 43. Activity Code
 44. Activity Code
 45. Activity Code
 46. Activity Code
 47. Activity Code
 48. Activity Code
 49. Activity Code
 50. Activity Code
 51. Activity Code
 52. Activity Code
 53. Activity Code
 54. Activity Code
 55. Activity Code
 56. Activity Code
 57. Activity Code
 58. Activity Code
 59. Activity Code
 60. Activity Code
 61. Activity Code
 62. Activity Code
 63. Activity Code
 64. Activity Code
 65. Activity Code
 66. Activity Code
 67. Activity Code
 68. Activity Code
 69. Activity Code
 70. Activity Code
 71. Activity Code
 72. Activity Code
 73. Activity Code
 74. Activity Code
 75. Activity Code
 76. Activity Code
 77. Activity Code
 78. Activity Code
 79. Activity Code
 80. Activity Code
 81. Activity Code
 82. Activity Code
 83. Activity Code
 84. Activity Code
 85. Activity Code
 86. Activity Code
 87. Activity Code
 88. Activity Code
 89. Activity Code
 90. Activity Code
 91. Activity Code
 92. Activity Code
 93. Activity Code
 94. Activity Code
 95. Activity Code
 96. Activity Code
 97. Activity Code
 98. Activity Code
 99. Activity Code
 100. Activity Code

[illegible]

SECTION C1 GEOGRAPHIC AREAS SERVED

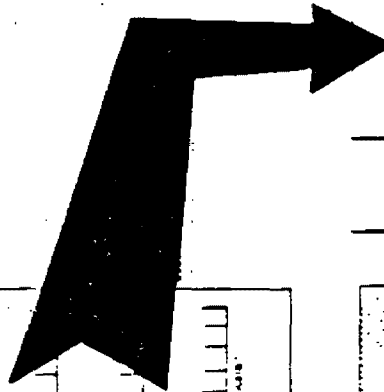
[illegible]

• 18
Kirkman
B-18
B-18

1971
1970
1969

[illegible][illegible]

PKDS - II DATA CAPTURE FORM TO DATA BASE RECORD RELATIONSHIP



Public Water System
Data Capture Form C

☐ **SECTION C1**
 NAME: _____ ADDRESS: _____ CITY: _____ STATE: _____ ZIP: _____
 PHONE: _____ FAX: _____
 DATE: _____ TIME: _____
 ACTION: ☐ **NEW** ☐ **UPDATE** ☐ **DELETE**

GEOGRAPHIC AREAS SERVED

AREA	NAME	ADDRESS	CITY	STATE	ZIP	PHONE	FAX
1							
2							
3							
4							
5							
6							
7							
8							
9							
10							
11							
12							
13							
14							
15							
16							
17							
18							
19							
20							

SERVICE AREAS

AREA	NAME	ADDRESS	CITY	STATE	ZIP	PHONE	FAX
1							
2							
3							
4							
5							
6							
7							
8							
9							
10							
11							
12							
13							
14							
15							
16							
17							
18							
19							
20							

ON-SITE VISITS

AREA	DATE	TIME	BY	REMARKS
1				
2				
3				
4				
5				
6				
7				
8				
9				
10				
11				
12				
13				
14				
15				
16				
17				
18				
19				
20				

SECTION C2 SERVICE AREAS

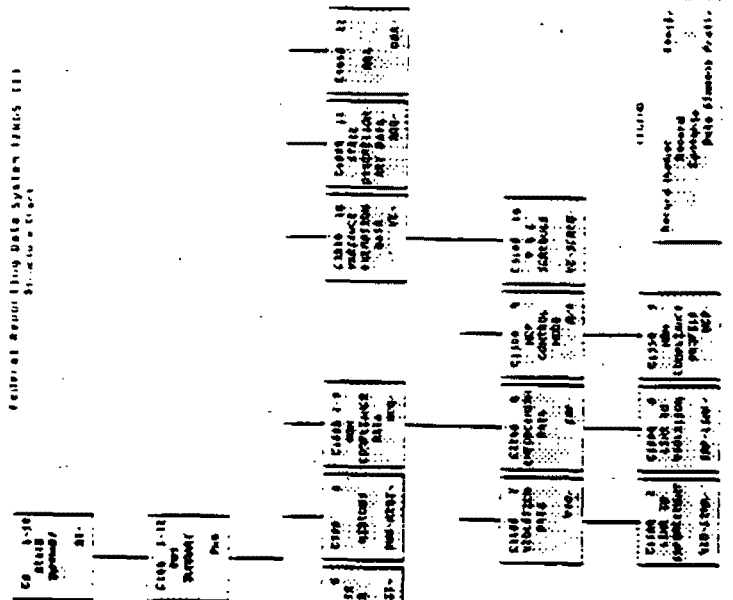

FKDS - II

Journal of Management Data Systems 10(4) 111-131

[illegible][illegible]

FORMS DESCRIPTION

o FORM D

Section D1 - VIOLATION DATA (See Figure 9)

This section is used to enter data that characterizes a violation of a primary drinking water regulation issued to a public water system by a State or Federal agency. The FRDS-II Data Base has one violation record for each violation that has been reported to EPA. The following data may be entered via this section:

DATA ELEMENT #	FORM REFERENCE NAME
C1101	- VIOLATION ID (FY & ID NUMBER)
C1103	- CONTAMINANT
C1105	- VIOLATION TYPE
C1107	- COMPLIANCE PERIOD BEGIN (MO, DAY, & YR)
C1109	- COMPLIANCE PERIOD END (MO, DAY, & YR)
C1111	- COMPLIANCE PERIOD DURATION
C1115	- AWARENESS DATE (MO, DAY, & YR)
C1121	- ANALYSIS METHOD
C1123	- ANALYSIS RESULT
C1125	- MCL VIOLATED
C1127	- NUM SAMPLES REQUIRED
C1129	- NUM SAMPLES TAKEN
C1131	- MAJOR VIOLATION
C1143	- SE ID

FRDS - II

VIOLATION DATA

10
11
12
13
14
15
16
17
18
19
20
21
22
23
24
25
26
27
28
29
30
31
32
33
34
35
36
37
38
39
40
41
42
43
44
45
46
47
48
49
50
51
52
53
54
55
56
57
58
59
60
61
62
63
64
65
66
67
68
69
70
71
72
73
74
75
76
77
78
79
80
81
82
83
84
85
86
87
88
89
90
91
92
93
94
95
96
97
98
99
100
101
102
103
104
105
106
107
108
109
110
111
112
113
114
115
116
117
118
119
120
121
122
123
124
125
126
127
128
129
130
131
132
133
134
135
136
137
138
139
140
141
142
143
144
145
146
147
148
149
150
151
152
153
154
155
156
157
158
159
160
161
162
163
164
165
166
167
168
169
170
171
172
173
174
175
176
177
178
179
180
181
182
183
184
185
186
187
188
189
190
191
192
193
194
195
196
197
198
199
200
201
202
203
204
205
206
207
208
209
210
211
212
213
214
215
216
217
218
219
220
221
222
223
224
225
226
227
228
229
230
231
232
233
234
235
236
237
238
239
240
241
242
243
244
245
246
247
248
249
250
251
252
253
254
255
256
257
258
259
260
261
262
263
264
265
266
267
268
269
270
271
272
273
274
275
276
277
278
279
280
281
282
283
284
285
286
287
288
289
290
291
292
293
294
295
296
297
298
299
300
301
302
303
304
305
306
307
308
309
310
311
312
313
314
315
316
317
318
319
320
321
322
323
324
325
326
327
328
329
330
331
332
333
334
335
336
337
338
339
340
341
342
343
344
345
346
347
348
349
350
351
352
353
354
355
356
357
358
359
360
361
362
363
364
365
366
367
368
369
370
371
372
373
374
375
376
377
378
379
380
381
382
383
384
385
386
387
388
389
390
391
392
393
394
395
396
397
398
399
400
401
402
403
404
405
406
407
408
409
410
411
412
413
414
415
416
417
418
419
420
421
422
423
424
425
426
427
428
429
430
431
432
433
434
435
436
437
438
439
440
441
442
443
444
445
446
447
448
449
450
451
452
453
454
455
456
457
458
459
460
461
462
463
464
465
466
467
468
469
470
471
472
473
474
475
476
477
478
479
480
481
482
483
484
485
486
487
488
489
490
491
492
493
494
495
496
497
498
499
500
501
502
503
504
505
506
507
508
509
510
511
512
513
514
515
516
517
518
519
520
521
522
523
524
525
526
527
528
529
530
531
532
533
534
535
536
537
538
539
540
541
542
543
544
545
546
547
548
549
550
551
552
553
554
555
556
557
558
559
560
561
562
563
564
565
566
567
568
569
570
571
572
573
574
575
576
577
578
579
580
581
582
583
584
585
586
587
588
589
590
591
592
593
594
595
596
597
598
599
600
601
602
603
604
605
606
607
608
609
610
611
612
613
614
615
616
617
618
619
620
621
622
623
624
625
626
627
628
629
630
631
632
633
634
635
636
637
638
639
640
641
642
643
644
645
646
647
648
649
650
651
652
653
654
655
656
657
658
659
660
661
662
663
664
665
666
667
668
669
670
671
672
673
674
675
676
677
678
679
680
681
682
683
684
685
686
687
688
689
690
691
692
693
694
695
696
697
698
699
700
701
702
703
704
705
706
707
708
709
710
711
712
713
714
715
716
717
718
719
720
721
722
723
724
725
726
727
728
729
730
731
732
733
734
735
736
737
738
739
740
741
742
743
744
745
746
747
748
749
750
751
752
753
754
755
756
757
758
759
760
761
762
763
764
765
766
767
768
769
770
771
772
773
774
775
776
777
778
779
780
781
782
783
784
785
786
787
788
789
790
791
792
793
794
795
796
797
798
799
800
801
802
803
804
805
806
807
808
809
810
811
812
813
814
815
816
817
818
819
820
821
822
823
824
825
826
827
828
829
830
831
832
833
834
835
836
837
838
839
840
841
842
843
844
845
846

4-27-67
10-1-68

VELOCITY ID Q NUMBER FY G-1401	CLEAN AIR INLET TYPE NO DAY YR G-1402	VELOCITY TYPE NO DAY YR G-1404	CLEAN AIR INLET INLET NO DAY YR G-1405	COMPARISON INLET INLET DURATION G-1406	OR	COMPARISON INLET INLET DURATION G-1407							
SL ID G-1408	SEWAGE INLET (DAILY) NO DAY YR G-1409	RAINFALL INLET (DAILY) NO DAY YR G-1410	RAINFALL INLET NO DAY YR G-1411	RAINFALL INLET NO DAY YR G-1412	OR	RAINFALL INLET NO DAY YR G-1413							
MONITORING AND REPORTING VOLUNTARILY													
<table border="1"> <tr> <td> MAX VIB METHOD G-1414 </td> <td> MAX VIB METHOD G-1415 </td> <td> MAX VIB METHOD G-1416 </td> <td> MAX VIB METHOD G-1417 </td> <td> MAX VIB METHOD G-1418 </td> <td> MAX VIB METHOD G-1419 </td> <td> MAX VIB METHOD G-1420 </td> </tr> </table>							MAX VIB METHOD G-1414	MAX VIB METHOD G-1415	MAX VIB METHOD G-1416	MAX VIB METHOD G-1417	MAX VIB METHOD G-1418	MAX VIB METHOD G-1419	MAX VIB METHOD G-1420
MAX VIB METHOD G-1414	MAX VIB METHOD G-1415	MAX VIB METHOD G-1416	MAX VIB METHOD G-1417	MAX VIB METHOD G-1418	MAX VIB METHOD G-1419	MAX VIB METHOD G-1420							

FORMS DESCRIPTION

o FORM E

Section E1 - ENFORCEMENT DATA (See Figure 10)

This section is used to enter data that characterizes an enforcement action taken against a public water system by a State or Federal agency. The FRDS-II Data Base has one enforcement record for each enforcement action that has been reported to EPA. The following data may be entered via this section:

DATA ELEMENT #	FORM REFERENCE NAME
C1201	- ENFORCEMENT ID (FY & ID NUMBER)
C1203	- ENFORCEMENT DATE (MO, DAY, & YR)
C1205	- FOLLOW-UP ACTION
X5000	- ASSOCIATED VIOLATION RANGE
	-- BEGIN (MO DAY YR)
	-- END (MO DAY YR)
Y5000	- ASSOCIATED VIOLATION IDS
	-- VIOLATION ID 1 (FY & ID NUMBER)
	-- VIOLATION ID 2 (FY & ID NUMBER)
	-- VIOLATION ID 3 (FY & ID NUMBER)
	-- VIOLATION ID 4 (FY & ID NUMBER)
Z5000	- ASSOCIATED VIOLATION CONTAMINANT GROUPS
	-- CONTAMINANT GROUP # 1
	--- TYPE
	--- CONTAMINANT
	--- COMPLIANCE PERIOD BEGIN DATE (MO DAY YR)
	-- CONTAMINANT GROUP # 2
	--- TYPE
	--- CONTAMINANT
	--- COMPLIANCE PERIOD BEGIN DATE (MO DAY YR)
	-- CONTAMINANT GROUP # 3
	--- TYPE
	--- CONTAMINANT
	--- COMPLIANCE PERIOD BEGIN DATE (MO DAY YR)

DATA CAPTURE FORM TO DATA BASE RECORD RELATIONSHIP

0.0 0.2 0.4 0.6 0.8 1.0

SECTION E1 ENFORCEMENT DATA

117 50041 20146 0170 0011 10000 10000 10000

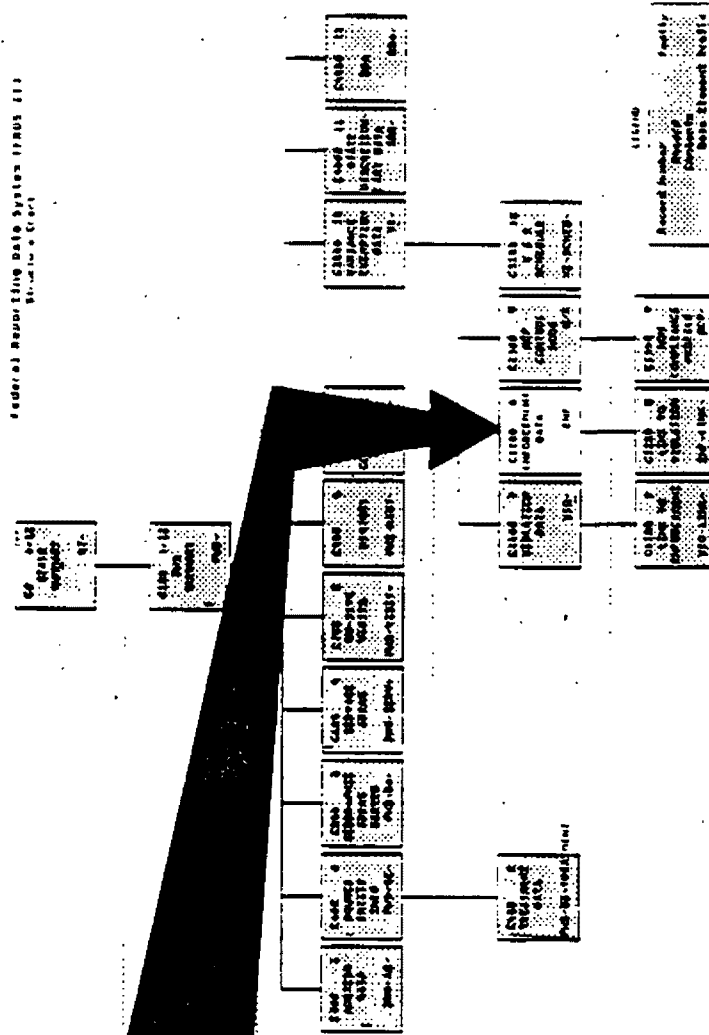
[illegible]

FORMS DESCRIPTION

o FORM F

Section F1 - VARIANCES, EXEMPTIONS & OTHER RELATED DATA (See Figure 11)

This section is used to enter data that characterizes a variance or exemption that is pending for, or has been granted to, a public water system. The FRDS-II Data Base has one variance or exemption record for each variance or exemption that has been reported to EPA. The following data may be entered via this section:

DATA ELEMENT #	FORM REFERENCE NAME
C3001	- VE ID (FY & ID NUMBER)
C3003	- CONTAMINANT
C3005	- RECORD TYPE
C3007	- EFFECTIVE DATE (MO, DAY, & YR)
C3009	- EXPIRATION DATE (MO, DAY, & YR)
C3011	- STATUS CODE
C3013	- MODIFIED MCL
C3015	- TREATMENT PROCESS
C3017	- ALTERNATE PROCESS
C3019	- REASON

Section F2 - VE SCHEDULE (See Figure 12)

This section is used to enter data that characterizes a schedule of events and/or actions that are related to a variance or exemption that is pending for, or has been granted to, a public water system. The FRDS-II Data Base has one schedule record for each event or action which is related to a variance or exemption that has been reported to EPA. The following data may be entered via this form:

DATA ELEMENT #	FORM REFERENCE NAME
C3001	- VE ID (FY & ID NUMBER)
C3101	- SCHEDULE ID
C3103	- ACTION
C3105	- SCHEDULED DATE (MO, DAY, & YR)
C3107	- ACCOMPLISHED DATE (MO, DAY, & YR)

FRDS - II



ALL INFORMATION CONTAINED
HEREIN IS UNCLASSIFIED
DATE 08-19-2007 BY 60322 UCBAW

[illegible][illegible]

**SECTION F2
VE SCHEDULE**

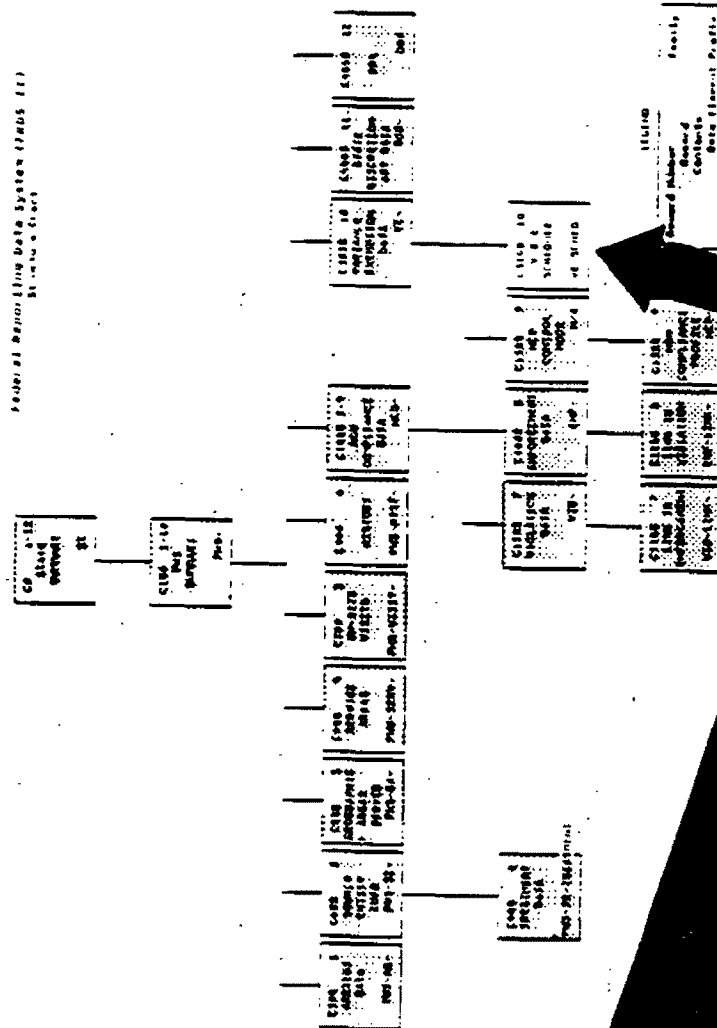

FORMS DESCRIPTION

FORM G

Section G1 - STATE DISCRETIONARY DATA (See Figure 13)

This section is used to enter data that characterizes a specific set of values defined at the discretion of the State. The FRDS-II Data Base has one discretionary record for each single set of State specific data values that has been reported to EPA for a public water system. The following data may be entered via this section:

DATA ELEMENT #	FORM REFERENCE NAME
C4001	- SDD ID
C4003	- STATE DISCRETIONARY DATA NAME
C4005	- STATE DISCRETIONARY VALUE
C4007	- QUANTITY
C4009	- DATE (MO, DAY, & YR)

FKS - 11

Public Water System
Data Capture Form G

March 27

ИСТОЧНИК

EMA

SECTION GI
STATE DISCRETIONARY DATA

1. 1950-1951

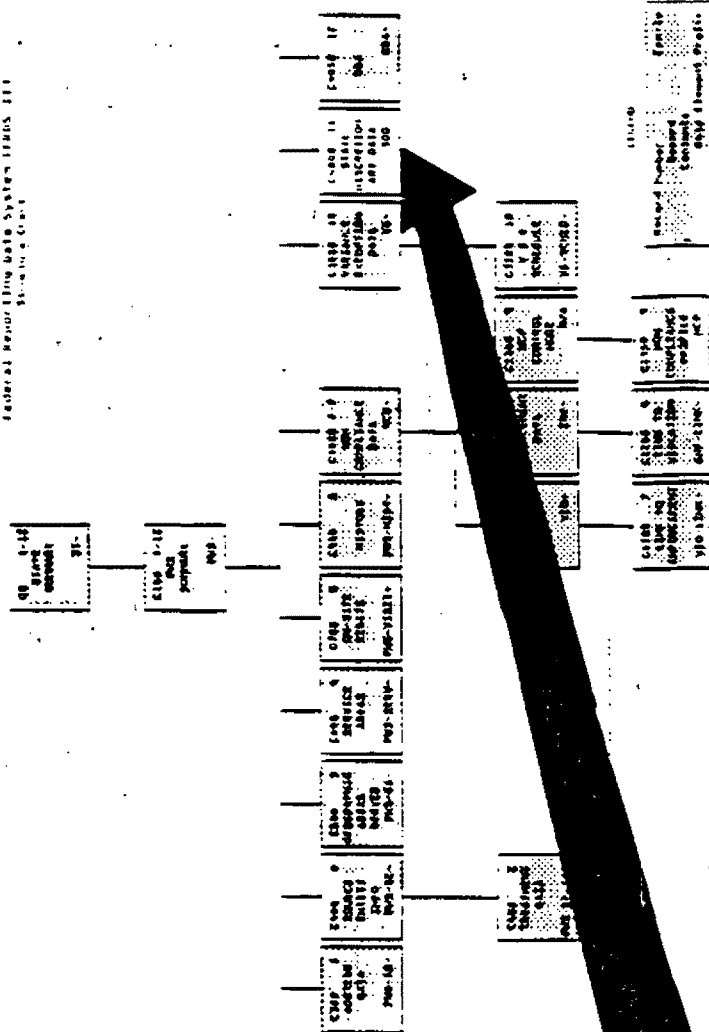
[illegible]

FRDS-II DATA ENTRY INSTRUCTIONS

CHAPTER II

DATA TRANSFER FILE

DATA TRANSFER FILE

The Data Transfer File Format, which may be used at the onset of FRDS-II availability, is the only format (except as noted below) by which, the Revised Reporting Requirement (RRR) data can be entered into the FRDS-II Data Base. Consequently, this is the EPA preferred format for use by States to input their FRDS-II data. However, States that will not initially have the capability to use the Data Transfer File Format, will be able to submit update transactions in the FRDS 1.5 format that they currently use. There will be a phase-in period during which inventory data in the FRDS 1.5 format will be accepted into the FRDS-II System. Refer to the latest approved FRDS-II implementation schedule for phase-in deadlines.

EXCEPT FOR THE AWARENESS DATE IN THE REVISED CARD 45, IT SHOULD BE EMPHASIZED THAT THE FRDS 1.5 TRANSACTION FORMAT DOES NOT ALLOW FOR THE INPUT OF REVISED REPORTING REQUIREMENT DATA.

After the phase-in period, public water systems will be counted for grant allocation purposes ONLY if all of the data items required for that purpose are supplied. After this time, the capability for accepting transactions in the FRDS 1.5 format will not be available. Action data (i.e., violations, enforcements, variances and exemptions) is an exception to the phase-in period, and will have to be reported using the Data Transfer File Format at an earlier time in the implementation schedule. Again, see the latest approved FRDS-II implementation schedule for the phase-in deadline for action data.

DATA TRANSFER FILE

In those cases where multiple records (i.e., Form Sections) may be input to FRDS-II, secondary data address qualifiers are required to be included with each record. These are needed to uniquely identify the specific record being processed. These secondary data address qualifiers are shown in the "Qualifier 2" and the "Qualifier 3" columns in the list below.

SECTION ID	SECTION NAME	DATA ADDRESS QUALIFIERS		
		PRIMARY QUALIFIER 1	SECONDARY QUALIFIER 2	QUALIFIER 3
A1	SYSTEM ADDRESS	*PWS-ID	N/A	N/A
A2	PWS CHARACTERISTICS	*PWS-ID	N/A	N/A
A3	OTHER ADDRESSES	*PWS-ID	*ADDRESS-ID	N/A
B1	SOURCE / ENTITY DATA	*PWS-ID	* SE-ID	N/A
B2	TREATMENT DATA	*PWS-ID	* SE-ID	*TREATMENT-ID
1	GEOGRAPHIC AREAS SERVED	*PWS-ID	* GA-ID	N/A
2	SERVICE AREAS	*PWS-ID	* SERV-ID	N/A
C3	ON-SITE VISITS	*PWS-ID	* VISIT-ID	N/A
D1	VIOLATION DATA	*PWS-ID	*VIOLATION-ID	N/A
E1	ENFORCEMENT DATA	*PWS-ID	* ENF-ID	N/A
F1	VARIANCES & EXEMPTIONS	*PWS-ID	* VE-ID	N/A
F2	V & E SCHEDULE	*PWS-ID	* VE-ID	*SCHED-ID
G1	STATE DISCRETIONARY DATA	*PWS-ID	* SDD-ID	N/A

****NOTE:** The data element numbers for the qualifiers listed above, are not valid data element numbers for use in the data element number area (positions 27-31) in the DTF record. Specifically, these data element numbers are C101, C301, C401, C481, C501, C601, C701, C1101, C1201, C3001, C3101, and C4001.

DATA TRANSFER FILE

Secondary data address qualifiers are always required to permit FRDS-II to uniquely identify a specific record in those cases where multiple records for a PWS can exist (e.g., multiple sources). In such cases, the secondary data address qualifiers serve as essential "group codes", permitting the automatic grouping of all related Data Transfer File records during processing. This needs to be done to ensure that the data from multiple Form-IDs for any PWS would not be inadvertently mixed.

The group code can also be used to communicate to the FRDS-II Computer System that the user wants FRDS to automatically generate the associated ID and post it to the data base.

In these cases, the group code is prefixed with a "G" and it is referred to as a "Group Generation Code" (GGC). By design, GGCs are not retained in the data base but serve in a temporary capacity only: grouping related data together and triggering the automatic generation of sequential ID numbers.

In those cases where the user decides to assign his or her own ID codes, and the secondary data address (i.e., ID) already exists in the data base, the record being inserted will be rejected as having a duplicate ID. However, since the GGC numbers are not stored in the data base, such an error under the GGC concept is not possible. The drawback to these system generated IDs is that the user does not have immediate access to them for subsequent updating purposes. However, after each update in the

DATA TRANSFER FILE

FRDS-II System, a report showing all IDs generated during that update, will be available to the user.

With the exception of the X5000, Y5000, and Z5000 enforcement transactions, one Data Transfer record is required for each data value (i.e., data element) to be entered into the FRDS-II System. For example, when adding a System Address up to seven Data Transfer records may be necessary, since seven data elements are possible. Each Data Transfer record would contain the appropriate data value along with the Section ID, Data Address Qualifier(s), (see page 27 for the list of valid qualifiers) Action Code, Data Element Number and Batch Date.

Each Data Transfer File record is 80 characters in length and has the following format:

Definition	Positions
Form ID	1 - 2
Qualifier 1	3 - 11
Qualifier 2	12 - 18
Qualifier 3	19 - 25
Action Code	26
Data Element Number	27 - 31
Data Value	32 - 71
Reserved for FRDS-II use	72 - 74
Batch Date	75 - 80

FORM	DATA ADDRESS QUALIFIERS			ACT.	DATA		FRDS	BATCH
ID	QUAL 1	QUAL 2	QUAL 3	CODE	ELEM.	DATA VALUE	USE	DATE
1-2	3-11	12-18	19-25	26	27-31	32-71	72-74	75-80

Effective Date: 10/01/89

Release Number: 1.0

Page: 29

DATA TRANSFER FILE

The X5000, Y5000, and Z5000 transactions are the only cases where the Data Transfer File Data Value (pos 32 - 71) will contain multiple data elements. These data elements are BEGIN and END dates in the ASSOCIATED VIOLATION RANGE (X5000), VIOLATION IDS 1 through 4 in the ASSOCIATED VIOLATION IDS (Y5000), and (violation) TYPE, CONTAMINANT (type), and (violation) BEGIN DATE in the ASSOCIATED VIOLATION CONTAMINANT GROUPS (Z5000). When used, these data elements must be contiguous in the Data Transfer File Data Value (i.e., without any intervening spaces).

In addition, there is a maximum number of occurrences for these data elements that can occur in the Data Value Field. The maximum number is shown as follows:

- ASSOCIATED VIOLATION RANGE (X5000) - A maximum of one begin date and one END date may be used in the Data Value Field.
- ASSOCIATED VIOLATION IDS (Y5000) - A maximum of four VIOLATION IDS may be used in the Data Value Field.
- ASSOCIATED VIOLATION CONTAMINANT GROUPS (Z5000) - A maximum of three groups, each consisting of TYPE, CONTAMINANT, and BEGIN DATE may be used in the Data Value Field.

See Appendix A for examples of how the Data Transfer File Format records are related to encoded Data Capture Forms.

FRDS-II DATA ENTRY INSTRUCTIONS

CHAPTER III

POSITION CONCEPT

POSITION CONCEPT

Throughout this document, you will see the term "POSITION" (e.g., "POSITIONS 1 - 3 must contain", etc.). In order to avoid any possible confusion or misinterpretation, the following examples are given:

- o "POSITION 1", (or "FIRST POSITION") means LEFT-MOST
- o "POSITIONS 1 - 3" means position 1 is LEFT-MOST
and position 3 is the RIGHT-MOST.

FRDS-II DATA ENTRY INSTRUCTIONS

CHAPTER IV

DATA BASE REGISTRATION REQUIREMENT

DATA BASE REGISTRATION REQUIREMENT

The term "Registration Requirement" is used to characterize and delineate which FRDS-II data elements are necessary in order for a public water system, or some other event related to that public water system (e.g., Violation, Exemption, etc.), to get "recorded" into the FRDS-II Data Base. The "Reason Codes" and definitions on the next page are offered as an explanation of the rationale used in identifying why a specific data element is needed by FRDS-II for the public water system to become registered.

Definitions

Page : 35

FRDS-II DATA ENTRY INSTRUCTIONS

CHAPTER V

DATA ELEMENT REMOVAL VS. DATA BASE RECORD DELETION

DATA ELEMENT REMOVAL VS. DATA BASE RECORD DELETION

The difference between data element removal and Data Base Record (DBR) deletion is an important concept in the FRDS-II System. When a DBR is deleted, all values contained in that DBR and the DBR itself are removed. When a data element is removed, only its value is blanked out (initialized to nulls) in the DBR; other data elements in that specified DBR remain unchanged.

DBR deletion is accomplished only through the use of the ACTION CODE "D". Data element value removal, however, is accomplished by entering an ACTION CODE of "M" (i.e., Modify) and a dollar sign (\$) in the first (left-most) position of the data element value to be removed.

FRDS-II DATA ENTRY INSTRUCTIONS

CHAPTER VI

RECORD IDENTIFICATION

RECORD IDENTIFICATION

Except for sections A1 and A2 (which use the PWS ID), all section types on the FRDS-II Data Capture Forms have a unique record ID (i.e., secondary data address qualifiers). These IDs are used in FRDS-II to specifically identify Data Base Records (DBRs) in the data base so that the various transaction types (insert, delete, and modify) can be performed. For most record types, the user has the option of assigning his or her own record ID, or allowing the FRDS-II System to generate a unique record ID. Exceptions to this are the SYSTEM ADDRESS and PUBLIC WATER SYSTEM CHARACTERISTICS (Sections A1 and A2, respectively), which use the PWS ID for a record ID, and must always be assigned by the user.

It should be noted here, that in some cases there is a difference in the length of the record ID, between what is defined in the Federal Reporting Data System Data Element Dictionary and what is shown on the FRDS-II Data Capture Forms. This is to allow room for the "Group Generation Code" (GGC), which signals the FRDS-II Computer System to Generate the record ID. The actual length of the record IDs in the FRDS-II Data Base are as defined in the FRDS-II Data Element Dictionary. It should also be noted that the FRDS-II System makes a special allowance for the use of the GGC in IDs that are defined as numeric. No other alphabetic characters are accepted in these IDs. The FRDS-II System will not allow a mixture of user assigned IDs and GGCs in an update for a given record type, within a given PWS. For example, if two source records for the same PWS are to be posted to the data base in the same update, BOTH SE IDs must be user assigned, or BOTH must use the GGC. A further discussion of "Group Generation Codes" may be found in Chapter II - "Data Transfer File".

The following is a list of each record ID and the rules for their assignment or generation.

ADDRESS ID - (OTHER ADDRESS(ES))

If the user wants to assign the ADDRESS ID...

- o position 1 must be greater than or equal to 1 and less than or equal to 9.
- o position 2 of the ID must be blank.

If the user wants the FRDS-II computer system to generate an ADDRESS ID...

- o position 1 of the ID must contain the letter "G".
- o position 2 must be greater than or equal to 1 and less than or equal to 9.

NOTE: When ADDRESS ID is assigned by the user, a maximum of 9 address records may be entered in any single update for a given PWS. When ADDRESS ID is computer generated, a maximum of 9 address records may be entered in any single update for a given PWS.

RECORD IDENTIFICATION

SE ID - (SOURCE / ENTITY DATA)

If the user wants to assign the SE ID...

- o positions 1 - 3 must be greater than or equal to 001 and less than or equal to 949.

If the user wants the FRDS-II computer system to generate the SE ID...

- o position 1 of the ID must contain the letter "G"
- o positions 2 - 3 must be greater than or equal to 01 and less than or equal to 99.

NOTE: When SE ID is assigned by the user, a maximum of 200 source entity records may be entered in any single update for a given PWS. When SE ID is computer generated, a maximum of 99 source entity records may be entered in any single update for a given PWS. SE IDs 950 through 999 are reserved for EPA ODW use.

TREATMENT ID - (TREATMENT DATA)

If the user wants to assign the TREATMENT ID...

- o positions 1 - 2 must be greater than or equal to 01 and less than or equal to 99.
- o position 3 must contain a blank.

If the user wants to have the FRDS-II computer system generate the TREATMENT ID...

- o position 1 must contain the letter "G".
- o positions 2 - 3 must be greater than or equal to 01 and less than or equal to 99.

NOTE: When TREATMENT ID is assigned by the user, a maximum of 40 treatment records may be entered in any single update for a given SOURCE. When TREATMENT ID is computer generated, a maximum of 40 treatment records may be entered in any single update for a given SOURCE.

RECORD IDENTIFICATION

GA ID - (GEOGRAPHIC AREAS SERVED)

If the user wants to assign the GA ID...

- o position 1 - 2 must be greater than or equal to 01 and less than or equal to 39.

If the user wants to have the FRDS-II computer system generate the GA ID....

- o position 1 must contain the letter "G".
- o position 2 must be greater than or equal to 1 and less than or equal to 9.

NOTE: When GA ID is assigned by the user, a maximum of 40 geographic areas served records may be entered in any single update for a given PWS. When GA ID is computer generated, a maximum of 9 geographic areas served records may be entered in any single update for a given PWS. GA IDs 90 through 99 are reserved for EPA ODW use.

SERV ID - (SERVICE AREAS)

If the user wants to assign the SERV ID...

- o position 1 - 2 must be greater than or equal to 01 and less than or equal to 99.

If the user wants to have the FRDS-II computer system generate the SERV ID...

- o position 1 must contain the letter "G".
- o position 2 must be greater than or equal to 1 and less than or equal to 9.

NOTE: When SERV ID is assigned by the user, a maximum of 40 service area records may be entered in any single update for a given PWS. When SERV ID is computer generated, a maximum of 9 service area records may be entered in any single update for a given PWS.

RECORD IDENTIFICATION

VISIT ID - (ON-SITE VISITS)

If the user wants to assign the VISIT ID...

- o position 1 - 2 must be greater than or equal to 01 and less than or equal to 99.

If the user wants to have the FRDS-II computer system generate the VISIT ID...

- o position 1 must contain the letter "G".
- o position 2 must be greater than or equal to 1 and less than or equal to 9.

NOTE: VISIT ID will ALWAYS be generated by the FRDS-II Computer System. A maximum of 9 on-site visit records may be entered in any single update for a given PWS.

VIOLATION ID - (VIOLATION DATA)

If the user wants to assign the VIOLATION ID...

- o positions 1 - 2 must be greater than or equal to 78 and less than or equal to the current federal fiscal year.
- o positions 3 - 7 must be greater than or equal to 00001 and less than or equal to 99999.

If the user wants the FRDS-II Computer System to generate the VIOLATION ID...

- o positions 1 - 2 must be greater than or equal to 78 and less than or equal to the current federal fiscal year.
- o position 3 must contain the letter "G".
- o positions 4 - 7 must be greater than or equal to 0001 and less than or equal to 9999.

NOTE: When the VIOLATION ID is assigned by the user, a maximum of 300 violation records may be entered in any single update for a given PWS. When the VIOLATION ID is computer generated, a maximum of 300 violation records may be entered in any single update for a given PWS and position 3 of the generated ID will contain a "v".

RECORD IDENTIFICATION

ENFORCEMENT ID - (ENFORCEMENT DATA)

If the user wants to assign the ENFORCEMENT ID...

- o positions 1 - 2 must be greater than or equal to 78 and less than or equal to the current federal fiscal year.
- o positions 3 - 7 must be greater than or equal to 00001 and less than or equal to 99999.

If the user wants the FRDS-II Computer System to generate the ENFORCEMENT ID...

- o positions 1 - 2 must be greater than or equal to 78 and less than or equal to the current federal fiscal year.
- o position 3 must contain the letter "G".
- o positions 4 - 7 must be greater than or equal to 0001 and less than or equal to 9999.

NOTE: When ENFORCEMENT ID is assigned by the user, a maximum of 300 enforcement records may be entered in any single update for a given PWS. When ENFORCEMENT ID is computer generated, a maximum of 300 enforcement records may be entered in any single update for a given PWS and position 3 of the generated ID will contain an "E".

VE ID - (VARIANCES, EXEMPTIONS & OTHER RELATED DATA)

If the user wants to assign the VE ID...

- o positions 1 - 2 must be greater than or equal to 78 and less than or equal to the current federal fiscal year.
- o positions 3 - 7 must be greater than or equal to 00001 and less than or equal to 99999.

If the user wants the FRDS-II Computer System to generate the VE ID...

- o positions 1 - 2 must be greater than or equal to 78 and less than or equal to the current federal fiscal year.
- o position 3 must contain the letter "G".
- o positions 4 - 7 must be greater than or equal to 0001 and less than or equal to 9999.

NOTE: When VE ID is assigned by the user, a maximum of 50 variances, exemptions & other related data records may be entered in any single update for a given PWS. When VE ID is computer generated, a maximum of 50 variances, exemptions & other related data records may be entered in any single update for a given PWS and position 3 of the generated ID will contain an "X".

RECORD IDENTIFICATION

SCHEDULE ID - (VE SCHEDULE)

If the user wants to assign the SCHEDULE ID...

- o positions 1 - 2 must be greater than or equal to 01 and less than or equal to 99.

If the user wants the FRDS-II Computer System to generate the SCHEDULE ID...

- o position 1 must contains the letter "G".
- o position 2 must be greater than or equal to 1 and less than or equal to 9.

NOTE: When SCHEDULE ID is assigned by the user, a maximum of 50 schedule records may be entered in any single update for a given variance and exemption record. When SCHEDULE ID is computer generated, a maximum of 9 schedule records may be entered in any single update for a given variance and exemption record.

SDD ID - (STATE DISCRETIONARY DATA)

If the user wants to assign the SDD ID...

- o positions 1 - 3 must be greater than or equal to 001 and less than or equal to 999.

If the user wants the FRDS-II computer system to generate the SDD ID...

- o position 1 of the ID must contain the letter "G"
- o positions 2 - 3 must be greater than or equal to 01 and less than or equal to 99.

NOTE: When SDD ID is assigned by the user, a maximum of 100 State discretionary records may be entered in any single update for a given PWS. When SDD ID is computer generated, a maximum of 99 State discretionary records may be entered in any single update for a given PWS.

FRDS-II DATA ENTRY INSTRUCTIONS

CHAPTER VII

GENERAL CODING INSTRUCTIONS

GENERAL CODING INSTRUCTIONS

Throughout the FRDS-II Data capture forms, there are many areas where dates may be entered. Additionally, there are three different formats in which these dates are represented. These formats include:

YR MO	(Year and Month)
MO DAY	(Month and Day)
MO DAY YR	(Month, Day and Year)

When dates are entered, the applicable month, day or year should be left-justified and zero-filled. The examples shown below demonstrate the correct and the incorrect methods of entering the date of March 7, 1988.

	CORRECT	INCORRECT
	----	----
YR MO	8803	883
MO DAY	0307	307
MO DAY YR	030788	3 788
	-----	-----

There are many sections in the FRDS-II Data Capture Forms that allow for multiple iterations of the same data types to be entered in a single section. For example, Section C3 (ON-SITE VISITS) contains six iterations of the same data types. This allows the user to enter up to six on-site visits on that single form. If the user wants to enter more than six on-site visits for any single update, he or she would have to use a second or third form, as needs dictate.

Similarly, there are forms that have two or more iterations of the same section. For example, Section D1 is repeated twice on Form D. This enables the user to enter two violations for a single update on one form. If the user wants to enter more than two violations for any single update, he or she must use additional forms as appropriate.

There is a third case where two sections are repeated twice on the same form (Section B1 - SOURCE/ENTITY DATA and SECTION B2 - TREATMENT DATA). Under normal circumstances, the user would fill in SOURCE / ENTITY DATA and possibly two or three iterations of TREATMENT DATA. However, it is possible for the user to enter a single source entity and up to ten iterations of treatment data on a single form. This would be accomplished by filling in the SOURCE/ENTITY DATA section at the top of the form and then filling in the TREATMENT DATA in both of the B2 Sections, with the SE ID in all ten occurrences being filled in identically to the SE ID in Section B1. If more than ten iterations of TREATMENT DATA are needed, additional forms would be necessary. The same methodology would apply to VARIANCES, EXEMPTIONS & OTHER RELATED DATA and VE SCHEDULE data (Data Capture Form F).

GENERAL CODING INSTRUCTIONS

All Data Capture Forms have several items in common. These include, PWS ID, ACTION CODE, BATCH DATE, and SECTION TYPE. Use of these items is as follows:

PWS ID (C101) - This is an alphanumeric value that is used to uniquely identify a public water system. PWS ID is always prefixed with a valid United States Postal Service (USPS) abbreviation or EPA Region code which is then followed by a 7-character identifier that is unique for each PWS within that State or Region. The following rules apply when specifying PWS ID:

- o Positions 1 - 2 must be a valid USPS State code or for Indian Lands, an EPA Region code from 01 through 10 should be used where applicable.
- o Positions 3 - 9 must be unique for each PWS within a State
- o Positions 3 - 9 may contain alphanumeric characters A - Z or 0 - 9.
- o Positions 3 - 9 must not contain any special characters (i.e., other than A - Z or 0 - 9).

ACTION CODE - This is an alphabetic value that determines the action that the FRDS-II Computer System will take with the specified data. ACTION CODES must always be specified and must be one of the following values:

ACTION CODE

D (DELETE) = This ACTION CODE causes an entire Data Base Record (DBR) to be deleted from the FRDS-II Data Base. In order for a DBR to be deleted, it must exist in the data base. When a violation record is deleted, all RELATED enforcement records will also be deleted. However, enforcement records related to other violations as well, will NOT be deleted.

GENERAL CODING INSTRUCTIONS

ACTION CODE

- I (INSERT) = This ACTION CODE causes a new DBR to be inserted into the FRDS-II Data Base. DBRs with duplicate record IDs are not allowed in the FRDS-II Data Base. If a record being added has a record ID that already exists in the data base, it will not be inserted into the data base.
- M (MODIFY) = This ACTION CODE causes the current value of a data element in an already existing DBR to be modified. Modifying the current value includes the removal (blanking out) of an existing data value. This can be accomplished by entering a dollar sign (\$) in the first position (left-most) of the data element to be removed. Some data elements in the FRDS-II Data Base may not be removed. Refer to the Data Element Registration Tables (that follow the data entry instructions for each record type) to see if removal is allowed. Also, see Chapter V, "DATA ELEMENT REMOVAL VS. DATA BASE RECORD DELETION."

BATCH DATE - This may be any valid calendar date that the user desires. Some consideration should be given to the date that is entered in BATCH DATE, since it is used to "time sequence" events that take place during an update of the FRDS-II Data Base. "Time sequencing" determines the order of processing of duplicate transaction types (e.g., two violation transactions with the same PWS ID and the same VIOLATION ID), by posting the transaction with the most recent BATCH DATE last. In other words, the transaction with the earlier BATCH DATE will be "overlaid" by the transaction with the most recent (later) BATCH DATE.

When inserting a PWS in performing a traditional update (updates that are not total replace), all "registration requirement" data elements for the PWS must be submitted with the same Batch Date. Data elements that are not required for data base registration may contain any Batch Date the user so desires.

Note: When transactions are submitted as a "total replace", BATCH DATE is disregarded by the FRDS-II Computer System.

GENERAL CODING INSTRUCTIONS

DECIMALS

- When entering numbers into data elements that are defined as decimal, the user should be aware of the following constraints:
 - o Decimal numbers MUST contain the decimal point.
 - o The maximum number of positions (as determined by the rules for the data element involved) in the integer portion or the decimal portion of the number being entered, cannot be exceeded.
 - o A whole number may be entered without the decimal point, as long as it does not exceed the length of the defined integer portion of the number.

Decimal data elements that do not meet the above criteria, will be rejected by the FRDS-II System.

EXAMPLE: Consider the decimal data element REACH MILES, which is defined as 9(4).9(2) - (a four position integer and a two position decimal).

INPUT	RESULT
1234.56	1234.56
1	0001.00
1.1	0001.10
1234	1234.00
123456	ILLEGAL
0.01	0000.01
0.001	ILLEGAL
12345.6	ILLEGAL

SECTION TYPE - This is the letter/number combination (i.e. A1, A2, etc.) that appears in the boxes on the left hand side of the data capture forms. It is used to identify SECTION TYPE on the FRDS-II Data Capture forms. SECTION TYPE is also used to relate sections on the data capture forms to Data Base Records (DBRs) in the FRDS-II Data Base. This data is always required in order to ensure proper data placement or deletion.

FRDS-II DATA ENTRY INSTRUCTIONS

CHAPTER VIII

DETAILED CODING INSTRUCTIONS

FRDS-II DATA ENTRY INSTRUCTIONS

DATA CAPTURE FORM A

SECTION A1 - SYSTEM ADDRESS

SECTION A1 - SYSTEM ADDRESS
(See Figure 14)

This section is used to enter facility name and address information for a public water system. Where multiple facilities exist for a public water system at different locations, this section should be used to enter address information for the system as a whole. The following data may be entered via this section:

SYSTEM NAME
(C131)

Enter the name of the public water system. Up to 30 positions may be specified and any combination of alphabetic, numeric or special characters is allowed. SYSTEM NAME can be the formal, legal or common name that is used most generally in referring to the public water system.

ADDRESS LINE 1
(C133)

Enter address data (generally other than street address) such as the name of a responsible person or agency, or information applicable to the primary facility location of the public water system. If this data is unknown or does not exist for the public water system, do not provide this data.

ADDRESS LINE 2
(C135)

Enter address data such as the street address, rural route and/or box designation, etc., that is applicable to the primary facility location of the public water system. If a street address or rural route and/or box number does not exist for the public water system, do not provide this data.

CITY
(C137)

Enter the city name that is applicable to the primary facility location of the public water system.

STATE
(C139)

Enter the United States Postal Service (USPS) State abbreviation that is applicable to the primary facility location of the public water system. The State code must be a valid 2-character USPS State abbreviation as found in SECTION VI, Table ID02, in the Federal Reporting Data System Data Element Dictionary.

SECTION A1 - SYSTEM ADDRESS

ZIP CODE + 4
(C141)

Enter the ZIP CODE +4 that is applicable to the primary facility location of the public water system. If the +4 portion of the zip code is unknown, leave that portion blank.

TELEPHONE NUMBER (AREA CODE & NUMBER)
(C143)

Enter the telephone number of the public water system. TELEPHONE NUMBER identifies the area code and phone number which is applicable to the primary facility of or the principal contact person for the public water system. If the AREA CODE is unknown, the 7-digit phone number may be entered by itself.

SECTION A1 - SYSTEM ADDRESS
DATA ELEMENT REGISTRATION TABLE

DATA ELEMENT N°M.	FORM REFERENCE NAME	A/N/D	JUST	SIN	ZERO FILL	REG. CODE	GRANT ELIG.	CBR
C131	SYSTEM NAME	A	L				Y	Y
C133	ADDRESS LINE 1	A	L	Y				Y
C135	ADDRESS LINE 2	A	L	Y				Y
C137	CITY	A	L				Y	Y
C139	STATE	A	L				Y	Y
C141	ZIP CODE + 4	A	L				Y*	Y
C143	TELEPHONE	A	L	Y				Y

* At least the 5-digit zip code is required for grant eligibility.

LEGEND:

A/N/D	- A = ALPHANUMERIC, N = NUMERIC, D = DECIMAL
JUST	- L = LEFT JUSTIFY, R = RIGHT JUSTIFY, A = ALIGN
SIN	- Y = SKIP IF NONE OR NOT APPLICABLE
ZERO FILL	- Y = ENTER PRECEDING ZEROS OR ZERO FILL REMAINING DECIMAL PLACES
REG. CODE	- 1 = OPERATIONALLY REQUIRED 2 = PROGRAMMATICALLY REQUIRED 3 = OPERATIONALLY REQUIRED, CONDITIONALLY 4 = PROGRAMMATICALLY REQUIRED, CONDITIONALLY (SEE CHAPTER IV, "DATA BASE REGISTRATION REQUIREMENT", FOR FURTHER EXPLANATION)
GRANT ELIG.	- Y = DATA ELEMENT IS REQUIRED FOR A PWS TO BE CONSIDERED "GRANT ELIGIBLE" C = DATA ELEMENT IS CONDITIONALLY REQUIRED FOR A PWS TO BE CONSIDERED "GRANT ELIGIBLE"
CBR	- Y = CAN BE REMOVED (i.e., \$ IN LEFT-MOST POSITION) - N = CANNOT BE REMOVED

FRDS-II DATA ENTRY INSTRUCTIONS

DATA CAPTURE FORM A

SECTION A2 - PUBLIC WATER SYSTEM CHARACTERISTICS

SECTION A2 - PUBLIC WATER SYSTEM CHARACTERISTICS
(See Figure 14)

This section is used to enter data related to the various physical characteristics of the public water system. The following data may be entered via this section:

PWS TYPE
(C105)

Enter a 'C' if the public water system is a community system, an 'N' if a non-community system, or a 'P' if a non-transient non-community system.

A community water system is a public water system that has at least 15 service connections used by year-round residents or regularly serves at least 25 year-round residents.

A non-community water system is a public water system that does not meet the requirements to be a community or a non-transient water system.

A non-transient non-community water system (NTNCWS) is a public water system that is not a community water system and that serves regularly at least 25 service connections used by year-round residents or regularly serves at least 25 of the same persons over 6 months per year.

ACTIVITY FLAG
(C107)

Enter an 'A' if the public water system is active or an 'I' if the water system is inactive. If an 'I' is entered for an inactive PWS, DEACTIVATION DATE must also be specified.

SYSTEM BEGIN (YR & MO)
(C111)

Enter the year and month the public water system initiated operation. If the date the PWS initiated operation is not known, enter the "best estimate" of when operation began. For example, January, 1987 would be entered as 8701.

DEACTIVATION DATE (YR & MO)
(C113)

Enter the year and month that the system was deactivated. For example, January, 1987 would be entered as 8701. DEACTIVATION DATE must be specified if ACTIVITY FLAG is an 'I' (inactive).

SECTION A2 - PUBLIC WATER SYSTEM CHARACTERISTICS

RETAIL POPULATION SERVED (C117)

Enter the number of retail customers served by the public water system. If the public water system has large seasonal fluctuations in the number of retail customers served, enter the average number of customers served. When RETAIL POPULATION SERVED is specified, the following rules apply:

- o Must be numeric
- o Must be greater than or equal to .00000001
- o Should be greater than or equal to 25 if C147, RETAIL SERVICE CONNECTIONS, is less than 15

NOTE: RETAIL POPULATION SERVED can be zero if no retail population is served and a service area characteristic (see Data Capture Form C, Section C2) identifies the PWS as a wholesaler of water.

PERCENT SURFACE (C121)

Enter the annual average percentage of water obtained from non-purchased, permanently available surface water sources. The total of this percentage along with PERCENT GROUND, PERCENT PURCHASED SURFACE, and PERCENT PURCHASED GROUND should be equal to 100.

If the public water system has only one source of water, or if all sources are of the same type, this data does not have to be specified. When PERCENT SURFACE is specified, the following rules apply:

- o Must be numeric
- o Must be greater than or equal to zero
- o Should be less than or equal to 100
- o Must not contain a percent sign (%) or decimal point (.)

SECTION A2 - PUBLIC WATER SYSTEM CHARACTERISTICS

PERCENT GROUND (C123)

Enter the annual average percentage of water obtained from non-purchased, permanently available ground water sources. The total of this percentage along with PERCENT SURFACE; PERCENT PURCHASED SURFACE and PERCENT PURCHASED GROUND should be equal to 100.

If the public water system has only one source of water, or if all sources are of the same type, this data does not have to be specified. When PERCENT GROUND is specified, the following rules apply:

- o Must be numeric
- o Must be greater than or equal to zero
- o Should be less than or equal to 100
- o Must not contain a percent sign (%) or decimal point (.)

PERCENT PURCHASED SURFACE (C125)

Enter the annual average percentage of water obtained from purchased, permanently available surface water sources. The total of this percentage along with PERCENT SURFACE; PERCENT GROUND; and PERCENT PURCHASED GROUND should be equal to 100.

If the public water system has only one source of water, or if all sources are of the same type, this data does not have to be specified. When PERCENT PURCHASED SURFACE is specified, the following rules apply:

- o Must be numeric
- o Must be greater than or equal to zero
- o Should be less than or equal to 100
- o Must not contain a percent sign (%) or decimal point (.)

SECTION A2 - PUBLIC WATER SYSTEM CHARACTERISTICS

PERCENT PURCHASED GROUND (C127)

Enter the annual average percentage of water obtained from purchased, permanently available ground water sources. The total of this percentage along with PERCENT SURFACE; PERCENT GROUND; PERCENT PURCHASED SURFACE should be equal to 100.

If the public water system has only one source of water, or if all sources are of the same type, this data does not have to be specified. When PERCENT PURCHASED GROUND is specified, the following rules apply:

- o Must be numeric
- o Must be greater than or equal to zero
- o Should be less than or equal to 100
- o Must not contain a percent sign (%) or decimal point (.)

OWNER TYPE (C163)

Enter the code value that identifies the type of owner of a public water system. Valid owner type codes may be found in SECTION VI, Table 0163, in the Federal Reporting Data System Data Element Dictionary.

REGULATING ENTITY (C165)

Enter the code value that represents whether a public water system is regulated by Federal, State, both Federal and State, or neither Federal nor State drinking water regulations. Valid codes are as follows:

- "F" = Regulated by Federal regulations
- "S" = Regulated by State regulations
- "B" = Regulated by both Federal and State regulations
- "N" = Not State or Federally regulated

RETAIL SERVICE CONNECTIONS (C147)

Enter the number of retail service connections that a public water system had in the most recent year. When this data element is specified, the following rules apply:

- o Must be numeric
- o Should be greater than or equal to 15 if C117, RETAIL POPULATION SERVED is less than 25

SECTION A2 - PUBLIC WATER SYSTEM CHARACTERISTICS

PWS SEASON BEGIN (MO & DAY)
(C159)

Enter the month and day a non-community or Non-Transient Non-Community Water System's (NTNCWS) season of operation normally begins. For example, October 9th would be entered as 1009. If a community public water system, do not provide this data.

** See note below.

PWS SEASON END (MO & DAY)
(C161)

Enter the month and day a non-community or Non-Transient Non-Community Water System's (NTNCWS) season of operation normally ends. For example, October 9th would be entered as 1009. If a community public water system, do not provide this data.

** See note below

** NOTE: In order for a non-community Public Water System to be considered grant eligible, the period of time covered by the season begin and season end dates must be a minimum of sixty days. The same rule applies to a non-transient non-community Public Water System, except that the minimum period of time to be covered is 180 days.

SECTION A2 - PUBLIC WATER SYSTEM CHARACTERISTICS
DATA ELEMENT REGISTRATION TABLE

DATA ELEMENT	FORM REFERENCE NAME	A/N/D	JUST	SIN	FILL	ZERO REG. CODE	GRANT ELIG.	CBR
C105	PWS TYPE	A	N/A			2	Y	N
C107	ACTIVITY FLAG	A	N/A			2	Y	N
C111	SYSTEM BEGIN	N	L		Y			Y
C113	DEACTIVATION DATE	N	L	Y	Y	4		Y
C117	RETAIL POPULATION SERVED	N	L			2	Y	N
C121	PERCENT SURFACE	N	L	Y				Y
C123	PERCENT GROUND	N	L	Y				Y
C125	PERCENT PURCHASED SURFACE	N	L	Y				Y
C127	PERCENT PURCHASED GROUND	N	L	Y				Y
C147	RETAIL SERVICE CONNECTIONS	N	L			2	Y	N
C159	PWS SEASON BEGIN	N	L	Y	Y		C	Y
C161	PWS SEASON END	N	L	Y	Y		C	Y
C163	OWNER TYPE	A	N/A				Y	Y
C165	REGULATING ENTITY	A	N/A				Y	Y

=====

LEGEND:

A/N/D - A = ALPHANUMERIC, N = NUMERIC, D = DECIMAL

JUST - L = LEFT JUSTIFY, R = RIGHT JUSTIFY, A = ALIGN

SIN - Y = SKIP IF NONE OR NOT APPLICABLE

ZERO FILL - Y = ENTER PRECEDING ZEROS OR ZERO FILL
 REMAINING DECIMAL PLACES

REG. CODE - 1 = OPERATIONALLY REQUIRED
 2 = PROGRAMMATICALLY REQUIRED
 3 = OPERATIONALLY REQUIRED, CONDITIONALLY
 4 = PROGRAMMATICALLY REQUIRED, CONDITIONALLY
 (SEE CHAPTER IV, "DATA BASE REGISTRATION
 REQUIREMENT", FOR FURTHER EXPLANATION)

GRANT ELIG.- Y = DATA ELEMENT IS REQUIRED FOR A PWS TO BE
 CONSIDERED "GRANT ELIGIBLE"

 C = DATA ELEMENT IS CONDITIONALLY REQUIRED FOR A
 PWS TO BE CONSIDERED "GRANT ELIGIBLE"

CBR - Y = CAN BE REMOVED (i.e., \$ IN LEFT-MOST POSITION)
 - N = CANNOT BE REMOVED

FRDS-II DATA ENTRY INSTRUCTIONS

DATA CAPTURE FORM A

SECTION A3 - OTHER ADDRESS(ES)

SECTION A3 - OTHER ADDRESS(ES)
(See Figure 14)

This section is used to enter additional address information, such as an owner address or related facility addresses. The following data may be entered via this section:

ADDRESS ID
(C301)

Enter a numeric value that will uniquely identify an owner address, treatment facility address, or other address related to the public water system. ADDRESS ID must be valued in order for a new address record to be inserted into the FRDS-II Data Base.

Note: See Chapter VI, "Record Identification and Maximum Occurances" for user assignment and automatic generation of this ID.

ADDRESS TYPE
(C303)

Enter the code value that identifies the type of addressee or facility of a public water system. The address type codes are contained in SECTION VI, Table 0303 in the Federal Reporting Data System Data Element Dictionary. ADDRESS TYPE must be valued in order for a new address record to be inserted into the FRDS-II Data Base.

ADDRESSEE NAME
(C305)

Enter the name of an addressee or facility of a public water system. Any combination of alphabetic, numeric, or special characters is allowed.

ADDRESS LINE 1
(C307)

Enter the first line of an address applicable to a public water system addressee or facility. This can be used for the name of a responsible person or agency, or it can be an additional address line applicable to the location of a public water system addressee or facility.

ADDRESS LINE 2
(C309)

Enter the second line of an address applicable to a public water system addressee or facility. ADDRESS LINE 2 is the street, rural route and box designation, etc. that is applicable to the location of a public water system addressee or facility.

SECTION A3 - OTHER ADDRESS(ES)

CITY
(C311)

Enter the city in which a public water system addressee or facility is located.

STATE
(C313)

Enter the U. S. Postal Service State abbreviation in which a public water system addressee or facility is located.

ZIP CODE + 4
(C315)

Enter the U. S. Postal Service ZIP code in which a public water system addressee or facility is located. If the + 4 portion of the ZIP CODE + 4 is unknown, leave that portion blank. At least the 5-digit portion of ZIP CODE + 4 must be valued in order for a new address record to be inserted into the FRDS-II Data Base.

SECTION A3 - OTHER ADDRESS(ES)
DATA ELEMENT REGISTRATION TABLE

DATA ELEMENT NM.	FORM REFERENCE NAME	A/N/D	JUST	SIN	FILL	ZERO REG. CODE	GRANT ELIG.	CBR
C301	ADDRESS ID	N	L			3		N
C303	ADDRESS TYPE	A	N/A					Y
C305	ADDRESSEE NAME	A	L					Y
C307	ADDRESS LINE 1	A	L	Y				Y
C309	ADDRESS LINE 2	A	L	Y				Y
C311	CITY	A	L					Y
C313	STATE	A	L					Y
C315	ZIP CODE + 4 *	A	L					Y

* Provide 9-digit zip code if known - 5-digit zip code is acceptable

=====

LEGEND:

A/N/D	-	A = ALPHANUMERIC, N = NUMERIC, D = DECIMAL
JUST	-	L = LEFT JUSTIFY, R = RIGHT JUSTIFY, A = ALIGN
SIN	-	Y = SKIP IF NONE OR NOT APPLICABLE
ZERO FILL	-	Y = ENTER PRECEDING ZEROS OR ZERO FILL REMAINING DECIMAL PLACES
REG. CODE	-	1 = OPERATIONALLY REQUIRED
		2 = PROGRAMMATICALLY REQUIRED
		3 = OPERATIONALLY REQUIRED, CONDITIONALLY
		4 = PROGRAMMATICALLY REQUIRED, CONDITIONALLY
		(SEE CHAPTER IV, "DATA BASE REGISTRATION REQUIREMENT", FOR FURTHER EXPLANATION)
GRANT ELIG.	-	Y = DATA ELEMENT IS REQUIRED FOR A PWS TO BE CONSIDERED "GRANT ELIGIBLE"
		C = DATA ELEMENT IS CONDITIONALLY REQUIRED FOR A PWS TO BE CONSIDERED "GRANT ELIGIBLE"
CBR	-	Y = CAN BE REMOVED (i.e., \$ IN LEFT-MOST POSITION)
		N = CANNOT BE REMOVED



Public Water System Data Capture Form A

PWS ID
State ID Number
(C101)

ACTION CODE
I = Insert M = Modify

BATCH DATE
MO DAY YR

SYSTEM ADDRESS

A1

SYSTEM NAME
(C131)

ADDRESS LINE 1
(C133)

ADDRESS LINE 2
(C135)

CITY STATE ZIP CODE +4
(C137) (C139) (C141)

AREA CODE TELEPHONE NUMBER
(C143)

PUBLIC WATER SYSTEM CHARACTERISTICS

A2

PWS TYPE: C = COMMUNITY, N = NON-COMMUNITY, P = NON-TRANSIENT, NON-COMMUNITY
(C105)

ACTIVITY FLAG: A = ACTIVE, I = INACTIVE
(C107)

SYSTEM BEGIN YR MO
(C111)

DEACTIVATION DATE YR MO
(C113)

RETAIL POPULATION SERVED
(C117)

SOURCE WATER UTILIZED: PERCENT SURFACE (C121) + PERCENT GROUND (C123) + PERCENT PURCHASED SURFACE (C125) + PERCENT PURCHASED GROUND (C127) = 100%

OWNER TYPE (C163) REGULATING ENTITY (C165) RETAIL SERVICE CONNECTIONS (C147) NON-COMMUNITY SEASON BEGIN MO DAY (C159) END MO DAY (C161)

OTHER ADDRESS(ES)

A3

ID TYPE ADDRESSEE NAME
(C301) (C303) (C305)

ADDRESS LINE 1
(C307)

ADDRESS LINE 2
(C309)

CITY STATE ZIP CODE +4
(C311) (C313) (C315)

FRDS-II DATA ENTRY INSTRUCTIONS

DATA CAPTURE FORM B

SECTION B1 - SOURCE / ENTITY DATA

SECTION B1 - SOURCE / ENTITY DATA
(See Figure 16)

This section is used to enter data that characterizes a source of water that is utilized by, or an entity that is related to, a public water system. An entity can be any location or facility related to the public water system. Such entities include distribution system entry points, treatment facilities, pumping facilities, water storage facilities, and the like. In order for the FRDS-II computer system to permit the addition of a new public water system, at least one source entity data record must be specified with an SE RECORD TYPE indicating a source of water and an SE CODE indicating a valid source code. The following data may be entered via this section:

SE ID
(C401)

Enter a numeric value that will uniquely identify a specific source of water that is utilized by, or an entity (e.g., entry point, treatment facility, reservoir, etc.) that is related to, a public water system.

Note: See Chapter VI, "Record Identification and Maximum Occurrences" for user assignment and automatic generation of this ID. Also, see Appendix C, "Anytown USA, Public Water System", for examples of Source/ Treatment relationships.

NAME
(C403)

Enter the name of the source of water or the name of an entity (e.g., name of treatment plant) related to a public water system.

SE RECORD TYPE
(C405)

Enter the code that identifies whether this record is a source record or an entry point record. Valid SE RECORD TYPE codes may be found in SECTION VI, Table 0405 in the FRDS-II Data Element Dictionary.

SE RECORD TYPE is used in conjunction with C407 (SE CODE) and must be a valid combination thereof. Valid combinations may be found in SECTION VI Table ID10, in the FRDS-II Data Element Dictionary.

In order for the FRDS-II system to permit the addition of a new public water system (i.e., data base registration), at least one Source Entity record must be specified with an SE RECORD TYPE, of "S", indicating a source of water.

SECTION B1 - SOURCE / ENTITY DATA

SE CODE
(C407)

Enter the code that describes the type of source water, entry point or plant. Valid SE CODEs may be found in SECTION VI, Table 0407, in the FRDS-II Data Element Dictionary.

SE CODE is used in conjunction with C405 (SE RECORD TYPE) and must be a valid combination thereof. Valid combinations may be found in SECTION VI, Table ID10, in the FRDS-II Data Element Dictionary.

AVAILABILITY
(C409)

Enter the code value that represents the circumstances under which a source of water utilized by, or an entity related to, a public water system is used or operated. Examples of valid codes may be found in SECTION VI, Table 0409, in the Federal Reporting Data System Data Element Dictionary.

SELLER PWS ID
(C411)

Enter the State-prefixed PWS ID of the public water system from whom water is purchased. SELLER PWS ID is valid only for purchased sources of water (i.e., where SE RECORD TYPE is an "S" and SE CODE is "p" or "W").

SECTION B1 - SOURCE / ENTITY DATA

LATITUDE (DEG, MIN, & SEC)
(C415)

Enter the degrees, minutes, and seconds of LATITUDE for the location of the entity being reported.

LATITUDE is required when inserting a Source / Entity record, if LONGITUDE is specified.

Valid min/max latitudes may be found in Section VI, Table 0509 (FIPS County Codes) and 0427 (Hydrologic Unit Codes) in the Federal Reporting Data System Data Element Dictionary.

When blanking out (initializing to nulls) LATITUDE by using a dollar sign (\$) in the left-most position, LONGITUDE will also be blanked out (initialized to nulls).

LONGITUDE (DEG, MIN, & SEC)
(C417)

Enter the degrees, minutes, and seconds of LONGITUDE for the location of the entity being reported.

LONGITUDE is required when inserting a Source / Entity record, if LATITUDE is specified.

Valid min/max longitudes may be found in Section VI, Table 0509 (FIPS County Codes) and 0427 (Hydrologic Unit Codes) in the Federal Reporting Data System Data Element Dictionary.

When blanking out (initializing to nulls) LONGITUDE by using a dollar sign (\$) in the left-most position, LATITUDE will also be blanked out (initialized to nulls).

SECTION B1 - SOURCE / ENTITY DATA

TOWNSHIP / RANGE

(C419, C421, C423, C425)

Enter the TOWNSHIP / RANGE data for the location of the entity being reported. When TOWNSHIP / RANGE data is specified, the following rules apply:

TOWNSHIP / RANGE data is used to describe an area of land and is made up of four separate data elements. None of these four data elements is meaningful by itself, but when all are used, they will define an area of one quarter square mile. (See figure 15 on the following page.) The four data elements are described as follows:

TOWNSHIP (C419) - Positions 1 - 3 is a number that represents the location of a TOWNSHIP in relationship to a known base line. Position 4 is the direction ("N" for North, or "S" for South) from a known base line. Rules for entering TOWNSHIP are as follows:

- o Positions 1 - 3 must be numeric
- o Positions 1 - 3 must be greater than or equal to 001
- o Position 4 must be ...
 - "N" (i.e., the township is north of the base line) or
 - "S" (i.e., the township is south of the base line)

RANGE (C421) - Positions 1 - 3 is a number that represents the location of a RANGE in relationship to a known Principal Meridian. Position 4 is the direction ("E" for East or "W" for West) from a known Principal Meridian. The rules for entering RANGE are as follows:

- o Positions 1 - 3 must be numeric
- o Positions 1 - 3 must be greater than or equal to 001
- o Position 4 must be ...
 - "E" (i.e., the range is east of the Principal Meridian) or
 - "W" (i.e., the range is west of the Principal Meridian)

TOWNSHIP GRID

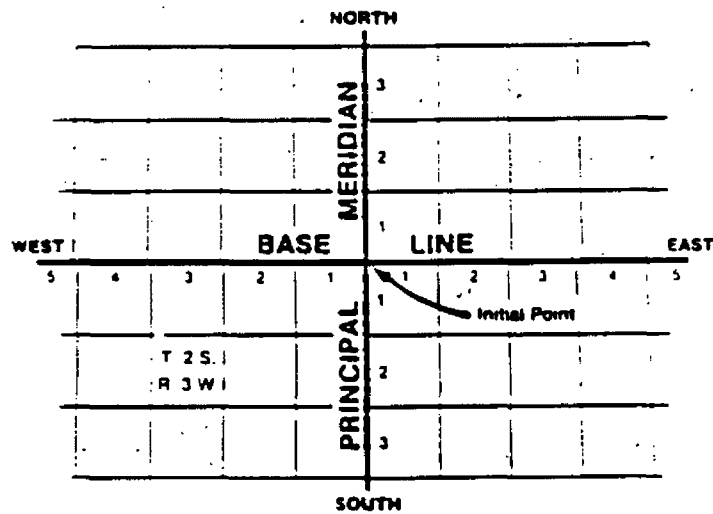

TOWNSHIP 2 SOUTH, RANGE 3 WEST

6	5	4	3	2	1
7	8	9	10	11	12
18	17	16	15	SEC. 14	13
19	20	21	22	23	24
30	29	28	27	26	25
31	32	33	34	35	36

SECTION 14

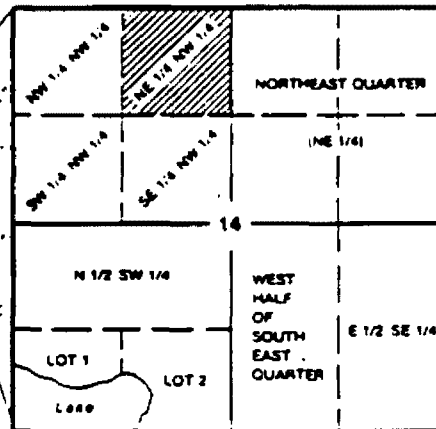

SECTION B1 - SOURCE / ENTITY DATA

SECTION (C423) - This is a numeric value that represents one of the 36 sections of a township. The 36 sections are numbered in a zigzag fashion, beginning with section 01 in the northeast corner of a township and ending with section 36 in the southeast corner of the township. SECTION must be entered under the following rules:

- o must be numeric
- o must be greater than or equal to 01 and less than or equal to 36.

QUARTER SECTION (C425) - This an alphabetic value that represents a particular quadrant of a section. The four quadrants are identified as follows:

- o "NW" (i.e., the northwest quadrant of the section)
- o "NE" (i.e., the northeast quadrant of the section)
- o "SW" (i.e., the southwest quadrant of the section)
- o "SE" (i.e., the southeast quadrant of the section)

When blanking out (initializing to nulls) TOWNSHIP/RANGE data the following rules apply:

- o A dollar sign (\$) in the left-most position of TOWNSHIP or RANGE will cause all TOWNSHIP/RANGE data to be blanked out.
- o A dollar sign (\$) in the left-most position of SECTION will cause SECTION and QUARTER SECTION to be blanked out.
- o A dollar sign (\$) in the left-most position of QUARTER SECTION will cause only QUARTER SECTION to be blanked out.

RIVER REACH (C427)

Enter the value that identifies the hydrologic unit code and, if appropriate, the segment number for the location of the source or entity being reported. For a complete description of RIVER REACH, see the Federal Reporting Data System Data Element Dictionary. Valid hydrologic unit codes are found in SECTION VI, Table 0427, in the Federal Reporting Data System Data Element Dictionary.

SECTION B1 - SOURCE / ENTITY DATA

ON REACH (C429)

Enter the value that represents whether a source of water is "on" or "off" a defined river reach. If the source of water is on a defined river reach enter a "Y". If the source of water is off a defined river reach, enter an "N". ON REACH is required when RIVER REACH or REACH MILES has been specified. For a complete discussion of ON REACH, see the Federal Reporting Data System Data Element Dictionary, under C427, PWS-SE-RIVER-REACH-NUM, and C429, PWS-SE-ON-REACH.

REACH MILES (C431)

Enter the numeric value that defines an exact location in miles, of a surface source intake in relationship to the downstream end of the river reach, if the source is "on" a defined river reach.

- o The integer portion cannot exceed 4 positions
- o The decimal portion cannot exceed 2 positions
- o Must be numeric
- o Must be greater than or equal to zero

The rules for entering decimal numbers into the FRDS-II System, are discussed in Chapter VII, "GENERAL CODING INSTRUCTIONS."

SECTION B1 - SOURCE / ENTITY DATA
DATA ELEMENT REGISTRATION TABLE

DATA
ELEMENT

DATA ELEMENT	FORM REFERENCE NAME	A/N/D	JUST	SIN	FILL	ZERO REG. CODE	GRANT ELIG.	CBR
C401	SE ID	N	L			Y 1		N
C403	NAME	A	L	Y				Y
C405	SE RECORD TYPE	A	N/A			1		N
C407	SE CODE	A	N/A			2	Y	N
C409	AVAILABILITY	A	N/A				C	Y
C411	SELLER PWS ID	A	L				C	Y
C415	LATITUDE	N	L	Y	Y			Y
C417	LONGITUDE	N	L	Y	Y			Y
C419	TOWNSHIP	A	L	Y	Y			Y
C421	RANGE	A	L	Y	Y			Y
C423	SECTION	N	L	Y	Y			Y
C425	QUARTER SECTION	A	L	Y	Y			Y
C427	RIVER REACH	A	L	Y	Y			Y
C429	ON REACH	A	N/A	Y				Y
C431	REACH MILES	D	A	Y	Y			Y

LEGEND:

A/N/D - A = ALPHANUMERIC, N = NUMERIC, D = DECIMAL
JUST - L = LEFT JUSTIFY, R = RIGHT JUSTIFY, A = ALIGN
SIN - Y = SKIP IF NONE OR NOT APPLICABLE
ZERO FILL - Y = ENTER PRECEDING ZEROS OR ZERO FILL
REMAINING DECIMAL PLACES
REG. CODE - 1 = OPERATIONALLY REQUIRED
2 = PROGRAMMATICALLY REQUIRED
3 = OPERATIONALLY REQUIRED, CONDITIONALLY
4 = PROGRAMMATICALLY REQUIRED, CONDITIONALLY
(SEE CHAPTER IV, "DATA BASE REGISTRATION
REQUIREMENT", FOR FURTHER EXPLANATION)
GRANT ELIG. - Y = DATA ELEMENT IS REQUIRED FOR A PWS TO BE
CONSIDERED "GRANT ELIGIBLE"
C = DATA ELEMENT IS CONDITIONALLY REQUIRED FOR A
PWS TO BE CONSIDERED "GRANT ELIGIBLE"
CBR - Y = CAN BE REMOVED (i.e., \$ IN LEFT-MOST POSITION)
- N = CANNOT BE REMOVED

FRDS-II DATA ENTRY INSTRUCTIONS

DATA CAPTURE FORM B

SECTION B2 - TREATMENT DATA

SECTION B2 - TREATMENT DATA
(See Figure 16)

This section should be used to enter data that identifies treatment objectives and processes that are applied to a unique source of water used by a public water system. At least one treatment data record must be specified for each source of water used by a public system. A complete treatment record consists of the TREATMENT OBJECTIVE and the TREATMENT PROCESS. The following data may be entered via this section:

Note: For both SE ID and TREATMENT ID below, see Chapter VI, "Record Identification and Maximum Occurrences" for user assignment and automatic generation of this ID. Also, see Appendix C, "Anytown USA, Public Water System", for examples of Source/ Treatment relationships.

SE ID
(C401)

Enter the SE ID that identifies the source of water to which this treatment data is to be applied. In order to be registered into the FRDS-II system every source must have a treatment objective and treatment process specified.

TREATMENT ID
(C481)

Enter a numeric value that will uniquely identify the specific treatment to be applied to a source of water.

TREATMENT OBJECTIVE
(C483)

Enter the code value that identifies the objective to be attained through treatment of a source of water. The code value specified must be a valid treatment objective code as found in SECTION VI, Table ID05, in the Federal Reporting Data System Data Element Dictionary. It should be noted that a valid treatment objective is "no treatment" and if applicable, TREATMENT OBJECTIVE should be coded as such (i.e., TREATMENT OBJECTIVE code of "N" and TREATMENT PROCESS code of "000").

TREATMENT OBJECTIVE is used in conjunction with C485 (TREATMENT PROCESS) and must be a valid combination thereof. Valid combinations may be found in SECTION VI, Table ID03, in the FRDS-II Data Element Dictionary.

SECTION B2 - TREATMENT DATA

TREATMENT PROCESS (C485)

Enter the code value that identifies the treatment process to be applied to a source of water. The code value specified must be a valid treatment process code as found in SECTION VI, Table ID04, in the Federal Reporting Data System Data Element Dictionary. It should be noted that a valid treatment process is "no treatment" and if applicable, should be coded as such. (i.e., TREATMENT OBJECTIVE code of "N" and a TREATMENT PROCESS code of "000").

TREATMENT PROCESS is used in conjunction with C483 (TREATMENT OBJECTIVE) and must be a valid combination thereof. Valid combinations may be found in SECTION VI, Table ID03, in the FRDS-II Data Element Dictionary.

SECTION B2 - TREATMENT DATA
DATA ELEMENT REGISTRATION TABLE

DATA ELEMENT	FORM REFERENCE NAME	A/N/D	JUST	SIN	FILL	REG. CODE	GRANT ELIG.	CBR
C401	SE ID	N	L		Y	1		N
C481	TREATMENT ID	N	L		Y	3		N
C483	TREATMENT OBJECTIVE	A	N/A				C	Y
C485	TREATMENT PROCESS	N	L		Y		C	Y

=====

LEGEND:

A/N/D - A = ALPHANUMERIC, N = NUMERIC, D = DECIMAL

JUST - L = LEFT JUSTIFY, R = RIGHT JUSTIFY, A = ALIGN

SIN - Y = SKIP IF NONE OR NOT APPLICABLE

ZERO FILL - Y = ENTER PRECEDING ZEROS OR ZERO FILL
 REMAINING DECIMAL PLACES

REG. CODE - 1 = OPERATIONALLY REQUIRED
 2 = PROGRAMMATICALLY REQUIRED
 3 = OPERATIONALLY REQUIRED, CONDITIONALLY
 4 = PROGRAMMATICALLY REQUIRED, CONDITIONALLY
 (SEE CHAPTER IV, "DATA BASE REGISTRATION
 REQUIREMENT", FOR FURTHER EXPLANATION)

GRANT ELIG. - Y = DATA ELEMENT IS REQUIRED FOR A PWS TO BE
 CONSIDERED "GRANT ELIGIBLE"

 C = DATA ELEMENT IS CONDITIONALLY REQUIRED FOR A
 PWS TO BE CONSIDERED "GRANT ELIGIBLE"

CBR - Y = CAN BE REMOVED (i.e., \$ IN LEFT-MOST POSITION)

 - N = CANNOT BE REMOVED



Public Water System Data Capture Form B

PWS ID **ACTION CODE** **BATCH DATE**

State ID Number MO DAY YR

(C101) I = Insert M = Modify

SOURCE / ENTITY DATA

B1 SE ID NAME SE RECORD TYPE SE CODE AVAILABILITY

(C401) (C403) (C405) (C407) (C408)

STATE SELLER PWS ID DATA ORIGIN LATITUDE LONGITUDE

DEG MIN SEC DEG MIN SEC

(C411) (C413) (C415) (C417)

TOWNSHIP N/S TOWNSHIP RANGE E/W SEC 1/4 SEC RIVER REACH ON REACH REACH MILES

(C419) (C421) (C423) (C425) (C427) (C429) (C431)

TREATMENT DATA

B2 SE ID TREATMENT ID TREATMENT OBJECTIVE TREATMENT PROCESS

(C401) (C481) (C483) (C485)

SOURCE / ENTITY DATA

B1 SE ID NAME SE RECORD TYPE SE CODE AVAILABILITY

(C401) (C403) (C405) (C407) (C408)

STATE SELLER PWS ID DATA ORIGIN LATITUDE LONGITUDE

DEG MIN SEC DEG MIN SEC

(C411) (C413) (C415) (C417)

TOWNSHIP N/S TOWNSHIP RANGE E/W SEC 1/4 SEC RIVER REACH ON REACH REACH MILES

(C419) (C421) (C423) (C425) (C427) (C429) (C431)

TREATMENT DATA

B2 SE ID TREATMENT ID TREATMENT OBJECTIVE TREATMENT PROCESS

(C401) (C481) (C483) (C485)

FRDS-II DATA ENTRY INSTRUCTIONS

DATA CAPTURE FORM C

SECTION C1 - GEOGRAPHIC AREAS SERVED

SECTION C1 - GEOGRAPHIC AREAS SERVED
(See Figure 17)

This section is used to enter data that identifies geographic areas or jurisdictions served by a public water system. All data elements within a single geographic areas served record should be valued with related data elements, which describe a single geographic area. For example, if city "X" is in county "A", they both should be specified in the same geographic areas served record. Conversely, if city "X" is outside of county "A", they each should be specified in a separate record. The FRDS-II Data Base has one geographic areas served record for each geographic area served that has been reported to EPA. The following data may be entered via this section:

GA ID
(C501)

Enter a GA ID that will uniquely identify a specific geographic area served.

Note: See Chapter VI, "Record Identification and Maximum Occurrences" for user assignment and automatic generation of this ID.

ADMIN REGION
(C503)

Enter the code value that represents the State administrative region, if any, that is being served by a public water system in whole or in part.

ADMIN DISTRICT
(C505)

Enter the code value that represents the State administrative district, if any, that is being served by a public water system in whole or in part.

FEDERAL CONGRESS DISTRICT
(C507)

Enter the code value that represents the Federal congressional district, that is being served by a public water system in whole or in part. When specified, FEDERAL CONGRESS DISTRICT must be a valid Federal congressional district code for the State as found in SECTION VI, Table 0507, in the Federal Reporting Data System Data Element Dictionary.

SECTION C1 - GEOGRAPHIC AREAS SERVED

STATE COUNTY CODE (C508)

Enter the State county code as applicable to the State. When specifying only the STATE COUNTY CODE, a one-for-one STATE COUNTY CODE to FIPS COUNTY CODE conversion table must be provided by the user.

FIPS COUNTY CODE (C509)

Enter the FIPS COUNTY CODE as applicable to the State. Valid FIPS COUNTY CODES may be found in SECTION VI, Table 0509 in the Federal Reporting Data System Data Element Dictionary.

When the primacy agent specifies only the STATE COUNTY CODE, the FRDS-II System will use the STATE COUNTY CODE to FIPS COUNTY CODE table for county code conversion and will store BOTH the STATE COUNTY CODE and FIPS COUNTY CODE in the FRDS-II Data Base. If the primacy agent specifies only the FIPS COUNTY CODE, ONLY the FIPS county code will be stored in the FRDS-II Data Base.

CITY (C513)

Enter the city, community, or jurisdiction that is being served by the public water system, in whole or in part.

INDIAN RESERVATION (C515)

Enter the code value that represents the Indian reservation or Alaska remote village, if any, being served by a public water system in whole or in part. When specified, this data element must be a valid Indian reservation or Alaska remote village code as defined in SECTION VI, Table ID01 in the Federal Reporting Data System Data Element Dictionary.

SECTION C1 - GEOGRAPHIC AREAS SERVED
DATA ELEMENT REGISTRATION TABLE

DATA ELEMENT NUM.	FORM REFERENCE NAME	A/N/D	JUST	SIN	ZERO FILL	REG. CODE	GRANT ELIG.	CBR
=====	=====	=====	=====	=====	=====	=====	=====	=====
C501	GA ID	N	L		Y	3		N
C503	ADMIN REGION	A	L	Y				Y
C505	ADMIN DISTRICT	A	L	Y				Y
C507	FEDERAL CONGRESS DISTRICT	A	L	Y	Y			Y
C508	STATE COUNTY CODE	A	L	Y			C	Y
C509	FIPS COUNTY CODE	A	L		Y		C	Y
C513	CITY	A	L	Y				Y
C515	INDIAN RESERVATION	A	L	Y	Y			Y

=====

LEGEND:

A/N/D	- A = ALPHANUMERIC, N = NUMERIC, D = DECIMAL
JUST	- L = LEFT JUSTIFY, R = RIGHT JUSTIFY, A = ALIGN
SIN	- Y = SKIP IF NONE OR NOT APPLICABLE
ZERO FILL	- Y = ENTER PRECEDING ZEROS OR ZERO FILL REMAINING DECIMAL PLACES
REG. CODE	- 1 = OPERATIONALLY REQUIRED 2 = PROGRAMMATICALLY REQUIRED 3 = OPERATIONALLY REQUIRED, CONDITIONALLY 4 = PROGRAMMATICALLY REQUIRED, CONDITIONALLY (SEE CHAPTER IV, "DATA BASE REGISTRATION REQUIREMENT", FOR FURTHER EXPLANATION)
GRANT ELIG.	- Y = DATA ELEMENT IS REQUIRED FOR A PWS TO BE CONSIDERED "GRANT ELIGIBLE" C = DATA ELEMENT IS CONDITIONALLY REQUIRED FOR A PWS TO BE CONSIDERED "GRANT ELIGIBLE"
CBR	- Y = CAN BE REMOVED (i.e., \$ IN LEFT-MOST POSITION) - N = CANNOT BE REMOVED

FRDS-II DATA ENTRY INSTRUCTIONS

DATA CAPTURE FORM C

SECTION C2 - SERVICE AREAS

SECTION C2 - SERVICE AREAS

(See Figure 17)

This section is used to enter data that characterizes the type of area served by the public water system. The FRDS-II Data Base has one record for each type of area served that is reported to EPA. Non-transient non-community and non-community water systems must have one, and only one, service area designated as primary. The following data may be entered via this section:

SERV ID (C601)

Enter a SERV ID that will uniquely identify a specific service area.

Note: See Chapter VI, "Record Identification and Maximum Occurrences" for user assignment and automatic generation of this ID.

TYPE/CAT (C603)

Enter the code value that characterizes the type of area serviced by the public water system. It is likely that a public water system will have several types of service areas, so the FRDS-II system will allow many repetitions of this record for each public water system in the data base. When specified, position 1 of the TYPE/CAT must be one of the following codes:

"R" (a residential area) or
"T" (a transient area) or
"S" (a semi-residential area) or
"O" (other than above)

and position 2 must be a valid service area sub-category code that is applicable to the major service area types as defined in SECTION VI, Table 0603 in the Federal Reporting Data System Data Element Dictionary.

PRIMARY SERVICE FLAG (C605)

Enter a "Y" if the service area is the primary (i.e., most prevalent) type of area served by the PWS. This data element must be valued for non-community and non-transient non-community public water systems. It is important to note that only one area served by a public water system can be designated as the primary type.

SECTION C2 - SERVICE AREAS
DATA ELEMENT REGISTRATION TABLE

DATA ELEMENT	1.	FORM REFERENCE NAME	A/N/D	JUST	SIN	FILL	CODE	ZERO REG.	GRANT ELIG.	CBR
	=====	=====	=====	=====	=====	=====	=====	=====	=====	=====
C601		SERV ID	N	L		Y	3			N
C603		TYPE/CAT	A	L					Y	Y
C605		PRIMARY SERVICE FLAG	A	N/A	Y				C*	Y

* Requires that each non-community or non-transient non-community public water system must identify one and only one of its service areas as primary.

=====

LEGEND:

A/N/D	- A = ALPHANUMERIC, N = NUMERIC, D = DECIMAL
JUST	- L = LEFT JUSTIFY, R = RIGHT JUSTIFY, A = ALIGN
SIN	- Y = SKIP IF NONE OR NOT APPLICABLE
ZERO FILL	- Y = ENTER PRECEDING ZEROS OR ZERO FILL REMAINING DECIMAL PLACES
REG. CODE	- 1 = OPERATIONALLY REQUIRED 2 = PROGRAMMATICALLY REQUIRED 3 = OPERATIONALLY REQUIRED, CONDITIONALLY 4 = PROGRAMMATICALLY REQUIRED, CONDITIONALLY (SEE CHAPTER IV, "DATA BASE REGISTRATION REQUIREMENT", FOR FURTHER EXPLANATION)
GRANT ELIG.	- Y = DATA ELEMENT IS REQUIRED FOR A PWS TO BE CONSIDERED "GRANT ELIGIBLE" C = DATA ELEMENT IS CONDITIONALLY REQUIRED FOR A PWS TO BE CONSIDERED "GRANT ELIGIBLE"
CBR	- Y = CAN BE REMOVED (i.e., \$ IN LEFT-MOST POSITION) - N = CANNOT BE REMOVED

FRDS-II DATA ENTRY INSTRUCTIONS

DATA CAPTURE FORM C

SECTION C3 - ON-SITE VISITS

SECTION C3 - ON-SITE VISITS
(See Figure 17)

This section is used to enter data that is related to on-site visits made to a public water system. The FRDS-II Data Base has one on-site visit record for each on-site visit (such as a sanitary survey), that has been reported to EPA. The following data may be entered via this section:

VISIT ID
(C701)

VISIT ID will ALWAYS be generated by the FRDS-II Computer System.

Note: See Chapter VI, "Record Identification and Maximum Occurances".

VISIT DATE (MO, DAY, & YR)
(C703)

Enter the calendar date on which a visit was made to a public water system. When specified, VISIT DATE must be a valid calendar date and must be in the form "MMDDYY" where:

MM = Calendar Month
DD = Calendar Day
YY = Calendar Year

VISIT REASON
(C705)

Enter the code value that represents the reason that a visit was made to a public water system. When specified, enter the appropriate code into position 1 of the VISIT REASON as follows:

"1" = Class I Survey (i.e., sanitary survey)
"2" = Class II Survey (i.e., other than a sanitary survey)

Position 2 is valid for Class II surveys. See SECTION VI, Table 0705 in the Federal Reporting Data System Data Element Dictionary for valid on-site visit reason codes. Position 2 must be blank if a Class I Survey is specified.

SECTION C3 - ON-SITE VISITS
DATA ELEMENT REGISTRATION TABLE

DATA ELEMENT NM.	FORM REFERENCE NAME	A/N/D	JUST	SIN	ZERO FILL	REG. CODE	GRANT ELIG.	CBR
=====	=====	=====	=====	=====	=====	=====	=====	=====
C701	VISIT ID	N	L		Y	3		N
C703	VISIT DATE	N	L		Y			Y
C705	VISIT REASON	A	L					Y

=====

LEGEND:

A/N/D	-	A = ALPHANUMERIC, N = NUMERIC, D = DECIMAL
JUST	-	L = LEFT JUSTIFY, R = RIGHT JUSTIFY, A = ALIGN
SIN	-	Y = SKIP IF NONE OR NOT APPLICABLE
ZERO FILL	-	Y = ENTER PRECEDING ZEROS OR ZERO FILL REMAINING DECIMAL PLACES
REG. CODE	-	1 = OPERATIONALLY REQUIRED 2 = PROGRAMMATICALLY REQUIRED 3 = OPERATIONALLY REQUIRED, CONDITIONALLY 4 = PROGRAMMATICALLY REQUIRED, CONDITIONALLY (SEE CHAPTER IV, "DATA BASE REGISTRATION REQUIREMENT", FOR FURTHER EXPLANATION)
GRANT ELIG.	-	Y = DATA ELEMENT IS REQUIRED FOR A PWS TO BE CONSIDERED "GRANT ELIGIBLE" C = DATA ELEMENT IS CONDITIONALLY REQUIRED FOR A PWS TO BE CONSIDERED "GRANT ELIGIBLE"
CBR	-	Y = CAN BE REMOVED (i.e., \$ IN LEFT-MOST POSITION) N = CANNOT BE REMOVED



Public Water System Data Capture Form C

U.S. ENVIRONMENTAL
PROTECTION AGENCY

PWS ID

ACTION CODE

BATCH DATE

State

ID Number

MO

DAY

YR

(C101)

I - Insert M - Modify

C1

GEOGRAPHIC AREAS SERVED

GA ID	ADMIN REGION	ADMIN DISTRICT	FEDERAL CONGRESS DISTRICT	STATE COUNTY	FIPS COUNTY	CITY	INDIAN RESERVATION

(C301) (C303) (C305) (C307) (C308) (C309) (C313) (C315)

C2

SERVICE AREAS

SERV ID	TYPE / CAT	PRIMARY SERVICE FLAG

(C601) (C603) (C605)

C3

ON-SITE VISITS

VISIT ID	VISIT DATE MO DAY YR	VISIT REASON

(C701) (C703) (C705)

FRDS-II DATA ENTRY INSTRUCTIONS

DATA CAPTURE FORM D

SECTION D1 - VIOLATION DATA

SECTION D1 - VIOLATION DATA
(See Figure 18)

This section is used to enter data that characterizes a violation of a primary drinking water regulation issued to a public water system by a State or Federal agency. The FRDS-II Data Base has one violation record for each violation that has been reported to EPA. The following data may be entered via this section:

VIOLATION ID (FY & ID NUMBER)
(C1101)

Enter a VIOLATION ID that will uniquely identify a specific violation of a primary drinking water regulation issued to a public water system, by a State or Federal agency under the following rules:

Positions 1 - 2 contain the Federal fiscal year (FY) in which the violation was issued by the State or Federal agency. Federal fiscal year must always be specified, must always be greater than 77, must always be equal to or less than the current Federal fiscal year, and must always be numeric.

Positions 3 - 7 contain an ID NUMBER that must be unique for the PWS for the Federal fiscal year.

Note: See Chapter VI, "Record Identification and Maximum Occurrences" for user assignment and automatic generation of this ID.

CONTAMINANT
(C1103)

Enter the code value that represents the identification number of a contaminant for which a public water system was issued a violation of a primary drinking water regulation. CONTAMINANT is required when VIOLATION TYPE (C1105) is equal to 01, 02, 03, or 04.

CONTAMINANT must be a valid contaminant code or a valid contaminant group code as found in SECTION VI, Table ID06, in the Federal Reporting Data System Data Element Dictionary.

CONTAMINANT cannot be valued for violations other than MCL or monitoring violations.

VIOLATION TYPE
(C1105)

Enter the code value that represents the type of violation that was issued to a public water system. VIOLATION TYPE must be a valid violation type code as found in SECTION VI, Table ID08 in the Federal Reporting Data System Data Element Dictionary. VIOLATION TYPE is required for each violation reported.

SECTION D1 - VIOLATION DATA

COMPLIANCE PERIOD BEGIN (MO, DAY, & YR)
(C1107)

Enter the calendar date of the beginning of the compliance period for which the public water system was in violation of a primary drinking water regulation. COMPLIANCE PERIOD BEGIN is required for all violations.

COMPLIANCE PERIOD END (MO, DAY, & YR)
(C1109)

Enter the calendar date of the end of a compliance period in which a public water system was in violation of a primary drinking water regulation. COMPLIANCE PERIOD END is required when inserting a violation record, when COMPLIANCE PERIOD DURATION is not specified.

COMPLIANCE PERIOD DURATION
(C1111)

Enter the number of calendar months of the compliance period during which a public water system was in violation of a primary drinking regulation. COMPLIANCE PERIOD DURATION is required when inserting a violation record and when COMPLIANCE PERIOD END is not specified. This data element should not be input when COMPLIANCE PERIOD END is specified.

AWARENESS DATE (MO, DAY, & YR)
(C1115)

Enter the calendar date that the primacy agent became aware of this violation.

NUM SAMPLES REQUIRED
(C1127)

Enter the number of samples for monitoring and reporting violations that were required to be collected, analyzed, and reported by a public water system for a specific compliance period. If not a monitoring or reporting violation, do not provide this data.

SE ID
(C1143)

Enter the SE ID of the source, plant or entity for which, the violation was entered.

SECTION D1 - VIOLATION DATA

NUM SAMPLES TAKEN
(C1129)

Enter the number of samples for monitoring and reporting violations that were actually collected, analyzed, and reported by a public water system for a specific compliance period. If not a monitoring or reporting violation, do not provide this data.

MAJOR VIOLATION
(C1131)

Enter a "Y" if a major monitoring or reporting violation. A major violation is one where no samples were taken during a compliance period.

Enter an "N" if a minor violation.

If not a monitoring or reporting violation, leave blank. MAJOR VIOLATION does not apply to check sampling violations.

ANALYSIS METHOD
(C1121)

Enter the code value that represents the analysis method used to obtain an analytical result which led to the issuance of the MCL violation for a public water system. ANALYSIS METHOD must not be specified for monitoring and reporting violations. When specified, this data element must be a valid analysis method code as described in SECTION VI, Table 1121, in the Federal Reporting Data System Data Element Dictionary.

SECTION D1 - VIOLATION DATA

ANALYSIS RESULT (C1123)

Enter the numeric value that represents the result obtained from a single analysis, or the average result obtained from multiple analyses, that led to the issuance of the MCL violation for a public water system. ANALYSIS RESULT is required for inserting a violation record for MCL violations of other than BACTI or turbidity. When specified, ANALYSIS RESULT must be entered under the following rules:

- o Must be specified for MCL violations, other than BACTI or turbidity.
- o The integer portion cannot exceed 7 positions
- o The decimal portion cannot exceed 8 positions
- o Must be numeric
- o Must be greater than or equal to zero

The rules for entering decimal numbers into the FRDS-II System, are discussed in Chapter VII, "GENERAL CODING INSTRUCTIONS."

MCL VIOLATED (C1125)

Enter the numeric value that represents the maximum contaminant level which was exceeded that led to the issuance of an MCL violation for a public water system. MCL VIOLATED is required for inserting a violation record only if the primacy agent has a different MCL than in the Federal regulations. When specified, MCL VIOLATED must be entered under the following rules:

- o Must be specified for MCL violations, other than BACTI or turbidity.
- o The integer portion cannot exceed 7 positions
- o The decimal portion cannot exceed 8 positions
- o Must be numeric
- o Must be greater than or equal to zero

The rules for entering decimal numbers into the FRDS-II System, are discussed in Chapter VII, "GENERAL CODING INSTRUCTIONS."

SECTION D1 - VIOLATION DATA
DATA ELEMENT REGISTRATION TABLE

DATA
ELEMENT
M.

FORM REFERENCE NAME

A/N/D JUST

SIN

ZERO REG. GRANT

FILL CODE

ELIG.

CBR

====

DATA ELEMENT M.	FORM REFERENCE NAME	A/N/D	JUST	SIN	ZERO FILL	REG. CODE	GRANT ELIG.	CBR
C1101	VIOLATION ID	A	L		Y	3		N
C1103	CONTAMINANT	A	L	Y		4		Y
C1105	VIOLATION TYPE	A	L			2		N
C1107	COMPLIANCE PERIOD BEGIN	N	L		Y	2		N
C1109	COMPLIANCE PERIOD END	N	L		Y	4		Y
C1111	COMPLIANCE PERIOD DURATION	N	L			4		Y
C1143	SE ID	N	L		Y			Y
C1115	AWARENESS DATE	N	L		Y	4		Y
C1127	NUM SAMPLES REQUIRED	N	L	Y				Y
C1129	NUM SAMPLES TAKEN	N	L	Y		4		Y
C1131	MAJOR VIOLATION	A	N/A	Y		4		Y
C1121	ANALYSIS METHOD	A	L	Y				Y
C1123	ANALYSIS RESULT	D	A	Y		4		Y
C1125	MCL VIOLATED	D	A	Y		4		Y

LEGEND:

A/N/D - A = ALPHANUMERIC, N = NUMERIC, D = DECIMAL
 JUST - L = LEFT JUSTIFY, R = RIGHT JUSTIFY, A = ALIGN
 SIN - Y = SKIP IF NONE OR NOT APPLICABLE
 ZERO FILL - Y = ENTER PRECEDING ZEROS OR ZERO FILL
 REMAINING DECIMAL PLACES
 REG. CODE - 1 = OPERATIONALLY REQUIRED
 2 = PROGRAMMATICALLY REQUIRED
 3 = OPERATIONALLY REQUIRED, CONDITIONALLY
 4 = PROGRAMMATICALLY REQUIRED, CONDITIONALLY
 (SEE CHAPTER IV, "DATA BASE REGISTRATION
 REQUIREMENT", FOR FURTHER EXPLANATION)
 GRANT ELIG. - Y = DATA ELEMENT IS REQUIRED FOR A PWS TO BE
 CONSIDERED "GRANT ELIGIBLE"
 C = DATA ELEMENT IS CONDITIONALLY REQUIRED FOR A
 PWS TO BE CONSIDERED "GRANT ELIGIBLE"
 CBR - Y = CAN BE REMOVED (i.e., \$ IN LEFT-MOST POSITION)
 - N = CANNOT BE REMOVED



Public Water System Data Capture Form D

U.S. ENVIRONMENTAL
PROTECTION AGENCY

PWS ID

ACTION CODE

BATCH DATE

State

ID Number

I = Insert M = Modify

MO

DAY

YR

(C101)

D1

VIOLATION DATA

VIOLATION ID
FY ID NUMBER
(C1101)

CONTAMINANT
(C1103)

VIOLATION
TYPE
(C1105)

COMPLIANCE PERIOD BEGIN
MO DAY YR
(C1107)

COMPLIANCE PERIOD END
MO DAY YR
(C1109)

OR

COMPLIANCE PERIOD
DURATION
(C1111)

SE ID
(C1143)

AWARENESS DATE
MO DAY YR
(C1115)

MONITORING AND REPORTING VIOLATIONS		
NUM SAMPLES REQUIRED (C1127)	NUM SAMPLES TAKEN (C1129)	MAJOR VIOLATION (C1131) Y = YES N = NO

OR

MAXIMUM CONTAMINANT LEVEL VIOLATIONS

ANALYSIS METHOD (C1121)	ANALYSIS RESULT (C1123)	MCL VIOLATED (C1125)

D1

VIOLATION DATA

VIOLATION ID
FY ID NUMBER
(C1101)

CONTAMINANT
(C1103)

VIOLATION
TYPE
(C1105)

COMPLIANCE PERIOD BEGIN
MO DAY YR
(C1107)

COMPLIANCE PERIOD END
MO DAY YR
(C1109)

OR

COMPLIANCE PERIOD
DURATION
(C1111)

SE ID
(C1143)

AWARENESS DATE
MO DAY YR
(C1115)

MONITORING AND REPORTING VIOLATIONS		
NUM SAMPLES REQUIRED (C1127)	NUM SAMPLES TAKEN (C1129)	MAJOR VIOLATION (C1131) Y = YES N = NO

OR

MAXIMUM CONTAMINANT LEVEL VIOLATIONS

ANALYSIS METHOD (C1121)	ANALYSIS RESULT (C1123)	MCL VIOLATED (C1125)

FRDS-II DATA ENTRY INSTRUCTIONS

DATA CAPTURE FORM E

SECTION E1 - ENFORCEMENT DATA

SECTION E1 - ENFORCEMENT DATA
(See Figure 19)

This section is used to enter data that characterizes an enforcement action taken against a public water system by a State or Federal agency. The FRDS-II Data Base has one enforcement record for each enforcement action that has been reported to EPA. The following data may be entered via this section:

ENFORCEMENT ID (FY & ID NUMBER)
(C1201)

Enter an ENFORCEMENT ID that will uniquely identify a specific enforcement action taken by a State or Federal agency against a public water system.

Positions 1 - 2 contain the Federal fiscal year (FY) in which the enforcement action was issued. Fiscal year must always be specified, must always be greater than 77, must always be equal to or less than the current Federal fiscal year and must always be numeric.

Positions 3 - 7 contain an ID NUMBER, which must be unique for each enforcement action for the PWS for the Federal fiscal year.

Note: See Chapter VI, "Record Identification and Maximum Occurrences" for user assignment and automatic generation of this ID.

FOLLOW-UP ACTION
(C1205)

Enter the code value that represents the enforcement action that was taken by a State or Federal agency against a public water system. When specified, position 1 must be one of the following codes:

"F" = formal action
"I" = informal action
"E" = administrative order issued by EPA (For EPA use only.)
"O" = other than above

When specified, positions 2 - 3 must be a valid enforcement follow-up sub-category code that is applicable to the major follow-up action types. These may be found in SECTION VI, Table ID09, in the Federal Reporting Data System Data Element Dictionary. Position 3 is reserved for future use.

ENFORCEMENT DATE (MO, DAY, & YR)
(C1203)

Enter the calendar date on which an enforcement action was taken by a State or Federal agency against a public water system.

SECTION E1 - ENFORCEMENT DATA

When inserting an enforcement record into the FRDS-II Data Base, it should be related to a violation record or records. Three methods have been provided to the user to relate enforcement actions to violation records. The three methods are (1) ASSOCIATED VIOLATION RANGE (X5000); (2) ASSOCIATED VIOLATION IDS (Y5000); and (3) ASSOCIATED VIOLATION CONTAMINANT GROUPS (Z5000). When relating an enforcement record to a violation record, the FRDS-II System builds a "Link Record" to the violation record specified by the user, through the use of one or more of the aforementioned methods. The rules for entering violation data for any of these methods may be found in the instructions for DATA CAPTURE FORM D (VIOLATION DATA).

When updating enforcement actions, the "M" (Modify) action code would normally be used to modify the following data elements:

C1203 - ENF-ACTION-DATE
C1205 - ENF-FOLLOW-UP-ACTION

However, the "Modify" action code can also be used to establish additional Violation "Link Records." Once an enforcement record has been posted to the FRDS-II Data Base, the user may use the "Modify" action code to establish additional "Link Records" to specified violation records. So, the user may link enforcements to violation records two ways: (1) When adding an enforcement record to the FRDS-II Data Base by the use of an "Insert" transaction (Action code of "I"); or (2) By modifying an existing enforcement record in the FRDS-II Data Base by the use of a "Modify" transaction (Action code of "M").

If an enforcement action is applied erroneously to certain violation records, it can only be corrected by first deleting the enforcement action (with an action code of "D") and re-inserting (with an action code of "I") the enforcement action with the proper violations identified by the X5000, Y5000 or Z5000 update methods. It is important for the user to realize that when an enforcement action is deleted from the FRDS-II Data Base, ALL links to violations for that enforcement are also deleted.

ASSOCIATED VIOLATION RANGE (BEGIN (MO, DAY & YR)
(X5000) and END (MO, DAY & YR))

Enter the beginning and ending dates that represent the violations that occurred within a specific time period, to which the enforcement actions are to be applied. If either the beginning date or the ending date for the violation record compliance period falls within the range of dates specified, the enforcement action will be applied to that violation. If the end date in the ASSOCIATED VIOLATION RANGE is left blank, then the ENFORCEMENT DATE (C1203) will be used as the end date in the ASSOCIATED VIOLATION RANGE. In all cases, the beginning and ending dates in the ASSOCIATED VIOLATION RANGE must be equal to or less than the ENFORCEMENT DATE (C1203).

SECTION E1 - ENFORCEMENT DATA

ASSOCIATED VIOLATION RANGE (CONT.) (X5000)

For example, if a violation record had a compliance period begin date of 06/15/87 and a compliance period end date of 07/15/87, the following ASSOCIATED VIOLATION RANGES would cause an enforcement action to be applied:

- o BEGIN 05/15/87 - END 06/15/87 (Compliance period begin date in violation falls within the specified range)
- o BEGIN 07/15/87 - END 08/15/87 (Compliance period end date in violation falls within the specified range)

Only a single ASSOCIATED VIOLATION RANGE will be accepted in the same update for a given enforcement action.

If the beginning or ending date in the violation record does not match the range of dates specified, a link will not be established to the violation. However, the enforcement action will be accepted.

ASSOCIATED VIOLATION IDS (FY & ID NUMBER) (Y5000)

Enter the specific violation ID(s) to which the enforcement action is related. When the enforcement action is posted to the data base, a link will be established between the enforcement record and each violation record specified by the violation ID. When a specified violation ID is not found in the data base, the link will not be established; however, the enforcement action will be accepted.

If the user wishes to enter more ASSOCIATED VIOLATION IDS than are provided on the form for the same enforcement action, an additional form or forms may be used. Except for the ASSOCIATED VIOLATION ID data, all other information on the form (i.e., PWS ID, ACTION CODE, BATCH DATE, ENFORCEMENT ID, FOLLOW-UP ACTION, and ENFORCEMENT DATE) would be the same.

SECTION E1 - ENFORCEMENT DATA

ASSOCIATED VIOLATION CONTAMINANT GROUPS (TYPE, CONTAMINANT,
(Z5000) COMPLIANCE PERIOD BEGIN
DATE (MO, DAY & YR))

Enter the ASSOCIATED CONTAMINANT GROUP data, which consists of Violation Type, Contaminant Code and Compliance Period Begin Date, of violations that relate to this enforcement. If the violation record data exactly matches the specified ASSOCIATED CONTAMINANT GROUP, a link will be established between the enforcement record and the violation record. If an exact match does not take place, no link will be established, however, the enforcement action will be accepted.

If the user wishes to enter more ASSOCIATED VIOLATION CONTAMINANT GROUPS than are provided on the form for the same enforcement action, an additional form or forms may be used. Except for the ASSOCIATED VIOLATION CONTAMINANT GROUPS, all other information on the form (i.e., PWS ID, ACTION CODE, BATCH DATE, ENFORCEMENT ID, FOLLOW-UP ACTION, and ENFORCEMENT DATE) would be the same.

NOTE: See Chapter II - "Data Transfer File" for further information on X5000, Y5000, and Z5000 enforcement processing.

SECTION E1 - ENFORCEMENT DATA
DATA ELEMENT REGISTRATION TABLE

DATA ELEMENT NM.	FORM REFERENCE NAME	A/N/D	JUST	SIN	ZERO FILL	REG. CODE	GRANT ELIG.	CBR
=====	=====	=====	=====	=====	=====	=====	=====	=====
C1201	ENFORCEMENT ID	A	L			3		N
C1203	ENFORCEMENT DATE	N	L		Y	2		N
C1205	FOLLOW-UP ACTION	A	L			2		N

=====

LEGEND:

A/N/D	- A = ALPHANUMERIC, N = NUMERIC, D = DECIMAL
JUST	- L = LEFT JUSTIFY, R = RIGHT JUSTIFY, A = ALIGN
SIN	- Y = SKIP IF NONE OR NOT APPLICABLE
ZERO FILL	- Y = ENTER PRECEDING ZEROS OR ZERO FILL REMAINING DECIMAL PLACES
REG. CODE	- 1 = OPERATIONALLY REQUIRED 2 = PROGRAMMATICALLY REQUIRED 3 = OPERATIONALLY REQUIRED, CONDITIONALLY 4 = PROGRAMMATICALLY REQUIRED, CONDITIONALLY (SEE CHAPTER IV, "DATA BASE REGISTRATION REQUIREMENT", FOR FURTHER EXPLANATION)
GRANT ELIG.	- Y = DATA ELEMENT IS REQUIRED FOR A PWS TO BE CONSIDERED "GRANT ELIGIBLE" C = DATA ELEMENT IS CONDITIONALLY REQUIRED FOR A PWS TO BE CONSIDERED "GRANT ELIGIBLE"
CBR	- Y = CAN BE REMOVED (i.e., \$ IN LEFT-MOST POSITION) - N = CANNOT BE REMOVED



U.S. ENVIRONMENTAL
PROTECTION AGENCY

Public Water System Data Capture Form E

PWS ID

ACTION CODE

BATCH DATE

State ID Number
(C101)

I - Insert M - Modify

MO DAY YR

ENFORCEMENT DATA

E1

ENFORCEMENT ID
FY ID NUMBER
(C1201)

FOLLOW-UP
ACTION
(C1205)

ENFORCEMENT DATE
MO DAY YR
(C1203)

+

ASSOCIATED VIOLATION RANGE
BEGIN END
MO DAY YR MO DAY YR
(X5000)

OR

ASSOCIATED VIOLATION IDS

VIOLATION ID 1 VIOLATION ID 2 VIOLATION ID 3 VIOLATION ID 4
FY ID NUMBER FY ID NUMBER FY ID NUMBER FY ID NUMBER
(Y5000)

OR

ASSOCIATED VIOLATION CONTAMINANT GROUPS

COMPLIANCE PERIOD COMPLIANCE PERIOD COMPLIANCE PERIOD
BEGIN DATE BEGIN DATE BEGIN DATE
TYPE CONTAMINANT MO DAY YR TYPE CONTAMINANT MO DAY YR TYPE CONTAMINANT MO DAY YR
(Z5000)

ENFORCEMENT DATA

E1

ENFORCEMENT ID
FY ID NUMBER
(C1201)

FOLLOW-UP
ACTION
(C1205)

ENFORCEMENT DATE
MO DAY YR
(C1203)

+

ASSOCIATED VIOLATION RANGE
BEGIN END
MO DAY YR MO DAY YR
(X5000)

OR

ASSOCIATED VIOLATION IDS

VIOLATION ID 1 VIOLATION ID 2 VIOLATION ID 3 VIOLATION ID 4
FY ID NUMBER FY ID NUMBER FY ID NUMBER FY ID NUMBER
(Y5000)

OR

ASSOCIATED VIOLATION CONTAMINANT GROUPS

COMPLIANCE PERIOD COMPLIANCE PERIOD COMPLIANCE PERIOD
BEGIN DATE BEGIN DATE BEGIN DATE
TYPE CONTAMINANT MO DAY YR TYPE CONTAMINANT MO DAY YR TYPE CONTAMINANT MO DAY YR
(Z5000)

FRDS-II DATA ENTRY INSTRUCTIONS

DATA CAPTURE FORM F

SECTION F1 - VARIANCES, EXEMPTIONS & OTHER RELATED DATA

SECTION F1 - VARIANCES, EXEMPTIONS & OTHER RELATED DATA
(See Figure 20)

This section is used to enter data that characterizes a variance or exemption that is pending for, or has been granted to, a public water system. The FRDS-II Data Base has one variance or exemption record for each variance or exemption that has been reported to EPA. The following data may be entered via this section:

VE ID (FY & ID NUMBER)
(C3001)

Enter a VE ID that will uniquely identify a specific variance or exemption that is pending for, or that has been granted to, a public water system by a primacy agent under the following rules.

Positions 1 - 2 contain the fiscal year (FY) in which the variance or exemption was reported to EPA. When adding, deleting or modifying a variance or exemption record, fiscal year must always be specified, must always be equal to or less than the current fiscal year, must be numeric, and cannot be less than 78.

Note: See Chapter VI, "Record Identification" for user assignment and automatic generation of this ID.

CONTAMINANT
(C3003)

Enter the code value that represents a contaminant for which a variance or exemption is pending, or that has been granted to, a public water system by a primacy agent. This data element must be a valid contaminant code or a valid contaminant group code as found in SECTION VI, Table ID06, in the Federal Reporting Data System Data Element Dictionary.

RECORD TYPE
(C3005)

Enter the code value that represents whether this is a variance, exemption, turbidity waiver, filtration exclusion, or other record. Valid RECORD TYPE codes may be found in SECTION VI, Table 3005, in the Federal Reporting Data System (FRDS-II) Data Element Dictionary.

EFFECTIVE DATE (MO, DAY, & YR)
(C3007)

Enter the calendar date on which the variance or exemption that has been granted to a public water system by a primacy agent became, or will become, effective. When specified, EFFECTIVE DATE must be less than C3009, EXPIRATION DATE.

SECTION F1 - VARIANCES, EXEMPTIONS & OTHER RELATED DATA

EXPIRATION DATE (MO, DAY, & YR)
(C3009)

Enter the calendar date on which a variance or exemption that was granted to a public water system expired, or will expire. When specified, EXPIRATION DATE must be after the EFFECTIVE DATE.

STATUS CODE
(C3011)

Enter the code value that describes the current status of a variance or exemption that is pending for, or has been granted to, a public water system by a primacy agent. When specified, STATUS CODE must be a valid variance or exemption status code as described in SECTION VI, Table 3011 in the Federal Reporting Data System Data Element Dictionary.

MODIFIED MCL
(C3013)

Enter the numeric value that represents the modified maximum contaminant level that has been approved as a condition to a variance or an exemption granted to a public water system by a primacy agent.

When specified, MODIFIED MCL must be entered under the following rules:

- o The integer portion cannot exceed 7 positions
- o The decimal portion cannot exceed 8 positions
- o Must be numeric
- o Must be greater than or equal to zero
- o A decimal point may or may not appear
- o A decimal point must be specified if a fractional amount is intended.

TREATMENT PROCESS
(C3015)

Enter the code value that represents the treatment process for which a variance or exemption is being granted to a public water system by a primacy agent. When specified, this TREATMENT PROCESS must be a valid treatment process code as described in SECTION VI, Table ID04, in the Federal Reporting Data System Data Element Dictionary.

SECTION F1 - VARIANCES, EXEMPTIONS & OTHER RELATED DATA

ALTERNATE PROCESS
(C3017)

Enter the code value that represents the alternate process for which a variance or exemption is being granted to a public water system by a primacy agent. When specified, this data element must be a valid treatment process code as described in SECTION VI, Table ID04, in the Federal Reporting Data System Data Element Dictionary.

REASON
(C3019)

Enter the code value that represents the reason for which a variance or exemption has been granted to a public water system by a primacy agent. When specified, this data element must be a valid reason code as described in SECTION VI, Table 3019, in the Federal Reporting Data System Data Element Dictionary.

SECTION F1 - VARIANCES, EXEMPTIONS & OTHER RELATED DATA
DATA ELEMENT REGISTRATION TABLE

DATA ELEMENT NUM.	FORM REFERENCE NAME	A/N/D	JUST	SIN	ZERO FILL	REG. CODE	GRANT ELIG.	CBR
=====	=====	=====	=====	=====	=====	=====	=====	=====
C3001	VE ID	A	L		Y	3		N
C3003	CONTAMINANT	A	L			2		N
C3005	RECORD TYPE	A	L			2		N
C3007	EFFECTIVE DATE	N	L		Y	4		Y
C3009	EXPIRATION DATE	N	L		Y	4		Y
C3011	STATUS CODE	A	N/A			2		N
C3013	MODIFIED MCL	D	A	Y	Y	4		Y
C3015	TREATMENT PROCESS	N	L	Y				Y
C3017	ALTERNATE PROCESS	N	L	Y		4		Y
C3019	REASON	N	L	Y				Y

=====

LEGEND:

A/N/D	- A = ALPHANUMERIC, N = NUMERIC, D = DECIMAL
JUST	- L = LEFT JUSTIFY, R = RIGHT JUSTIFY, A = ALIGN
SIN	- Y = SKIP IF NONE OR NOT APPLICABLE
ZERO FILL	- Y = ENTER PRECEDING ZEROS OR ZERO FILL REMAINING DECIMAL PLACES
REG. CODE	- 1 = OPERATIONALLY REQUIRED 2 = PROGRAMMATICALLY REQUIRED 3 = OPERATIONALLY REQUIRED, CONDITIONALLY 4 = PROGRAMMATICALLY REQUIRED, CONDITIONALLY (SEE CHAPTER IV, "DATA BASE REGISTRATION REQUIREMENT", FOR FURTHER EXPLANATION)
GRANT ELIG.	- Y = DATA ELEMENT IS REQUIRED FOR A PWS TO BE CONSIDERED "GRANT ELIGIBLE" C = DATA ELEMENT IS CONDITIONALLY REQUIRED FOR A PWS TO BE CONSIDERED "GRANT ELIGIBLE"
CBR	- Y = CAN BE REMOVED (i.e., \$ IN LEFT-MOST POSITION) - N = CANNOT BE REMOVED

FRDS-II DATA ENTRY INSTRUCTIONS

DATA CAPTURE FORM F

SECTION F2 - VE SCHEDULE

SECTION F2 - VE SCHEDULE
(See Figure 20)

This section is used to enter data that characterizes a schedule of events and/or actions that are related to a variance or exemption that is pending for, or has been granted to, a public water system. The FRDS-II Data Base has one schedule record for each event or action which is related to a variance or exemption that has been reported to EPA. The following data may be entered via this form:

VE ID (FY & ID NUMBER)
(C3001)

Enter the VE ID for the variance or exemption record to which the VE SCHEDULE will be applied. This data element is required. A VE SCHEDULE record cannot be added to the FRDS-II Data Base unless a variance or exemption record to which it can be applied already exists.

Note: See Chapter VI, "Record Identification" for user assignment and automatic generation of this ID.

SCHEDULE ID
(C3101)

Enter a numeric value that will uniquely identify a specific event or action that is related to a variance or exemption that is pending for, or has been granted to, a public water system.

Note: See Chapter VI, "Record Identification" for user assignment and automatic generation of this ID.

ACTION
(C3103)

Enter the code value that represents an event or action that is to be taken by the State (or was taken by the State) relating to a variance or an exemption that is pending for, or has been granted to, a public water system. This data element is required when modifying the current value. When specified, ACTION must be a valid variance or exemption schedule action as described in SECTION VI, Table 3103, in the Federal Reporting Data System Data Element Dictionary.

SECTION F2 - VE SCHEDULE

SCHEDULED DATE (MO, DAY, & YR)
(C3105)

Enter the calendar date on which an event or action relating to a variance or an exemption that is pending for, or has been granted to, a public water system is scheduled (or was scheduled) to occur.

ACCOMPLISHED DATE (MO, DAY, & YR)
(C3107)

Enter the calendar date on which an event or action relating to a variance or an exemption that is pending for, or has been granted to, a public water system WAS accomplished, if completed.

SECTION F2 - VE SCHEDULE
DATA ELEMENT REGISTRATION TABLE

DATA ELEMENT NM.	FORM REFERENCE NAME	A/N/D	JUST	SIN	ZERO FILL	REG. CODE	GRANT ELIG.	CBR
=====	=====	=====	=====	=====	=====	=====	=====	=====
C3001	VE ID	A	L		Y	3		N
C3101	SCHEDULE ID	N	L		Y	3		N
C3103	ACTION	A	L	Y				Y
C3105	SCHEDULED DATE	N	L	Y	Y			Y
C3107	ACCOMPLISHED DATE	N	L	Y	Y			Y

=====

LEGEND:

A/N/D	- A = ALPHANUMERIC, N = NUMERIC, D = DECIMAL
JUST	- L = LEFT JUSTIFY, R = RIGHT JUSTIFY, A = ALIGN
SIN	- Y = SKIP IF NONE OR NOT APPLICABLE
ZERO FILL	- Y = ENTER PRECEDING ZEROS OR ZERO FILL REMAINING DECIMAL PLACES
REG. CODE	- 1 = OPERATIONALLY REQUIRED 2 = PROGRAMMATICALLY REQUIRED 3 = OPERATIONALLY REQUIRED, CONDITIONALLY 4 = PROGRAMMATICALLY REQUIRED, CONDITIONALLY (SEE CHAPTER IV, "DATA BASE REGISTRATION REQUIREMENT", FOR FURTHER EXPLANATION)
GRANT ELIG.	- Y = DATA ELEMENT IS REQUIRED FOR A PWS TO BE CONSIDERED "GRANT ELIGIBLE" C = DATA ELEMENT IS CONDITIONALLY REQUIRED FOR A PWS TO BE CONSIDERED "GRANT ELIGIBLE"
CBR	- Y = CAN BE REMOVED (i.e., \$ IN LEFT-MOST POSITION) - N = CANNOT BE REMOVED



BATCH DATE

MO	DAY	YR
1	1	1

F1

EXPIRATION DATE
MO DAY YR
(C3009)

REASON

(C3019)

F2

VE SCHEDULE

ACCOMPLISHED DATE

MO	DAY	YR
1	1	1
2	2	2
3	3	3
4	4	4

(C3107)

F1

VARIANCES, EXEMPTIONS & OTHER RELATED DATA

EXPIRATION DATE
MO DAY YR
(C-3009)

REASON

(C3019)

F2

VE SCHEDULE

ACCOMPLISHED DATE

MO	DAY	YR

(C3107)

FRDS-II DATA ENTRY INSTRUCTIONS

DATA CAPTURE FORM G

SECTION G1 - STATE DISCRETIONARY DATA

SECTION G1 - STATE DISCRETIONARY DATA
(See Figure 21)

This section is used to enter data that characterizes a specific set of values defined at the discretion of the State. The FRDS-II Data Base has one discretionary record for each single set of State specific data values that has been reported to EPA for a public water system. The following data may be entered via this section:

SDD ID
(C4001)

Enter a numeric value that will uniquely identify a specific State discretionary data item applicable to a public water system.

STATE DISCRETIONARY DATA NAME
(C4003)

Enter the alphanumeric value that describes the data entered in the other data elements in the STATE DISCRETIONARY RECORD, For example, "Sanitary Engineer" or "Wholesale Population".

STATE DISCRETIONARY VALUE
(C4005)

The user may enter any alphanumeric value desired in STATE DISCRETIONARY VALUE. For example, the sanitary engineer, "John Jones".

STATE DISCRETIONARY QUANTITY
(C4007)

The user may enter any numeric value desired in STATE DISCRETIONARY QUANTITY under the following rules:

When specified...

- o The integer portion cannot exceed 7 positions
- o The decimal portion cannot exceed 8 positions
- o Must be numeric
- o A decimal point may or may not appear
- o A decimal point must be specified if a fractional amount is intended

For example, the wholesale population quantity could be entered here.

DATE (MO, DAY, & YR)
(C4009)

The user may enter any valid date desired. However, the year portion of the date must be greater than 77.

SECTION G1 - STATE DISCRETIONARY DATA
DATA ELEMENT REGISTRATION TABLE

DATA ELEMENT NUM.	FORM REFERENCE NAME	A/N/D	JUST	SIN	ZERO FILL	REG. CODE	GRANT ELIG.	CBR
C4001	SDD ID	N	L		Y	3		N
C4003	STATE DISCRETIONARY DATA NAME	A	L					Y
C4005	STATE DISCRETIONARY VALUE	A	L	Y				Y
C4007	STATE DISCRETIONARY QUANTITY	D	A	Y	Y			Y
C4009	DATE	N	L	Y	Y			Y

=====

LEGEND:

A/N/D	- A = ALPHANUMERIC, N = NUMERIC, D = DECIMAL
JUST	- L = LEFT JUSTIFY, R = RIGHT JUSTIFY, A = ALIGN
SIN	- Y = SKIP IF NONE OR NOT APPLICABLE
ZERO FILL	- Y = ENTER PRECEDING ZEROS OR ZERO FILL REMAINING DECIMAL PLACES
REG. CODE	- 1 = OPERATIONALLY REQUIRED 2 = PROGRAMMATICALLY REQUIRED 3 = OPERATIONALLY REQUIRED, CONDITIONALLY 4 = PROGRAMMATICALLY REQUIRED, CONDITIONALLY (SEE CHAPTER IV, "DATA BASE REGISTRATION REQUIREMENT", FOR FURTHER EXPLANATION)
GRANT ELIG.	- Y = DATA ELEMENT IS REQUIRED FOR A PWS TO BE CONSIDERED "GRANT ELIGIBLE" C = DATA ELEMENT IS CONDITIONALLY REQUIRED FOR A PWS TO BE CONSIDERED "GRANT ELIGIBLE"
CBR	- Y = CAN BE REMOVED (i.e., \$ IN LEFT-MOST POSITION) - N = CANNOT BE REMOVED



PWS ID

Spino

ID Number

(C101)

ACTION CODE

I = Insert M = Modify

BATCH DATE

140

DAY

YAP

G1		STATE DISCRETIONARY DATA	
SDD ID		STATE DISCRETIONARY DATA NAME	
(C4001)			
		STATE DISCRETIONARY VALUE	
(C4003)			
		QUANTITY	
(C4007)			
		MO DATE DAY YR	
(C4009)			

FRDS-II DATA ENTRY INSTRUCTIONS

RECORD DELETION FORM

RECORD DELETION FORM
(See Figure 22)

The RECORD DELETION FORM is available for the purpose of deleting an ENTIRE Data Base Record (DBR) from the FRDS-II Data Base.

Note that the form section names that are listed on the right side of the form identify all DBR types that can be deleted.

Although public water system DBRs can be deactivated, they cannot be deleted.

The DBR deletion process cannot violate the rules of FRDS-II record registration (e.g., each public water system DBR must have at least one source DBR).

Along with each section type is the necessary identification data that must be specified in order to delete the appropriate DBR. If an attempt is made to delete the last source DBR, that transaction will be rejected with an appropriate error message.

In all cases, the PWS ID must be specified. Additionally, at least one other record ID must be specified to uniquely identify the DBR to be deleted. For example, to delete a treatment DBR, the Source Entity ID (SE ID) must be specified along with the Treatment ID. This is because each treatment DBR is related to a particular Source Entity DBR.

The same methodology is used for VE Schedule record deletion since the Schedule Record is related to a particular VE DBR (Variances, Exemptions, and Other Related Data).



FRDS - II RECORD DELETION FORM

Batch Date

MO	DAY	YR
----	-----	----

RECORD TO BE DELETED

QUALIFIER 1	QUALIFIER 2	QUALIFIER 3	ACTION CODE	DATA BASE RECORD
A3 PWS ID State ID Number (C101)	ADDRESS ID (C301)		D (C300) ADDRESS	
B1 PWS ID State ID Number (C101)	SE ID (C401)		D (C400) SOURCE/ENTITY	
B2 PWS ID State ID Number (C101)	SE ID (C401)	TREATMENT ID (C481)	D (C480) TREATMENT	
C1 PWS ID State ID Number (C101)	GA ID (C501)		D (C500) GEOGRAPHIC AREAS SERVED	
C2 PWS ID State ID Number (C101)	SERV ID (C601)		D (C600) SERVICE AREA	
C3 PWS ID State ID Number (C101)	VISIT ID (C701)		D (C700) ON-SITE VISIT	
D1 PWS ID State ID Number (C101)	VIOLATION ID FY ID NUMBER (C1101)		D (C1100) VIOLATION	
E1 PWS ID State ID Number (C101)	ENFORCEMENT ID FY ID NUMBER (C1201)		D (C1200) ENFORCEMENT	
F1 PWS ID State ID Number (C101)	VE ID FY ID NUMBER (C3001)		D (C3000) VARIANCES, EXEMPTIONS & OTHER RELATED DATA	
F2 PWS ID State ID Number (C101)	VE ID FY ID NUMBER (C3001)	SCHED ID (C3101)	D (C3100) VE SCHEDULE	
G1 PWS ID State ID Number (C101)	SDD ID (C4001)		D (C4000) STATE DISCRETIONARY DATA	

FRDS-II DATA ENTRY INSTRUCTIONS

APPENDIX A

EXAMPLES OF DATA CAPTURE FORM / DATA TRANSFER FILE

DATA CAPTURE FORM A
EXAMPLE 1

The objective of the Data Capture Form A on page A3 is to insert into FRDS-II the facility name and address information for a Public Water System in Rhode Island with the ID number RI1583811.

SECTION A1 - SYSTEM ADDRESS

This information indicates that John Jones is the person responsible for the PWS Lippitt Estates Assn, located at Park View Terrace in Cumberland, RI 02864. He can be reached, by phone, at (401)333-0829.

SECTION A2 - PUBLIC WATER SYSTEM CHARACTERISTICS

This information indicates that PWS RI1583811 is an Active, Community PWS (see page 56 for definition) which commenced operation on or about June 1977 and serves 350 retail customers.

One hundred percent of the water is obtained from purchased, permanently available surface water sources.

It is privately owned and regulated by both Federal and State regulations and has 86 Retail Service Connections.

SECTION A3 - OTHER ADDRESSES

This information indicates that the Lippitt Estates Association is the System Owner/Responsible Party for RI1583811, and can be reached at 60 Beach Rd in Cumberland, RI 02864.

The user has assigned the Address ID (C301).



Public Water System Data Capture Form A

State **RI** PWS ID Number **1583811**
(C101)

ACTION CODE **I**
I = Insert M = Modify

BATCH DATE
MO **04** DAY **15** YR **87**

SYSTEM ADDRESS

A1 SYSTEM NAME **LIPPITT ESTATES ASSN**
(C131)
ADDRESS LINE 1 **JOHN JONES**
(C133)
ADDRESS LINE 2 **PARK VIEW TERRACE**
(C135)
CITY **CUMBERLAND** STATE **RI** ZIP CODE **02864**
(C137) (C139) (C141)
AREA CODE TELEPHONE NUMBER **4013330829**
(C143)

PUBLIC WATER SYSTEM CHARACTERISTICS

A2 PWS TYPE **C** C = COMMUNITY
(C105) H = NON-COMMUNITY
P = NON-TRANSIENT
NON-COMMUNITY
ACTIVITY FLAG **A** A = ACTIVE
(C107) I = INACTIVE
SYSTEM BEGIN YR **77** MO **06**
(C111)
DEACTIVATION DATE YR MO
(C113)
RETAL POPULATION SERVED **350**
(C117)
SOURCE WATER UTILIZED PERCENT SURFACE **100** PERCENT GROUND **0** PERCENT PURCHASED SURFACE **0** PERCENT PURCHASED GROUND **0** = 100%
(C121) (C122) (C125) (C127)
OWNER TYPE **2** REGULATING ENTITY **B** RETAL SERVICE CONNECTIONS **86** NON-COMMUNITY SEASON BEGIN MO DAY END MO DAY
(C163) (C165) (C147) (C159) (C161)

OTHER ADDRESS(ES)

A3 ID **1** TYPE **0** ADDRESSEE NAME **LIPPITT ESTATES ASSOCIATION**
(C301) (C303) (C305)
ADDRESS LINE 1
(C307)
ADDRESS LINE 2 **60 BEACH RD**
(C309)
CITY **CUMBERLAND** STATE **RI** ZIP CODE **02864**
(C311) (C313) (C315)

Sample Data Transfer File Records - FORM A

1-2	3-11	12-18	19-25	26	27-31	32-71	75-80
RI1583811			I	C131	LIPPITT ESTATES ASSN		041587
A1	RI1583811		I	C133	JOHN JONES		041587
A1	RI1583811		I	C135	PARK VIEW TERRACE		041587
A1	RI1583811		I	C137	CUMBERLAND		041587
A1	RI1583811		I	C139	RI		041587
A1	RI1583811		I	C141	02864		041587
A1	RI1583811		I	C143	4013330829		041587
A2	RI1583811		I	C105	C		041587
A2	RI1583811		I	C107	A		041587
A2	RI1583811		I	C111	7706		041587
A2	RI1583811		I	C117	350		041587
A2	RI1583811		I	C125	100		041587
A2	RI1583811		I	C163	2		041587

A2	RI1583811		I	C165	B		041587
2	RI1583811		I	C147	86		041587
A3	RI1583811	1	I	C303	0		041587
A3	RI1583811	1	I	C305	LIPPITT ESTATES ASSOCIATION		041587
A3	RI1583811	1	I	C309	60 BEACH ROAD		041587
A3	RI1583811	1	I	C311	CUMBERLAND		041587
A3	RI1583811	1	I	C313	RI		041587
3	RI1583811	1	I	C315	02864		041587

DATA CAPTURE FORM A
EXAMPLE 2

The objective of the Data Capture Form A on page A7 is to Modify Public Water System Characteristics information already existing in FRDS-II. Also note that different Batch Dates have been used to time sequence the transactions on the Data Transfer File; FRDS-II will automatically sort and process these transactions in ascending sequence thus allowing multiple Batch Dates to be submitted at the same time.

SECTION A2 - PUBLIC WATER SYSTEM CHARACTERISTICS

This modification indicates that RI1583811 became inactive on August 8. (Note: On the Sample Data Transfer File Records - FORM A, column 26 now has an M for modifying Data Elements C107 and C113.)

RECORD DELETION FORM

SECTION A3 - OTHER ADDRESS(ES)

The example on Page A8 shows how to delete a C300 (Other Address) Data Base Record (DBR) from FRDS-II. Note that all values previously reported for this address record will be removed with this single command.



Public Water System Data Capture Form A

PWS ID

State ID Number
RI 1583811
(C101)

ACTION CODE

M

I = Insert M = Modify

BATCH DATE

MO DAY YR
08 / 3 88

SYSTEM ADDRESS

A1

SYSTEM NAME

(C131)

ADDRESS LINE 1

(C132)

ADDRESS LINE 2

(C133)

CITY

(C137)

STATE

(C138)

ZIP CODE

(C141)

+4

AREA CODE TELEPHONE NUMBER

(C143)

PUBLIC WATER SYSTEM CHARACTERISTICS

A2PWS
TYPE
(C105)C - COMMUNITY
N - NON-COMMUNITY
P - NON-TRANSIENT
NON-COMMUNITYACTIVITY
FLAG
(C107)A - ACTIVE
I - INACTIVESYSTEM BEGIN
YR MO
(C111)DEACTIVATION DATE
YR MO
(C113)**88 08**RETAIL POPULATION SERVED
(C117)

SOURCE WATER UTILIZED

PERCENT
SURFACE

(C121)

+

PERCENT
GROUND

(C123)

+

PERCENT PURCHASED
SURFACE

(C125)

+

PERCENT PURCHASED
GROUND

(C127)

= 100%OWNER
TYPE

(C163)

REGULATING
ENTITY

(C165)

RETAIL SERVICE CONNECTIONS

(C147)

NON - COMMUNITY SEASON
BEGIN

(C159)

END

(C161)

OTHER ADDRESS(ES)

A3

ID

(C301)

TYPE

(C303)

ADDRESSEE NAME

(C306)

ADDRESS LINE 1

(C307)

ADDRESS LINE 2

(C308)

CITY

(C311)

STATE

(C313)

ZIP CODE

(C315)

+4



FRDS - II RECORD DELETION FORM

Batch Date

MO	DAY	YR
----	-----	----

RECORD TO BE DELETED

QUALIFIER 1	QUALIFIER 2	QUALIFIER 3	DATA BASE RECORD
A3 PWS ID State ID Number RI 1583811 (C101)	ADDRESS ID 1 (C301)	D ACTION CODE (C300) ADDRESS	
B1 PWS ID State ID Number (C101)	SE ID (C401)	D (C400) SOURCE/ENTITY	
B2 PWS ID State ID Number (C101)	SE ID (C401)	D TREATMENT ID (C481)	(C480) TREATMENT
C1 PWS ID State ID Number (C101)	GA ID (C801)	D (C500) GEOGRAPHIC AREAS SERVED	
C2 PWS ID State ID Number (C101)	SERV ID (C801)	D (C600) SERVICE AREA	
C3 PWS ID State ID Number (C101)	VISIT ID (C701)	D (C700) ON-SITE VISIT	
D1 PWS ID State ID Number (C101)	VIOLATION ID FY ID NUMBER (C1101)	D (C1100) VIOLATION	
E1 PWS ID State ID Number (C101)	ENFORCEMENT ID FY ID NUMBER (C1201)	D (C1200) ENFORCEMENT	
F1 PWS ID State ID Number (C101)	VE ID FY ID NUMBER (C3001)	D (C3000) VARIANCES, EXEMPTIONS & OTHER RELATED DATA	
F2 PWS ID State ID Number (C101)	VE ID FY ID NUMBER (C3001)	D SCHED ID (C3101)	(C3100) VE SCHEDULE
G1 PWS ID State ID Number (C101)	SDO ID (C4001)	D (C4000) STATE DISCRETIONARY DATA	

Sample Data Transfer File Records - FORM A

1-2	3-11	12-18	19-25	26	27-31	32-71	75-80
A2	RI1583811				MIC107	I	081388

A2	RI1583811				MIC113	8808	081388

A3	RI1583811	1			DIC300		081688

DATA CAPTURE FORM B
EXAMPLE 1

The objective of the Data Capture Form B on page A11 is to Insert data that identifies sources of water that are utilized by the Public Water System and to specify the treatments applied. The user has requested FRDS-II to generate both the SE IDs, and the TREATMENT IDs for this Public Water System's sources and treatments.

SECTION B1 - SOURCE/ENTITY DATA

This section requires us to enter Source/Entity data for a Public Water System, in this case RI1583811. We have requested FRDS-II to generate the SE ID for the Cumberland River which is a Surface water source (S), with an availability of (P) designating that it is a Permanently available source. (Note: The Data Entry Instructions refer you to the appropriate tables in Section VI of the Data Element Dictionary). This section permits us to enter Latitude and Longitude of 415700, 0712500 respectively and a Hydrologic Unit Code of 01090003001 and the fact that it is located 10.3 miles On Reach.

SECTION B2 - TREATMENT DATA

The Treatment Objectives of D, I, O and P represents Disinfection, Inorganics Removal, Organics Removal and Particulate Removal respectively. The associated treatment processes identify: Chlorine Dioxide (220); Activated Alumina (100); Flocculation (360); Sedimentation (660); and Coagulation (240).

EXAMPLE 2

SECTION B1 & B2- SOURCE/ENTITY & TREATMENT DATA

This entry will Insert Source/Entity and Treatment data for a second source of water for PWS RI1583811, named Well 1. It requests FRDS-II to generate both the SE and TREATMENT IDs. Treatment Objective B indicates Disinfection By-products Control. Treatment Process 121 represents Activated Carbon, Granular while a second Treatment Process (220) identifies the use of Chlorine Dioxide (see Treatment Processes by Treatment Objective tables in Section VI of the Data Element Dictionary.)



Public Water System Data Capture Form B

U.S. ENVIRONMENTAL
PROTECTION AGENCY

PWS ID

ACTION CODE

BATCH DATE

State **RI** ID Number **1583811**
(C101)

I
I = Insert M = Modify

04/15/87

SOURCE / ENTITY DATA

SE ID B1 (C401)	NAME GO1 CUMBERLAND RIVER (C403)	SE RECORD TYPE S (C405)	SE CODE S (C407)	AVAILABILITY A (C409)
STATE RI (C411)	SELLER PWS ID 1583811 (C403)	LATITUDE DEG MIN SEC 41 57 00 (C415)	LONGITUDE DEG MIN SEC 07 12 50 (C417)	
TOWNSHIP N/S 01 (C419)	TOWNSHIP RANGE 09 (C421)	E/W 00 (C423)	SEC 30 (C425)	1/4 SEC 01 (C427)
HYDROLOGIC UNIT CODE 01090003001 (C427)		RIVER REACH 01 (C429)	ON REACH Y (C431)	REACH MILES 10.3 (C431)

TREATMENT DATA

SE ID B2 (C401)	TREATMENT ID GO1 (C403)	TREATMENT OBJECTIVE D (C405)	TREATMENT PROCESS 220 (C407)
GO1 (C401)	GO2 (C403)	I (C405)	100 (C407)
GO1 (C401)	GO3 (C403)	O (C405)	360 (C407)
GO1 (C401)	GO4 (C403)	O (C405)	660 (C407)
GO1 (C401)	GO5 (C403)	P (C405)	240 (C407)

SOURCE / ENTITY DATA

SE ID B1 (C401)	NAME GO2 WELL 1 (C403)	SE RECORD TYPE S (C405)	SE CODE G (C407)	AVAILABILITY P (C409)
STATE RI (C411)	SELLER PWS ID 1583811 (C403)	LATITUDE DEG MIN SEC 41 57 40 (C415)	LONGITUDE DEG MIN SEC 07 12 51 (C417)	
TOWNSHIP N/S 01 (C419)	TOWNSHIP RANGE 09 (C421)	E/W 00 (C423)	SEC 30 (C425)	1/4 SEC 03 (C427)
HYDROLOGIC UNIT CODE 01090003003 (C427)		RIVER REACH N (C429)	ON REACH N (C431)	REACH MILES 5.7 (C431)

TREATMENT DATA

SE ID B2 (C401)	TREATMENT ID GO1 (C403)	TREATMENT OBJECTIVE B (C405)	TREATMENT PROCESS 220 (C407)
GO2 (C401)	GO2 (C403)	B (C405)	121 (C407)
GO2 (C401)	GO2 (C403)	B (C405)	121 (C407)
GO2 (C401)	GO2 (C403)	B (C405)	121 (C407)
GO2 (C401)	GO2 (C403)	B (C405)	121 (C407)

Sample Data Transfer File Records - FORM B

1-2	3-11	12-18	19-25	26	27-31	32-71	75-80
RI1583811	G01		I	C403	CUMBERLAND RIVER		041587
B1	RI1583811	G01		I	C405	S	041587
B1	RI1583811	G01		I	C407	S	041587
B1	RI1583811	G01		I	C409	P	041587
B1	RI1583811	G01		I	C415	415700	041587
B1	RI1583811	G01		I	C417	712500	041587
R1	RI1583811	G01		I	C427	01090003001	041587
B1	RI1583811	G01		I	C429	Y	041587
B1	RI1583811	G01		I	C431	10.3	041587
B2	RI1583811	G01	G01	I	C483	D	041587
B2	RI1583811	G01	G01	I	C485	220	041587
B2	RI1583811	G01	G02	I	C483	I	041587
B2	RI1583811	G01	G02	I	C485	100	041587

B2	RI1583811	G01	G03	I	C483	O	041587
2	RI1583811	G01	G03	I	C485	360	041587
B2	RI1583811	G01	G04	I	C483	O	041587
B2	RI1583811	G01	G04	I	C485	660	041587
B2	RI1583811	G01	G05	I	C483	P	041587
B2	RI1583811	G01	G05	I	C485	240	041587
B1	RI1583811	G02		I	C403	WELL 1	041587
B1	RI1583811	G02		I	C405	S	041587
B1	RI1583811	G02		I	C407	G	041587
B1	RI1583811	G02		I	C409	P	041587
B1	RI1583811	G02		I	C415	415740	041587
B1	RI1583811	G02		I	C417	0712519	041587
B1	RI1583811	G02		I	C427	01090003003	041587
B1	RI1583811	G02		I	C429	N	041587

B1|RI1583811|G02| |I|C431|5.7|041587|
--|-----|-----|-----|-----|-----|-----|

B2|RI1583811|G02|G01|I|C483|B|041587|
--|-----|-----|-----|-----|-----|-----|

B2|RI1583811|G02|G01|I|C485|220|041587|
--|-----|-----|-----|-----|-----|-----|

B2|RI1583811|G02|G02|I|C483|B|041587|
--|-----|-----|-----|-----|-----|-----|

B2|RI1583811|G02|G02|I|C485|121|041587|
--|-----|-----|-----|-----|-----|-----|

DATA CAPTURE FORM B
EXAMPLE 3

The objective of the section on Page A16 is to submit Source/Entity Data and Treatment Data with a user supplied SE ID, and TREATMENT ID.

SECTION B1 - SOURCE/ENTITY DATA

This entry will insert a Source record for a Permanently Available, Purchased, Surface Source, the Town of Cumberland. Note that the Seller PWS-ID number is provided to show from whom the water is being purchased.

SECTION B2 - TREATMENT DATA

The Treatment Objective of N represents No Treatment At Source, while the Treatment Process Code of 997 indicates that the Treatment was applied at the Plant. Note that if a Treatment Objective of N is reported, NO OTHER Treatment Objective may be reported for that Source record.

EXAMPLE 4

SECTION B1 - SOURCE/ENTITY DATA

This entry will insert the required Plant record (The Jackson Treatment Plant) that was referred to in the "Treatment Applied at Plant" Treatment record in Example 3 above. Note that at least one Plant (SE Record Type P) record with Treatment Objectives other than N, must be provided whenever a Source record specifies a Treatment Objective of N.

SECTION B2 - TREATMENT DATA

Treatment Objectives F, D and C, (Iron Removal, Disinfection and Corrosion Control respectively) are shown, identifying the related TREATMENT PROCESSES: Aeration, Spray (149); Filtration, Slow Sand (346); Hypochlorination, Pre (423); and pH Adjustment (740)).



Public Water System Data Capture Form B

U.S. ENVIRONMENTAL
PROTECTION AGENCY

PWS ID

ACTION CODE

BATCH DATE

State ID Number
RI **15838** **11**
(C101)

I I = Insert M = Modify

MO DAY YR
04 **15** **87**

SOURCE / ENTITY DATA

SE ID B1 (C401)	NAME 001 TOWN OF CUMBERLAND (C403)	SE RECORD TYPE S (C405)	SE CODE P (C407)	AVAILABILITY P (C409)
STATE RI (C411)	SELLER PWS ID 1647530 (C413)	LATITUDE DEG MIN SEC 41 57 00 (C415)		
LONGITUDE DEG MIN SEC 07 12 50 (C417)		RIVER REACH HYDROLOGIC UNIT CODE 0712500 (C427)		
TOWNSHIP N/S 16 (C419)	RANGE 47 (C421)	E/W 30 (C423)	1/4 SEC 00 (C425)	ON REACH 00 (C429)
REACH MILES 0.00 (C431)				

TREATMENT DATA

SE ID B2 (C401)	TREATMENT ID 001 (C403)	TREATMENT OBJECTIVE N (C405)	TREATMENT PROCESS 997 (C407)
001 (C401)	01 (C403)	N (C405)	997 (C407)
001 (C401)	01 (C403)	N (C405)	997 (C407)
001 (C401)	01 (C403)	N (C405)	997 (C407)
001 (C401)	01 (C403)	N (C405)	997 (C407)

SOURCE / ENTITY DATA

SE ID B1 (C401)	NAME 002 JACKSON TREATMENT PLANT (C403)	SE RECORD TYPE P (C405)	SE CODE T (C407)	AVAILABILITY P (C409)
STATE RI (C411)	SELLER PWS ID 1647530 (C413)	LATITUDE DEG MIN SEC 41 57 00 (C415)		
LONGITUDE DEG MIN SEC 07 12 50 (C417)		RIVER REACH HYDROLOGIC UNIT CODE 0712500 (C427)		
TOWNSHIP N/S 16 (C419)	RANGE 47 (C421)	E/W 30 (C423)	1/4 SEC 00 (C425)	ON REACH 00 (C429)
REACH MILES 0.00 (C431)				

TREATMENT DATA

SE ID B2 (C401)	TREATMENT ID 002 (C403)	TREATMENT OBJECTIVE F (C405)	TREATMENT PROCESS 149 (C407)
002 (C401)	01 (C403)	F (C405)	149 (C407)
002 (C401)	02 (C403)	D (C405)	346 (C407)
002 (C401)	03 (C403)	D (C405)	423 (C407)
002 (C401)	04 (C403)	C (C405)	740 (C407)
002 (C401)	05 (C403)	C (C405)	740 (C407)

Sample Data Transfer File Records - FORM B

2	3-11	12-18	19-25	26	27-31	32-71	75-80
B1	RI1583811	001		I	C403	TOWN OF CUMBERLAND	041587
B1	RI1583811	001		I	C405	S	041587
B1	RI1583811	001		I	C407	P	041587
B1	RI1583811	001		I	C409	P	041587
B1	RI1583811	001		I	C411	RI1647530	041587
B1	RI1583811	001		I	C415	415700	041587
B1	RI1583811	001		I	C417	712500	041587
B2	RI1583811	001	01	I	C483	N	041587
B2	RI1583811	001	01	I	C485	997	041587
B1	RI1583811	002		I	C403	JACKSON TREATMENT PLANT	041587
B1	RI1583811	002		I	C405	P	041587
B1	RI1583811	002		I	C407	T	041587

B1|RI1583811|002| |I|C409|P| |041587|
--|-----|-----|-----|-----|-----|-----|

B1|RI1583811|002| |I|C415|415700| |041587|
--|-----|-----|-----|-----|-----|-----|

B1|RI1583811|002| |I|C417|0712500| |041587|
--|-----|-----|-----|-----|-----|-----|

B2|RI1583811|002|01|I|C483|F| |041587|
--|-----|-----|-----|-----|-----|-----|

B2|RI1583811|002|01|I|C485|149| |041587|
--|-----|-----|-----|-----|-----|-----|

B2|RI1583811|002|02|I|C483|D| |041587|
--|-----|-----|-----|-----|-----|-----|

B2|RI1583811|002|02|I|C485|346| |041587|
--|-----|-----|-----|-----|-----|-----|

B2|RI1583811|002|03|I|C483|D| |041587|
--|-----|-----|-----|-----|-----|-----|

B2|RI1583811|002|03|I|C485|423| |041587|
--|-----|-----|-----|-----|-----|-----|

B2|RI1583811|002|04|I|C483|C| |041587|
--|-----|-----|-----|-----|-----|-----|

B2|RI1583811|002|04|I|C485|740| |041587|
--|-----|-----|-----|-----|-----|-----|

DATA CAPTURE FORM B
EXAMPLE 5

The objective of the example on Page A20 is to remove the Latitude and Longitude information. This is done as a modify using the \$ in the first position of either the Latitude(C415) or Longitude(C417). In this example we have blanked out (initialized to nulls) Latitude. Longitude will be blanked out automatically (i.e., initialized to nulls) by the system. It is not necessary for the user to do both.

RECORD DELETION FORM

SECTION B2 - TREATMENT DATA

The example on Page A21 shows how to delete a C480 (Treatment Data) Data Base Record (DBR) from FRDS-II. Note that all values previously reported for this treatment data record will be removed with this single command.



Public Water System Data Capture Form B

State **RI** PWS ID **1583811**
(C101) (C403)

ACTION CODE

M

I = Insert M = Modify

BATCH DATE

MO **09** DAY **08** YR **89**

SOURCE / ENTITY DATA

B1	SE ID (C401)	NAME (C403)	SE RECORD TYPE (C405)	SE CODE (C407)	AVAILABILITY (C408)
STATE SELLER PWS ID ID NUMBER					
TOWNSHIP RANGE E/W SEC 1/4SEC					
LATITUDE DEG MIN SEC LONGITUDE DEG MIN SEC					
RIVER REACH ON REACH REACH MILES					
HYDROLOGIC UNIT CODE SEQ NUM					

TREATMENT DATA

B2	SE ID (C401)	TREATMENT ID (C481)	TREATMENT OBJECTIVE (C483)	TREATMENT PROCESS (C485)

SOURCE / ENTITY DATA

B1	SE ID (C401)	NAME (C403)	SE RECORD TYPE (C405)	SE CODE (C407)	AVAILABILITY (C408)
STATE SELLER PWS ID ID NUMBER					
TOWNSHIP RANGE E/W SEC 1/4SEC					
LATITUDE DEG MIN SEC LONGITUDE DEG MIN SEC					
RIVER REACH ON REACH REACH MILES					
HYDROLOGIC UNIT CODE SEQ NUM					

TREATMENT DATA

B2	SE ID (C401)	TREATMENT ID (C481)	TREATMENT OBJECTIVE (C483)	TREATMENT PROCESS (C485)



FRDS - II RECORD DELETION FORM

Batch Date

RECORD TO BE DELETED

MO 08 DAY 16 YR 81

QUALIFIER 1	QUALIFIER 2	QUALIFIER 3	DATA BASE RECORD
PWS ID State ID Number A3 (C101)	ADDRESS ID (C301)	ACTION CODE D (C300) ADDRESS	
PWS ID State ID Number B1 (C101)	SE ID (C401)	D (C400) SOURCE/ENTITY	
PWS ID State ID Number B2 (C101) RI 1583811	SE ID (C401) 042	TREATMENT ID (C481) 04 D (C480) TREATMENT	
PWS ID State ID Number C1 (C101)	GA ID (C601)	D (C500) GEOGRAPHIC AREAS SERVED	
PWS ID State ID Number C2 (C101)	SERV ID (C601)	D (C600) SERVICE AREA	
PWS ID State ID Number C3 (C101)	VISIT ID (C701)	D (C700) ON-SITE VISIT	
PWS ID State ID Number D1 (C101)	VIOLATION ID FY ID NUMBER (C1101)	D (C1100) VIOLATION	
PWS ID State ID Number E1 (C101)	ENFORCEMENT ID FY ID NUMBER (C1201)	D (C1200) ENFORCEMENT	
PWS ID State ID Number F1 (C101)	VE ID FY ID NUMBER (C3001)	D (C3000) VARIANCES, EXEMPTIONS & OTHER RELATED DATA	
PWS ID State ID Number F2 (C101)	VE ID FY ID NUMBER (C3001)	SCHED ID (C3101) D (C3100) VE SCHEDULE	
PWS ID State ID Number G1 (C101)	SDO ID (C4001)	D (C4000) STATE DISCRETIONARY DATA	

Sample Data Transfer File Records - FORM B

1-2	3-11	12-18	19-25	26	27-31	32-71	75-80
-----	------	-------	-------	----	-------	-------	-------

B1	RI1583811	001		M	C415	\$	080888
----	-----------	-----	--	---	------	----	--------

B2	RI1583811	002	04	D	C480		081688
----	-----------	-----	----	---	------	--	--------

041587

041587

DATA CAPTURE FORM C
EXAMPLE 1

The objective of the example on Page A24 is to Insert Geographic Areas Served, Information.

SECTION C1 - GEOGRAPHIC AREAS SERVED

The user has requested FRDS-II to generate the GA ID in this example. He/she has Inserted new information on Administrative Region 01, Federal Congressional District 01, FIPS County Code 007, and the City of Cumberland being served by this PWS.

SECTION C2 - SERVICE AREAS

FRDS-II will generate SERV ID for this Service Area, with a TYPE/CAT of R2 (Mobile Home Park), another Service Area with a TYPE/CAT of T2 (Service Station) and one with S2 (Institution). Note prefixes R = Residential, T = Transient, and S = Semi-residential. Also, since the Primary Service Flag need only be reported for Non-Community and Non-Transient, Non-Community Water Systems (i.e., PWS-TYPE of N or P) and this is a Community Water System, the Primary Service Flag need not be reported for this PWS.

SECTION C3 - ON-SITE VISITS

FRDS-II will automatically generate the VISIT ID in this example. This section will create a Visit record in FRDS-II with a Visit Date of March 28, 1987, and a Visit Reason 1, indicating a Sanitary Survey was the reason for the visitation.



Public Water System Data Capture Form C

U.S. ENVIRONMENTAL
PROTECTION AGENCY

PWS ID

ACTION CODE

BATCH DATE

State ID Number
RI 1583811
(C101)

I I = Insert M = Modify

04/15/87

C1

GEOGRAPHIC AREAS SERVED

GA ID	ADMIN REGION	ADMIN DISTRICT	FEDERAL CONGRESS DISTRICT	STATE COUNTY	FIPS COUNTY	CITY	INDIAN RESERVATION
G1	01		01		007	CUMBERLAND	

(C501) (C503) (C505) (C507) (C508) (C509) (C513) (C515)

C2

SERVICE AREAS

SERV ID	TYPE / CAT	PRIMARY SERVICE FLAG
G1	R2	
G2	T2	
G3	S2	

(C601) (C603) (C605)

C3

ON-SITE VISITS

VISIT ID	VISIT DATE MO DAY YR	VISIT REASON
G1	03/28/87	1

(C701) (C703) (C705)

Sample Data Transfer File Records - FORM C

2	3-11	12-18	19-25	26	27-31	32-71	75-80
RI1583811	G1			I	C503	01	041587

C1	RI1583811	G1		I	C507	01	041587
----	-----------	----	--	---	------	----	--------

C1	RI1583811	G1		I	C509	007	041587
----	-----------	----	--	---	------	-----	--------

C1	RI1583811	G1		I	C513	CUMBERLAND	041587
----	-----------	----	--	---	------	------------	--------

C2	RI1583811	G1		I	C603	R2	041587
----	-----------	----	--	---	------	----	--------

C2	RI1583811	G2		I	C603	T2	041587
----	-----------	----	--	---	------	----	--------

2	RI1583811	G3		I	C603	S2	041587
---	-----------	----	--	---	------	----	--------

C3	RI1583811	G1		I	C703	032886	041587
----	-----------	----	--	---	------	--------	--------

C3	RI1583811	G1		I	C705	1	041587
----	-----------	----	--	---	------	---	--------

DATA CAPTURE FORM C
EXAMPLE 2

The objective of the form on Page A27 is to Insert Geographic Areas Served information along with Service Areas and On-Sight Visits data as in Example 1 of Data Capture Form C. However, in this example, the user submits the GA ID, SERV ID and VISIT ID instead of them being generated by the system.

The user has entered a State County Code rather than the FIPS County Code. However, he/she had previously submitted the requisite State County Code to FIPS County Code conversion table to the FRDS DBA, thus enabling FRDS-II to store both code values in the data base.



PWS 10

ACTION CODE

BATCH DATE

Slater

ID Number

RI 1583811
(C101)

I

I = Insert M = Modify

MO DAY YR
04 / 518 7

C1

GA ID	ADMIN REGION	ADMIN DISTRICT	CONGRESS DISTRICT	STATE COUNTY	FIPS COUNTY	CITY	INDIAN RESERVATION
0102			01	006		CUMBERLAND	

1	2	3	4	5	6	7	8	9	10	11	12	13	14	15	16	17	18	19	20	21	22	23	24	25	26	27	28	29	30	31	32	33	34	35	36	37	38	39	40	41	42	43	44	45	46	47	48	49	50	51	52	53	54	55	56	57	58	59	60	61	62	63	64	65	66	67	68	69	70	71	72	73	74	75	76	77	78	79	80	81	82	83	84	85	86	87	88	89	90	91	92	93	94	95	96	97	98	99	100
---	---	---	---	---	---	---	---	---	----	----	----	----	----	----	----	----	----	----	----	----	----	----	----	----	----	----	----	----	----	----	----	----	----	----	----	----	----	----	----	----	----	----	----	----	----	----	----	----	----	----	----	----	----	----	----	----	----	----	----	----	----	----	----	----	----	----	----	----	----	----	----	----	----	----	----	----	----	----	----	----	----	----	----	----	----	----	----	----	----	----	----	----	----	----	----	----	----	----	-----

(C501)	(C502)	(C503)	(C507)	(C508)	(C509)	(C513)	(C515)
--------	--------	--------	--------	--------	--------	--------	--------

C2

SERV ID	TYPE / CAT	PRIMARY SERVICE FLAG
101	R2	Y

02 72 1

03 52 U

U L L I

U U U

U L L U

(C801) (C803) (C805)

C3

VISIT ID	VISIT DATE			VISIT REASON
	MO	DAY	YR	
01	03	28	87	1

U L U L U L U

1	2	3	4	5	6	7	8	9	10	11	12	13	14	15	16	17	18	19	20	21	22	23	24	25	26	27	28	29	30	31	32	33	34	35	36	37	38	39	40	41	42	43	44	45	46	47	48	49	50	51	52	53	54	55	56	57	58	59	60	61	62	63	64	65	66	67	68	69	70	71	72	73	74	75	76	77	78	79	80	81	82	83	84	85	86	87	88	89	90	91	92	93	94	95	96	97	98	99	100
---	---	---	---	---	---	---	---	---	----	----	----	----	----	----	----	----	----	----	----	----	----	----	----	----	----	----	----	----	----	----	----	----	----	----	----	----	----	----	----	----	----	----	----	----	----	----	----	----	----	----	----	----	----	----	----	----	----	----	----	----	----	----	----	----	----	----	----	----	----	----	----	----	----	----	----	----	----	----	----	----	----	----	----	----	----	----	----	----	----	----	----	----	----	----	----	----	----	----	-----

WILLIAM L. BROWN

WILLIAM L.

1	2	3	4	5	6	7	8	9	10	11	12	13	14	15	16	17	18	19	20	21	22	23	24	25	26	27	28	29	30	31	32	33	34	35	36	37	38	39	40	41	42	43	44	45	46	47	48	49	50	51	52	53	54	55	56	57	58	59	60	61	62	63	64	65	66	67	68	69	70	71	72	73	74	75	76	77	78	79	80	81	82	83	84	85	86	87	88	89	90	91	92	93	94	95	96	97	98	99	100
---	---	---	---	---	---	---	---	---	----	----	----	----	----	----	----	----	----	----	----	----	----	----	----	----	----	----	----	----	----	----	----	----	----	----	----	----	----	----	----	----	----	----	----	----	----	----	----	----	----	----	----	----	----	----	----	----	----	----	----	----	----	----	----	----	----	----	----	----	----	----	----	----	----	----	----	----	----	----	----	----	----	----	----	----	----	----	----	----	----	----	----	----	----	----	----	----	----	----	-----

(C701) (C703) (C705)

Sample Data Transfer File Records - FORM C

-2	3-11	12-18	19-25	26	27-31	32-71	75-80
C1	RI1583811	01		I	C503	02	041587
C1	RI1583811	01		I	C507	01	041587
C1	RI1583811	01		I	C508	006	041587
C1	RI1583811	01		I	C513	CUMBERLAND	041587
C2	RI1583811	01		I	C603	R2	041587
C2	RI1583811	01		I	C603	Y	041587
C2	RI1583811	02		I	C603	T2	041587
C2	RI1583811	03		I	C603	S2	041587
C3	RI1583811	01		I	C703	032887	041587
C3	RI1583811	G1		I	C705	1	041587

DATA CAPTURE FORM D
EXAMPLE 1

The objective of the form on Page A30 is to Insert Violation Data for RI1583811. In this example, the user has provided the Violation ID Number and contaminant information related to a monitoring violation (Violation Type 03).

SECTION D1 - VIOLATION DATA

Violation 8600006 is a Regular Monitoring Violation (Type 03) for Coliform Microbiological Contamination (Contaminant 3000). This is a Major Violation since no required samples were taken. The Compliance Period Begin Date (i.e., Violation Date) was October 15, 1985, with a compliance period of one month.

DATA CAPTURE FORM D
EXAMPLE 2

SECTION D1 - VIOLATION DATA

Violation 8600007 is also a Regular Monitoring Violation for Coliform. It is a Major Violation with a compliance period of one month.

Note: The two examples on this page are almost identical. The purpose is to demonstrate the collection of data for two violations, with the same batch date, for the same Public Water System on the same Data Capture Form.



Public Water System Data Capture Form D

U.S. ENVIRONMENTAL
PROTECTION AGENCY

PWS ID

ACTION CODE

BATCH DATE

State

ID Number

RI 15838111
(C101)

I

I = Insert M = Modify

MO DAY YR
10 11 15 18 7

D1

VIOLATION DATA

VIOLATION ID
FY ID NUMBER
8600006
(C1101)

CONTAMINANT
B000
(C1103)

VIOLATION
TYPE
03
(C1105)

COMPLIANCE PERIOD BEGIN
MO DAY YR
11 01 85
(C1107)

COMPLIANCE PERIOD END
MO DAY YR

(C1109)

OR

COMPLIANCE PERIOD
DURATION
1001
(C1111)

SE ID

(C1143)

AWARENESS DATE
MO DAY YR

(C1115)

MONITORING AND REPORTING VIOLATIONS

NUM SAMPLES
REQUIRED

(C1127)

NUM SAMPLES
TAKEN

(C1129)

OR

MAJOR
VIOLATION
Y
Y = YES
N = NO
(C1131)

OR

MAXIMUM CONTAMINANT LEVEL VIOLATIONS

ANALYSIS
METHOD

(C1121)

ANALYSIS RESULT

MCL VIOLATED

D1

VIOLATION DATA

VIOLATION ID
FY ID NUMBER
8600007
(C1101)

CONTAMINANT
B000
(C1103)

VIOLATION
TYPE
03
(C1105)

COMPLIANCE PERIOD BEGIN
MO DAY YR
11 01 85
(C1107)

COMPLIANCE PERIOD END
MO DAY YR

(C1109)

OR

COMPLIANCE PERIOD
DURATION
1001
(C1111)

SE ID

(C1143)

AWARENESS DATE
MO DAY YR

(C1115)

MONITORING AND REPORTING VIOLATIONS

NUM SAMPLES
REQUIRED

(C1127)

NUM SAMPLES
TAKEN

(C1129)

OR

MAJOR
VIOLATION
Y
Y = YES
N = NO
(C1131)

OR

MAXIMUM CONTAMINANT LEVEL VIOLATIONS

ANALYSIS
METHOD

(C1121)

ANALYSIS RESULT

MCL VIOLATED

Sample Data Transfer File Records - FORM D

2	3-11	12-18	19-25	26	27-31	32-71	75-80
RI1583811	8600006		I	C1103	3000		041587

D1	RI1583811	8600006		I	C1105	03	041587
----	-----------	---------	--	---	-------	----	--------

D1	RI1583811	8600006		I	C1107	101585	041587
----	-----------	---------	--	---	-------	--------	--------

D1	RI1583811	8600006		I	C1111	001	041587
----	-----------	---------	--	---	-------	-----	--------

D1	RI1583811	8600006		I	C1131	Y	041587
----	-----------	---------	--	---	-------	---	--------

D1	RI1583811	8600007		I	C1103	3000	041587
----	-----------	---------	--	---	-------	------	--------

	RI1583811	8600007		I	C1105	03	041587
--	-----------	---------	--	---	-------	----	--------

D1	RI1583811	8600007		I	C1107	110185	041587
----	-----------	---------	--	---	-------	--------	--------

D1	RI1583811	8600007		I	C1111	001	041587
----	-----------	---------	--	---	-------	-----	--------

D1	RI1583811	8600007		I	C1131	Y	041587
----	-----------	---------	--	---	-------	---	--------

DATA CAPTURE FORM D
EXAMPLE 3

The objective of the example on Page A33 is to Insert Violation data for Public Water System RI1583811.

SECTION D1 - VIOLATION DATA

Violation 8700231, for Arsenic, type 02 (MCL, Average) has a Compliance Period Begin date of July 01, 1986. The Awareness Date was March 15, 1987.

The Analysis Method 101 (Atomic Absorption) used resulted in an Analysis Result of .06. The MCL Violated was .05.



U.S. ENVIRONMENTAL
PROTECTION AGENCY

Public Water System Data Capture Form D

PWS ID

ACTION CODE

BATCH DATE

State ID Number
RI 1583811
(C1101)

☒ I - Insert M - Modify

MO DAY YR
04/15/87

D1

VIOLATION DATA

VIOLATION ID
FY ID NUMBER
87002311
(C1101)

CONTAMINANT
1005
(C1103)

VIOLATION
TYPE
02
(C1105)

COMPLIANCE PERIOD BEGIN
MO DAY YR
070186
(C1107)

COMPLIANCE PERIOD END
MO DAY YR
(C1109)

OR

COMPLIANCE PERIOD
DURATION
036
(C1111)

SE ID
001
(C1143)

AWARENESS DATE
MO DAY YR
03/15/87
(C1115)

MONITORING AND REPORTING VIOLATIONS

NUM SAMPLES
REQUIRED
(C1127)

NUM SAMPLES
TAKEN
(C1129)

OR

MAJOR
VIOLATION
Y - YES
N - NO
(C1131)

OR

MAXIMUM CONTAMINANT LEVEL VIOLATIONS

ANALYSIS
METHOD
101
(C1121)

ANALYSIS RESULT
06
(C1123)

MCL VIOLATED
05
(C1125)

D1

VIOLATION DATA

VIOLATION ID
FY ID NUMBER
(C1101)

CONTAMINANT
(C1103)

VIOLATION
TYPE
(C1105)

COMPLIANCE PERIOD BEGIN
MO DAY YR
(C1107)

COMPLIANCE PERIOD END
MO DAY YR
(C1109)

OR

COMPLIANCE PERIOD
DURATION
(C1111)

SE ID
(C1143)

AWARENESS DATE
MO DAY YR
(C1115)

MONITORING AND REPORTING VIOLATIONS

NUM SAMPLES
REQUIRED
(C1127)

NUM SAMPLES
TAKEN
(C1129)

OR

MAJOR
VIOLATION
Y - YES
N - NO
(C1131)

OR

MAXIMUM CONTAMINANT LEVEL VIOLATIONS

ANALYSIS
METHOD
(C1121)

ANALYSIS RESULT
(C1123)

MCL VIOLATED
(C1125)

Sample Data Transfer File Records - FORM D

1-2	3-11	12-18	19-25	26	27-31	32-71	75-80
1	RI1583811	8700231		I	C1103	1005	041587
D1	RI1583811	8700231		I	C1105	02	041587
D1	RI1583811	8700231		I	C1107	070186	041587
D1	RI1583811	8700231		I	C1111	036	041587
D1	RI1583811	8700231		I	C1143	001	041587
D1	RI1583811	8700231		I	C1115	031587	041587
D1	RI1583811	8700231		I	C1121	101	041587
D1	RI1583811	8700231		I	C1123	.06	041587
D1	RI1583811	8700231		I	C1125	.05	041587

DATA CAPTURE FORM D
EXAMPLE 4

The objective of the example on Page A36 is to Modify violation data for Violation 8600006, for PWS RI1583811.

SECTION D1 - VIOLATION DATA

The Compliance Period Begin date was erroneously inserted as October 15, 1985. In this modify we are changing the Compliance Period Begin date to October 1, 1985.

RECORD DELETION FORM

SECTION D1 - VIOLATION DATA

The example on Page A37 shows how to delete a C1100 (Violation Data) Data Base Record (DBR) from FRDS-II. Note that all values previously reported for this violation record and all linkages to its related enforcement actions will be removed with this single command.



Public Water System Data Capture Form D

U.S. ENVIRONMENTAL
PROTECTION AGENCY

PWS ID

ACTION CODE

BATCH DATE

State ID Number
RI 1583811
(C101)

M I = Insert M = Modify

NO 81 DAY 38 YR 8

D1

VIOLATION DATA

VIOLATION ID
FY ID NUMBER
8600006
(C1101)

CONTAMINANT

(C1103)

VIOLATION
TYPE

(C1106)

COMPLIANCE PERIOD BEGIN
MO DAY YR
1100185
(C1107)

COMPLIANCE PERIOD END
MO DAY YR

(C1108)

OR

COMPLIANCE PERIOD
DURATION

(C1111)

SE ID

(C1143)

AWARENESS DATE
MO DAY YR

(C1115)

NUM SAMPLES
REQUIRED

(C1127)

NUM SAMPLES
TAKEN

(C1129)

OR

MAJOR
VIOLATION
 Y = YES
N = NO
(C1131)

OR

MAXIMUM CONTAMINANT LEVEL VIOLATIONS

ANALYSIS
METHOD

(C1121)

ANALYSIS RESULT

MCL VIOLATED

(C1125)

D1

VIOLATION DATA

VIOLATION ID
FY ID NUMBER

(C1101)

CONTAMINANT

(C1103)

VIOLATION
TYPE

(C1106)

COMPLIANCE PERIOD BEGIN
MO DAY YR

(C1107)

COMPLIANCE PERIOD END
MO DAY YR

(C1108)

OR

COMPLIANCE PERIOD
DURATION

(C1111)

SE ID

(C1143)

AWARENESS DATE
MO DAY YR

(C1115)

NUM SAMPLES
REQUIRED

(C1127)

NUM SAMPLES
TAKEN

(C1129)

OR

MAJOR
VIOLATION
 Y = YES
N = NO
(C1131)

OR

MAXIMUM CONTAMINANT LEVEL VIOLATIONS

ANALYSIS
METHOD

(C1121)

ANALYSIS RESULT

MCL VIOLATED

(C1125)



FRDS - II RECORD DELETION FORM

Batch Date

MO 08 DAY 16 YR 88

RECORD TO BE DELETED

QUALIFIER 1	QUALIFIER 2	QUALIFIER 3	ACTION CODE	DATA BASE RECORD
A3 PWS ID State ID Number (C101)	ADDRESS ID (C301)		D	(C300) ADDRESS
B1 PWS ID State ID Number (C101)	SE ID (C401)		D	(C400) SOURCE/ENTITY
B2 PWS ID State ID Number (C101)	SE ID (C401)	TREATMENT ID (C481)	D	(C480) TREATMENT
C1 PWS ID State ID Number (C101)	GA ID (C501)		D	(C500) GEOGRAPHIC AREAS SERVED
C2 PWS ID State ID Number (C101)	SERV ID (C601)		D	(C600) SERVICE AREA
C3 PWS ID State ID Number (C101)	VISIT ID (C701)		D	(C700) ON-SITE VISIT
D1 PWS ID State ID Number (C101)	VIOLATION ID FY ID NUMBER (C1101)		D	(C1100) VIOLATION
E1 PWS ID State ID Number (C101)	ENFORCEMENT ID FY ID NUMBER (C1201)		D	(C1200) ENFORCEMENT
F1 PWS ID State ID Number (C101)	VE ID FY ID NUMBER (C3001)		D	(C3000) VARIANCES, EXEMPTIONS & OTHER RELATED DATA
F2 PWS ID State ID Number (C101)	VE ID FY ID NUMBER (C3001)	SCHED ID (C3101)	D	(C3100) VE SCHEDULE
G1 PWS ID State ID Number (C101)	SDD ID (C4001)		D	(C4000) STATE DISCRETIONARY DATA

Sample Data Transfer File Records - FORM D

1-2	3-11	12-18	19-25	26	27-31	32-71	75-8
D1	RI1583811	8600006		M	C1107	100185	081388

D1	RI1583811	8600006		D	C1100		081688
----	-----------	---------	--	---	-------	--	--------

DATA CAPTURE FORM E
EXAMPLE 1

The objective of both examples on page A40 is to Insert Enforcement Data for PWS RI1583811. Data for two Enforcement IDs for one PWS has been collected on one Data Capture Form, with the same Batch Date.

SECTION E - ENFORCEMENT DATA

The ID for this Enforcement (8600001) has been assigned by the user. The Follow-up Action that was taken and is being reported (FG) is a Formal Action, State Issued Public Notification. The date on which the Enforcement Action was taken by the state against PWS RI1583811, was March 1, 1986. The Associated Violation ID (entered in Y5000) for this enforcement (i.e., the violation for which the enforcement action was taken) is 8600006.

EXAMPLE 2

SECTION E1 - ENFORCEMENT DATA

Enforcement 8600002, against Violation 8600007, was also a Formal Action, State Issued Public Notification. The date the enforcement action was taken was April 1, 1986.



U.S. ENVIRONMENTAL
PROTECTION AGENCY

Public Water System Data Capture Form E

PWS ID

ACTION CODE

BATCH DATE

State ID Number
R I / 583811
(C101)

I

I = Insert M = Modify

04/15/87

ENFORCEMENT DATA

E1

ENFORCEMENT ID
FY ID NUMBER
86000011
(C1201)

FOLLOW-UP
ACTION
FG
(C1205)

ENFORCEMENT DATE
MO DAY YR
030186 +
(C1203)

ASSOCIATED VIOLATION RANGE

BEGIN END
MO DAY YR MO DAY YR
(X5000)

OR

ASSOCIATED VIOLATION IDS

VIOLATION ID 1 VIOLATION ID 2 VIOLATION ID 3 VIOLATION ID 4
FY ID NUMBER FY ID NUMBER FY ID NUMBER FY ID NUMBER
8600006 **(Y5000)**

OR

ASSOCIATED VIOLATION CONTAMINANT GROUPS

COMPLIANCE PERIOD BEGIN DATE COMPLIANCE PERIOD BEGIN DATE COMPLIANCE PERIOD BEGIN DATE
TYPE CONTAMINANT MO DAY YR TYPE CONTAMINANT MO DAY YR TYPE CONTAMINANT MO DAY YR
(Z5000)

ENFORCEMENT DATA

E1

ENFORCEMENT ID
FY ID NUMBER
86000021
(C1201)

FOLLOW-UP
ACTION
FG
(C1205)

ENFORCEMENT DATE
MO DAY YR
040186 +
(C1203)

ASSOCIATED VIOLATION RANGE

BEGIN END
MO DAY YR MO DAY YR
(X5000)

OR

ASSOCIATED VIOLATION IDS

VIOLATION ID 1 VIOLATION ID 2 VIOLATION ID 3 VIOLATION ID 4
FY ID NUMBER FY ID NUMBER FY ID NUMBER FY ID NUMBER
8600007 **(Y5000)**

OR

ASSOCIATED VIOLATION CONTAMINANT GROUPS

COMPLIANCE PERIOD BEGIN DATE COMPLIANCE PERIOD BEGIN DATE COMPLIANCE PERIOD BEGIN DATE
TYPE CONTAMINANT MO DAY YR TYPE CONTAMINANT MO DAY YR TYPE CONTAMINANT MO DAY YR
(Z5000)

Sample Data Transfer File Records - FORM E

2	3-11	12-18	19-25	26	27-31	32-71	75-80
1	RI1583811	8600001		I	C1205	FG	041587
E1	RI1583811	8600001		I	C1203	030186	041587
E1	RI1583811	8600001		I	Y5000	8600006	041587
E1	RI1583811	8600002		I	C1205	FG	041587
E1	RI1583811	8600002		I	C1203	040184	041587
E1	RI1583811	8600002		I	Y5000	8600007	041587

DATA CAPTURE FORM E
EXAMPLE 3

The objective of the example on page A43 is to show that whenever an Associated Violation Range (X5000) is employed to establish a linkup with applicable violation records, the violation end date need not be specified: the system will always use the ENFORCEMENT DATE submitted as the ASSOCIATED VIOLATION RANGE End Date whenever the end date is not specified.

SECTION E1 - ENFORCEMENT DATA

The user wishes to apply this formal Follow-up Action, F2 (Civil Action Filed) to all violations occurring within the violation range of July 1, 1986 and June 30, 1987. Since the end date was not specified, the system will assume the end date to be the same as the enforcement date.

Sample Data Transfer File Records - FORM E

1-2	3-11	12-18	19-25	26	27-31	32-71	75-80
1	RI1583811	8600003		I	C1203	063087	081587

E1	RI1583811	8600003		I	C1205	F2	081587
----	-----------	---------	--	---	-------	----	--------

E1	RI1583811	8600003		I	X5000	070186	081587
----	-----------	---------	--	---	-------	--------	--------

DATA CAPTURE FORM E
EXAMPLE 4

The objective of the example on Page A46 is to add an Associated Violation Range (i.e., to apply this Enforcement Action against all violations reported against this PWS whose compliance period began sometime within the date range specified) to an existing Enforcement. This is done as Modify Action.

SECTION E1 - ENFORCEMENT DATA

We are modifying Enforcement 8600002 for PWS RI583811, to establish linkages to all the violations that were reported against this PWS that had violation dates in the Range of October 1, 1986 - September 30, 1987.

Note: Since no violation for this PWS falls into this date range, (Violation ID 8600006 Compliance Period ended September 30, 1986) this transaction will NOT create a link to any existing violation.

DATA CAPTURE FORM E
EXAMPLE 5-6

The objective of the example on page A48 is to show how to Modify enforcement related data already in FRDS-II. The first example (Example 5) changes the existing Enforcement Date. The next example (Example 6) adds two more Associated Violation IDs to those already existing for this Enforcement.

EXAMPLE 5

SECTION E1 - ENFORCEMENT DATA

The Enforcement Date for 8600001 of PWS RI1583811 was erroneously inserted as March 1, 1986. In this Modify example, we are changing the date to June 15, 1986.

EXAMPLE 6

SECTION E1 - ENFORCEMENT DATA

Two additional violations are to be associated with the Enforcement Action 8600002 for PWS RI1583811. Violation IDs 8600008 and 8600009 were unintentionally omitted in the original submission; they are entered as Modify transactions to correct this oversight.

RECORD DELETION FORM

SECTION E1 - ENFORCEMENT DATA

The example on Page A49 shows how to delete a C1200 (Enforcement Data) Data Base Record (DBR) from FRDS-II. Note that all values previously reported for this enforcement record and all linkages to its related violations will be removed with this single command.



U.S. ENVIRONMENTAL
PROTECTION AGENCY

Public Water System Data Capture Form E

PWS ID

ACTION CODE

BATCH DATE

State ID Number
RI1583811
(C101)

M I = Insert M = Modify

08/18/88

ENFORCEMENT DATA

E1

ENFORCEMENT ID
FY ID NUMBER
8600001
(C1201)

FOLLOW-UP
ACTION
1
(C1205)

ENFORCEMENT DATE
MO DAY YR
06/19/86 +
(C1203)

ASSOCIATED VIOLATION RANGE								
BEGIN			END					
MO	DAY	YR	MO	DAY	YR			

(X5000)

OR

ASSOCIATED VIOLATION IDS

VIOLATION ID 1		VIOLATION ID 2		VIOLATION ID 3		VIOLATION ID 4	
FY	ID NUMBER	FY	ID NUMBER	FY	ID NUMBER	FY	ID NUMBER

(Y5000)

OR

ASSOCIATED VIOLATION CONTAMINANT GROUPS

TYPE		CONTAMINANT		COMPLIANCE PERIOD BEGIN DATE			TYPE		CONTAMINANT		COMPLIANCE PERIOD BEGIN DATE			TYPE		CONTAMINANT		COMPLIANCE PERIOD BEGIN DATE		
				MO	DAY	YR					MO	DAY	YR					MO	DAY	YR

(Z5000)

ENFORCEMENT DATA

E1

ENFORCEMENT ID
FY ID NUMBER
8600002
(C1201)

FOLLOW-UP
ACTION
1
(C1205)

ENFORCEMENT DATE
MO DAY YR
06/19/86 +
(C1203)

ASSOCIATED VIOLATION RANGE								
BEGIN			END					
MO	DAY	YR	MO	DAY	YR			

(X5000)

OR

ASSOCIATED VIOLATION IDS

VIOLATION ID 1		VIOLATION ID 2		VIOLATION ID 3		VIOLATION ID 4	
FY	ID NUMBER	FY	ID NUMBER	FY	ID NUMBER	FY	ID NUMBER
86	00008	86	00009				

(Y5000)

OR

ASSOCIATED VIOLATION CONTAMINANT GROUPS

TYPE		CONTAMINANT		COMPLIANCE PERIOD BEGIN DATE			TYPE		CONTAMINANT		COMPLIANCE PERIOD BEGIN DATE			TYPE		CONTAMINANT		COMPLIANCE PERIOD BEGIN DATE		
				MO	DAY	YR					MO	DAY	YR					MO	DAY	YR

(Z5000)



FRDS - II RECORD DELETION FORM

Batch Date

RECORD TO BE DELETED

MO DAY YR
10 8 20 89

QUALIFIER 1	QUALIFIER 2	QUALIFIER 3	ACTION CODE	DATA BASE RECORD
A3 PWS ID State ID Number (C101)	ADDRESS ID (C301)		D (C300) ADDRESS	
B1 PWS ID State ID Number (C101)	SE ID (C401)		D (C400) SOURCE/ENTITY	
B2 PWS ID State ID Number (C101)	SE ID (C401)	TREATMENT ID (C481)	D (C480) TREATMENT	
C1 PWS ID State ID Number (C101)	GA ID (C601)		D (C500) GEOGRAPHIC AREAS SERVED	
C2 PWS ID State ID Number (C101)	SERV ID (C601)		D (C600) SERVICE AREA	
C3 PWS ID State ID Number (C101)	VISIT ID (C701)		D (C700) ON-SITE VISIT	
D1 PWS ID State ID Number (C101)	VIOLATION ID ID NUMBER (C1101)		D (C1100) VIOLATION	
E1 PWS ID State ID Number (C101)	ENFORCEMENT ID ID NUMBER (C1201)		D (C1200) ENFORCEMENT	
F1 PWS ID State ID Number (C101)	VE ID ID NUMBER (C3001)		D (C3000) VARIANCES, EXEMPTIONS & OTHER RELATED DATA	
F2 PWS ID State ID Number (C101)	VE ID ID NUMBER (C3001)	SCHED ID (C3101)	D (C3100) VE SCHEDULE	
G1 PWS ID State ID Number (C101)	SDO ID (C4001)		D (C4000) STATE DISCRETIONARY DATA	

Sample Data Transfer File Records - FORM E

1-2	3-11	12-18	19-25	26	27-31	32-71	75-80
E1	RI1583811	8600002		M	X5000	100186093087	060188
E1	RI1583811	8600001		M	C1203	061586	081888
E1	RI1583811	8600002		M	Y5000	86000088600009	081888
E1	RI1583811	8600001		D	C1200		082088

DATA CAPTURE FORM F
EXAMPLE 1

The objective of the example on Page A52 is to show how to Insert Variance, Exemption and Other Related Data for PWS RI1583811. A VE Schedule is also included in Example 2. In all cases the user has assigned his/her own IDs.

SECTION F1 - VARIANCES, EXEMPTIONS & OTHER RELATED DATA

The user has supplied the VE ID of 8600001 to identify an Exception that was granted for Nitrite (Contaminant 1040) for PWS RI1583811.

This exemption became effective on January 1, 1987 and will expire on December 3, 1988.

DATA CAPTURE FORM F
EXAMPLE 2

SECTION F1 - VARIANCES, EXEMPTIONS & OTHER RELATED DATA

The user has expressed an interest in an Other exemption (Status A) for Arsenic (Contaminant 1005) by specifying a Record Type of OT (Other), a modified MCL value of .4 and an Alternate Process of 360 (Flocculation). He/she has supplied the VE ID of 8600701 for this record. The reason for the variance being requested (007) is due to Facility Construction that is Pending.

This exemption became effective on August 31, 1980 and will expire on December 31, 1988.

SECTION F2 - VE SCHEDULE

For the VE-ID 8600701, the user has identified a schedule that calls for the Treatment System Design (Scheduled Action Code 007) to be completed by November 30, 1987.



Public Water System Data Capture Form F

State **RI** PWS ID **1583811**
(C101)

ACTION CODE **I**
I = Insert M = Modify

BATCH DATE **10/4/87**

VARIANCES, EXEMPTIONS & OTHER RELATED DATA

F1

FY	VE ID ID NUMBER	CONTAMINANT	RECORD TYPE	EFFECTIVE DATE MO DAY YR	EXPIRATION DATE MO DAY YR
86	00001	1040	EX	010187	123187
(C3001)	(C3003)	(C3005)	(C3007)	(C3008)	

STATUS CODE	MODIFIED MCL	TREATMENT PROCESS	ALTERNATE PROCESS	REASON
(C3011)	(C3013)	(C3015)	(C3017)	(C3019)

F2

VE SCHEDULE

FY	VE ID ID NUMBER	SCHEDULE ID	ACTION	SCHEDULED DATE MO DAY YR	ACCOMPLISHED DATE MO DAY YR
(C3001)	(C3101)	(C3103)	(C3105)	(C3107)	

VARIANCES, EXEMPTIONS & OTHER RELATED DATA

F1

FY	VE ID ID NUMBER	CONTAMINANT	RECORD TYPE	EFFECTIVE DATE MO DAY YR	EXPIRATION DATE MO DAY YR
86	00701	10051	07	083180	123188
(C3001)	(C3003)	(C3005)	(C3007)	(C3008)	

STATUS CODE	MODIFIED MCL	TREATMENT PROCESS	ALTERNATE PROCESS	REASON
(C3011)	(C3013)	(C3015)	(C3017)	(C3019)

F2

VE SCHEDULE

FY	VE ID ID NUMBER	SCHEDULE ID	ACTION	SCHEDULED DATE MO DAY YR	ACCOMPLISHED DATE MO DAY YR
86	00701	011	28	113087	
(C3001)	(C3101)	(C3103)	(C3105)	(C3107)	

Sample Data Transfer File Records - FORM F

1-2	3-11	12-18	19-25	26	27-31	32-71	75-80
	RI1583811	8600001		I	C3003	1040	1041587
F1	RI1583811	8600001		I	C3005	EX	1041587
F1	RI1583811	8600001		I	C3007	010187	1041587
F1	RI1583811	8600001		I	C3009	123187	1041587
F1	RI1583811	8600701		I	C3003	1005	1041587
F1	RI1583811	8600701		I	C3005	OT	1041587
F1	RI1583811	8600701		I	C3007	083180	1041587
F1	RI1583811	8600701		I	C3009	123187	1041587
F1	RI1583811	8600701		I	C3013	.40000000	1041587
F1	RI1583811	8600701		I	C3017	360	1041587
F1	RI1583811	8600701		I	C3019	007	1041587
F2	RI1583811	8600701	01	I	C3103	28	1041587
F2	RI1583811	8600701	01	I	C3105	113087	1041587

DATA CAPTURE FORM G
EXAMPLES 1-3

The objective of the examples on this data capture form is to provide some indication as to how a privacy agency can store pertinent data, concerning a specific PWS, for which no data element has been assigned in FRDS-II. The State Discretionary Data (SDD) entered on FORM G follows a "Parameter - Value" method of storing such data. It is essentially the user's "file drawer" in which he/she can store values for named data items. It is the user's responsibility to assign SDD names (or codes) that are meaningful to him/her so that subsequent retrieval of this data will also be meaningful.

EXAMPLE 1

SECTION G1 - STATE DISCRETIONARY DATA

The user wants to identify the Sanitary Engineer who is currently responsible for PWS RI1583811. C4003 is the named data item (or parameter) Sanitary Engineer, while the alphanumeric value stored in State Discretionary Value (C4005) is the name of the Sanitary Engineer, John Smith.

EXAMPLE 2

SECTION G1 - STATE DISCRETIONARY DATA

The user wants to record the wholesale population served for the same PWS. Since this is a numeric field, he/she enters the named value in C4007 (QUANTITY) instead of C4005 as above. (This would permit the possibility of future computation on this field which could not be done if C4005 were used to store the value).

EXAMPLE 3

SECTION G1 - STATE DISCRETIONARY DATA

In this example, the user wishes to record the fact that on May 30, 1987, PUMP-1 was replaced at the PWS. Since this is a Date value, it is entered in C4009 (DATE). The SDD NAME chosen to identify this value is: Pump-1 Replacement Date.



U.S. ENVIRONMENTAL
PROTECTION AGENCY

Public Water System Data Capture Form G

PWS ID

ACTION CODE

BATCH DATE

State ID Number
RI 1583811
(C101)

I I = Insert M = Modify

08/15/87
MO DAY YR

G1		STATE DISCRETIONARY DATA	
SDD ID	STATE DISCRETIONARY DATA NAME		
G01 (C4001)	SANITARY ENGINEER (C4003)		
STATE DISCRETIONARY VALUE			
JOHN SMITH (C4005)			
QUANTITY		DATE MO DAY YR	
. (C4007)		08/15/87 (C4009)	

G1		STATE DISCRETIONARY DATA	
SDD ID	STATE DISCRETIONARY DATA NAME		
G02 (C4001)	WHOLESALE POPULATION (C4003)		
STATE DISCRETIONARY VALUE			
150. (C4005)			
QUANTITY		DATE MO DAY YR	
150. (C4007)		08/15/87 (C4009)	

G1		STATE DISCRETIONARY DATA	
SDD ID	STATE DISCRETIONARY DATA NAME		
G03 (C4001)	PUMP-1 REPLACEMENT DATE (C4003)		
STATE DISCRETIONARY VALUE			
05/13/87 (C4005)			
QUANTITY		DATE MO DAY YR	
. (C4007)		05/13/87 (C4009)	

G1		STATE DISCRETIONARY DATA	
SDD ID	STATE DISCRETIONARY DATA NAME		
 (C4001)	 (C4003)		
STATE DISCRETIONARY VALUE			
 (C4005)			
QUANTITY		DATE MO DAY YR	
. (C4007)		 (C4009)	

Sample Data Transfer File Records - FORM G

1-2	3-11	12-18	19-25	26	27-31	32-71	75-80
31	RI1583811	G01		I	C4003	SANITARY ENGINEER	081587
G1	RI1583811	G01		I	C4005	JOHN SMITH	081587
G1	RI1583811	G02		I	C4003	WHOLESALE POPULATION	081587
G1	RI1583811	G02		I	C4007	150	081587
G1	RI1583811	G03		I	C4003	PUMP-1 REPLACEMENT DATE	081587
G1	RI1583811	G02		I	C4009	053087	081587

FRDS-II Edit/Update Processing

January 9, 1989

FRDS- II Edit/Update Processing

The FRDS II Edit program accepts data in the FRDS II Data Transfer File format (DTF) , and validates that the data adheres to the rules defined the Data Element Dictionary and Data Entry Instructions. Data that is determined to adequately meet the specifications is passed to the FRDS-II Update program via the FRDS-II Edited Data File. All rejected data is recorded in the FRDS-II Edit Error File for processing by the FRDS-II Error program. Each anomaly detected by the Edit program is identified within the FRDS-II Edit Error File, unless it is Execution Fatal to the Edit program. The reason for abnormal terminations and/or pertinent execution statistics are printed on the Edit Control Totals report.

Inputs to the FRDS-II Edit Process

o FRDS-II Data Transfer File

The FRDS-II Data Transfer File (DTF), as defined in the Data Entry Instructions, contains a single FRDS-II data base item within each record. The qualifiers required to identify which data base record is to be effected by the DTF record, a code identifying the effect desired and a field identifying the data item, also reside in each DTF record. The FRDS-II Edit program expects to receive the Data Transfer File in the following sequence:

- # Batch Number (major)
- # Qualifier 1 (PWS-ID)
- # Qualifier 2
- # Form ID
- # Qualifier 3
- # Action Code
- # Data Element Number (minor)

Refer to the attached Data Transfer File format and Chapter II in this document for a detailed description of this file.

o FRDS-II Data Element Dictionary Data Base

The FRDS-II Edit program accesses the application's automated Data Element Dictionary Data base indirectly, for many of the processing requirements. This information includes the Data Type, Data Item Format, and code validation tables. This information is obtained indirectly and is retained internally in the memory space of the Edit program for the entire duration of execution, precluding the need for continual access of the FRDS-II Data Element Dictionary Data Base.

o FRDS-II Data Base

Many of the validations required to verify the integrity of the input transactions necessitate reviewing the current status of the FRDS-II Data Base. The FRDS-II Edit program accesses the data base only to the minimal extent necessary to ensure the correctness of the data within the DTF Record.

FRDS- II Edit/Update Processing

Inputs from the FRDS-II Edit Process

FRDS-II Edited Data File

All transactions read from the FRDS-II Data Transfer File and deemed acceptable for processing by the FRDS-II Update program are written to the Edited Data File. The record format of this file is also in the Data Transfer File Format.

o FRDS-II Edit Error File

Those transactions read from the FRDS-II Data Transfer File and determined to be unacceptable for application to the FRDS-II Data Base, are written to the Edit Error File. The format of this file is the same as the DTF, except that each record in the Edit Error File that was determined to contain an anomaly is flagged with an embedded error code. The exact location of the error code is documented in the attached FRDS-II Edit Error File format specification. The brief description of each error condition with the associated error code, is documented in the attached FRDS-II Edit Error Conditions.

o FRDS-II Edit Control Totals

The Edit program maintains and prints various counts of DTF records processed, which facilitates manual quality assurance of the program's execution. During processing, certain erroneous situations may be encountered that are sufficiently severe that continued processing is impossible. If this is the case, the Edit program records the problem on the Edit Controls Totals Report, then terminates processing.

FRDS- II Edit/Update Processing

DATA TRANSFER FILE

FORMAT SPECIFICATION

Each Data Transfer File record is 80 characters in length and has the following format:

Definition	Positions
Form ID	1 - 2
Qualifier 1	3 - 11
Qualifier 2	12 - 18
Qualifier 3	19 - 25
Action Code	26
Data Element Number	27 - 31
Data Value	32 - 71
Reserved for FRDS-II use	72 - 74
Batch Date	75 - 80

FORM	DATA ADDRESS QUALIFIERS			ACT.	DATA		FRDS	BATCH
ID	QUAL 1	QUAL 2	QUAL 3	CODE	ELEM.	DATA	USE	DATE
						VALUE		
1-2	3-11	12-18	19-25	26	27-31	32-71	72-74	75-80

FRDS- II Edit/Update Processing

EDIT ERROR FILE

FORMAT SPECIFICATION

Each Edit Error File Record is in the same 80-character format as the Data Transfer File Format and is defined as follows:

Definition	Positions
Form ID	1 - 2
Qualifier 1	3 - 11
Qualifier 2	12 - 18
Qualifier 3	19 - 25
Action Code	26
Data Element Number	27 - 31
Data Value	32 - 71
Error Code	72 - 74
Batch Date	75 - 80

FORM ID	DATA ADDRESS QUALIFIERS			ACT. CODE	DATA ELEM. NUM.	DATA VALUE	ERROR CODE	BATCH DATE
	QUAL 1	QUAL 2	QUAL 3					
1-2	3-11	12-18	19-25	26	27-31	32-71	72-74	75-80

