



Superfund Record of Decision:

Stewco, TX

ENVIRONMENTAL
PROTECTION
AGENCY
DALLAS, TEXAS
LIBRARY

REPORT DOCUMENTATION PAGE		1. REPORT NO. EPA/ROD/R06-88/038	2.	3. Recipient's Accession No.
4. Title and Subtitle SUPERFUND RECORD OF DECISION Stewco, TX First Remedial Action - Final			5. Report Date 09/16/88	
7. Author(s)			8. Performing Organization Rept. No.	
9. Performing Organization Name and Address			10. Project/Task/Work Unit No.	
			11. Contract(C) or Grant(G) No. (C) (G)	
12. Sponsoring Organization Name and Address U.S. Environmental Protection Agency 401 M Street, S.W. Washington, D.C. 20460			13. Type of Report & Period Covered 800/000	
			14.	
15. Supplementary Notes				
16. Abstract (Limit: 200 words) The Stewco site, previously a tanker truck terminal and truck washing facility, is located in northeastern Texas, in Eastern Harrison County, south of the city limits of Waskom. The site consists of two nonadjacent locations approximately one mile apart, referred to as Location 1 and Location 2. Location 1 is a one-half acre plot that includes a maintenance shop with fueling facilities, a truck-tank washing facility, and two backfilled and capped evaporation ponds (ponds 1 and 2) that received wastewater from the tank washing operation. Approximately 50 homes are located within one-half mile of Location 1, four of these are within 500 feet of the north, west and south site boundaries. In addition, shallow wells are located approximately one mile to the north. Location 2 consists of a third pond which received excess wastewater conveyed by truck from the evaporation ponds at Location 1. Approximately 30 homes are within a one-half mile radius of Location 2. Land use within a one mile radius of the two locations includes residential, recreation, industrial, and commercial. The underlying Wilcox aquifer serves the city of Waskom as well as numerous domestic users within a three mile radius of the site. From 1972 - 1979, R.A. Corbett Transport, Inc. owned, operated and maintained a (See Attached Sheet)				
17. Document Analysis a. Descriptors Record of Decision Site Name Remedial Action Contaminated Media: Key Contaminants: b. Identifiers/Open-Ended Terms c. COSATI Field/Group				
18. Availability Statement		19. Security Class (This Report) None		21. No. of Pages
		20. Security Class (This Page) None		22. Price

16. ABSTRACT (continued)

fleet of transport trucks engaged in contract hauling for the oil and gas industry and various businesses. Stewco purchased the site in 1979 and continued operations until declaring bankruptcy in 1983. Materials hauled included glue, resin, gasoline, diesel, jet fuel, and creosote. The wastewater generated from washing the outside of trucks, and the tank residue resulting from steam cleaning the inside of the tankers were directed to pond 1 with overflow entering pond 2, and the surplus transported to the third pond at Location 2. All ponds were unlined. Reports from the Texas Water Commission files indicate numerous instances of noncompliance with permit requirements. After abandonment in 1983, ponds 1 and 2 began to overflow their dikes creating a serious threat of dike collapse and significant hazardous substances release. Consequently, EPA conducted a removal action at Location 1 from March 31 to April 14, 1984. The action consisted of removing the source of contamination: 400,000 gallons of liquid wastes were pumped, treated, and discharged; and 5,500 yd³ of sludges from the bottom and sides of the disposal ponds were stabilized and disposed of offsite. The pond disposal area was then backfilled and capped. No removal or remedial actions were taken at Location 2 since the level of contamination was much less than that of Location 1 and the pond was not filled near capacity. The contaminants of concern prior to the removal action were VOCs, PAHs, and phthalates.

EPA determined that, based on the effectiveness of the previous removal action, the residual contamination remaining in the soil, pond sediments, and ground water poses no threat to public health, and that no long-term monitoring is necessary. Therefore, no further action will be taken at this site. However, ground water contamination has been identified that is not attributed to the site. Follow-up actions by the State and EPA will attempt to determine the source of this contamination. If within 2 years of the signing of this ROD, wells onsite at Stewco are determined to be of no use to the offsite source investigation, closure will be initiated. The cost of plugging the 16 wells is estimated not to exceed \$5,000.

PERFORMANCE STANDARDS OR GOALS: Chemical-specific goals met by this no action remedy were not specified.

INSTITUTIONAL CONTROLS: Not applicable.

KEYWORDS: No Action Remedy.

RECORD OF DECISION

FOR

STEWCO, INC. SITE

WASKOM
HARRISON COUNTY, TEXAS

— SEPTEMBER 1988

TABLE OF CONTENTS

I.	DECLARATION BY THE REGIONAL ADMINISTRATOR	
II.	DECISION SUMMARY	
A.	SITE LOCATION & DESCRIPTION	1
	1. Location 1 Description	
	2. Location 2 Description	
	3. Site History and Enforcement Activities	
B.	LAND USE and NATURAL RESOURCES	5
	1. Geology	
	2. Hydrogeology	
	3. Surface Water Hydrology	
C.	REMEDIAL INVESTIGATION RESULTS	12
	1. Location 1 - Soils, Surface Water, Groundwater	
	2. Location 2 - Soils, Surface Water, Groundwater	
	3. Site Risk Assessment Summary	
D.	RESPONSE ACTION	24
	1. No Further Remediation	
	2. Statutory Determination	
	3. Documentation of Significant Changes	
E.	COMMUNITY RELATIONS	26
III.	RESPONSIVENESS SUMMARY	
VI.	APPENDICES	
	A - Administrative Record Index	

LIST of FIGURES

	<u>Page</u>
1 - Site Location Map	2
2 - Site Map, Location 1	3
3 - Site Map, Location 2	4
4 - Geologic Outcrop	7
5 - Geologic Cross Section, Location 1	9
6 - Geologic Cross Section, Location 2	10
7 - Residential Well Locations	11

LIST of TABLES

	<u>Page</u>
TABLE 1: Primary Chemicals - Stewco Location 1	14
TABLE 2: Primary Chemicals - Stewco Location 2	15
TABLE 3: Comparison of ARARS, Location 1	16
TABLE 4: Comparison of ARARS, Location 2	17
TABLE 5: Excess Lifetime Cancer Risks, Location 1	23
TABLE 6: Excess Lifetime Cancer Risks, Location 2	24

DECLARATION
STEWCO, INCORPORATED
RECORD OF DECISION

September, 1988

SITE NAME AND LOCATION

Stewco, Incorporated is located in Waskom, Harrison County, Texas.

STATEMENT OF PURPOSE

This decision document represents the rationale for determining that no further remedial action is warranted under Superfund for the Stewco site. This decision is in accordance with the Comprehensive Environmental Response, Compensation, and Liability Act of 1980 (CERCLA) as amended by the Superfund Amendments and Reauthorization Act of 1986 (SARA), and the National Contingency Plan (40 CFR Part 300).

STATEMENT OF BASIS

This decision is based upon the administrative record for the Stewco, Incorporated Superfund Site. The attached index (Appendix A) identifies the items which comprise the administrative record.

Based upon the findings in the Remedial Investigation for this site, the residual contamination remaining in subsurface soils, pond sediments, and groundwater (following the 1984 Emergency Response Action) pose no public health threats. However, groundwater contamination has been identified that is not attributed to the site. Although the groundwater is a potential drinking water source, Class II B Aquifer, no private wells are located immediately downgradient of the site at this time. Follow-up actions by other programs within both the State and EPA will attempt to determine the source of this contamination.

The Agency for Toxic Substances and Disease Registry (ATSDR) has been consulted and supports this conclusion.

DECLARATION
STEWCO, INCORPORATED
RECORD OF DECISION

September, 1988

SITE NAME AND LOCATION

Stewco, Incorporated is located in Waskom, Harrison County, Texas.

STATEMENT OF PURPOSE

This decision document represents the rationale for determining that no further remedial action is warranted under Superfund for the Stewco site. This decision is in accordance with the Comprehensive Environmental Response, Compensation, and Liability Act of 1980 (CERCLA) as amended by the Superfund Amendments and Reauthorization Act of 1986 (SARA), and the National Contingency Plan (40 CFR Part 300).

STATEMENT OF BASIS

This decision is based upon the administrative record for the Stewco, Incorporated Superfund Site. The attached index (Appendix A) identifies the items which comprise the administrative record.

Based upon the findings in the Remedial Investigation for this site, the residual contamination remaining in subsurface soils, pond sediments, and groundwater (following the 1984 Emergency Response Action) pose no public health threats. However, groundwater contamination has been identified that is not attributed to the site. Although the groundwater is a potential drinking water source, Class II B Aquifer, no private wells are located immediately downgradient of the site at this time. Follow-up actions by other programs within both the State and EPA will attempt to determine the source of this contamination.

The Agency for Toxic Substances and Disease Registry (ATSDR) has been consulted and supports this conclusion.

6H-ST:CADUDDLE-KALERI,yh:9/7/88:doc#2

6H-ST

HITT

6H-ST

EDWARD

6H-ST

STOKES

6H

GERSH

6H

DAVIS

DESCRIPTION OF SELECTED REMEDIAL ACTION

- o Based on the completeness of the previous removal action, no further remediation is necessary for the Stewco site. Although long-term monitoring is not required, groundwater wells will not be closed out at this time. If the wells can be of no use to the off-site source investigations during the following two years, then closure will be initiated.
- o Potential off-site and/or active facilities which appear to be contributing to groundwater contamination in the area of the site will be further investigated by other programs within both the State and EPA.
- o If new information from the off-site source investigations correlate with the current findings, that site residuals are not contributing to groundwater volatiles contamination, then deletion of the site from the National Priorities List will be pursued.

DECLARATION

Consistent with the Comprehensive Environmental Response, Compensation, and Liability Act of 1980 as amended by the Superfund Amendments and Reauthorization Act of 1986, and the National Contingency Plan, I have determined that this decision will provide adequate protection of the public health, welfare, and the environment. This decision attains Federal and State requirements that are applicable, or relevant and appropriate. In view of the 1984 source removal and based upon the lack of significant risks posed by the site, this decision is permanent and cost effective. Alternative treatment technologies were used to the maximum extent practicable during the source removal. Because no site related hazardous substances remain onsite above health based levels, the five-year facility review will not apply to Stewco.

The State of Texas has been consulted and supports this remedial decision for the Stewco, Incorporated Superfund Site. If new information obtained from the off-site investigations do not correlate with the current findings, the need for groundwater remediation will be evaluated. For such case, a Record of Decision will be prepared to address any future remedial action(s).

September 16, 1988
DATE

Robert E. Layton Jr.
Robert E. Layton Jr., P.E.
Regional Administrator

DECISION SUMMARY
STEWCO, INCORPORATED
RECORD OF DECISION

July, 1988

SITE LOCATION AND DESCRIPTION

The Stewco Site, previously a tanker truck terminal and truck washing facility, is located in Eastern Harrison County, south of the city limits of Waskom, Texas. Harrison County is located in northeastern Texas and the eastern county line borders the State of Louisiana. The site consists of two non-adjacent locations approximately one mile apart, referred to as Location 1 and Location 2. The two locations of the Stewco site are presented in Figure 1.

Location 1

Location 1 is a one-half acre plot on the east side of State Highway 9, approximately one-half mile south of the intersection of State Highway 9 and Interstate 20. Location 1 has an office and maintenance shop with fueling facilities, a truck-tank washing facility, and two backfilled and capped evaporation ponds that received wastewater from the tank washing operation prior to remedial actions. Pond 1 was 75 by 75 feet in plan by 10 feet deep, while Pond 2 was 85 by 55 feet in plan by 15 feet deep. The Location 1 site boundary includes the area surrounding the backfilled ponds and truck wash pad, as outlined on Figure 2.

Approximately 50 homes are located within one-half mile of Location 1. Four of these residences are within 500 feet of the north, west, and south site boundaries. Currently, an active gas well, oil and water separator, and associated salt-water gathering line are located immediately northwest of the "cap" area. A petroleum tank farm, the Mobil Oil Corporation-Waskom Terminal borders the site on the east. The Mobil facility consists of numerous large petroleum storage tanks and a pond immediately adjacent to the east boundary. The Texaco facility, also a petroleum storage terminal, borders Mobil on the north, northeast of the Stewco site.

Location 2

Location 2 consists of a third pond, approximately 1/4 acre in size, which received excess wastewater conveyed by truck from the evaporation ponds at Location 1. Location 2 is located approximately one mile northwest of Location 1 and about 100 yards south of Interstate 20. The pond is partially above ground and is approximately 165 feet by 60 feet in plan and 10 feet deep. The boundary of the study area for this location is limited to the pond, dike and immediate surrounding area.

Location 2 has no adjoining residences within 500 feet. Approximately 30 homes exist within one-half mile. The only structures adjacent to Location 2 are two storage tanks which hold oil and condensate from a gas production well located immediately west of the evaporation pond. The tanks are located about 40 feet south of the pond. The general layout of Location 2 is shown on Figure 3. The remaining land immediately surrounding Location 2 is undeveloped forest land.

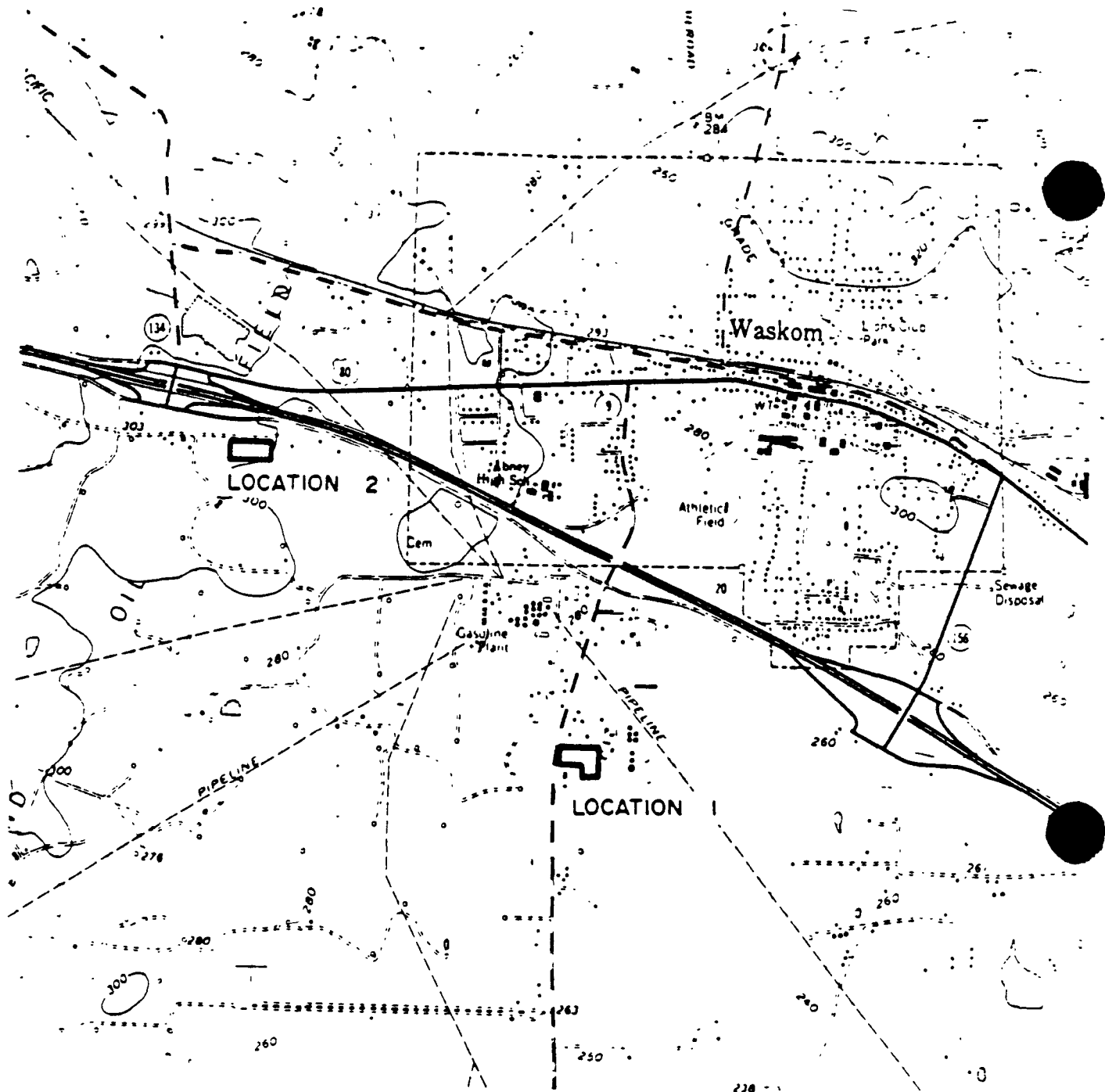

SOURCE USGS TOPOGRAPHIC MAP
WASKOM, TEX-LA QUADRANGLE
DATED 1962, PHOTOREVISED: 1969
AND 1972, SCALE 1" = 2000'

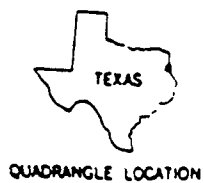

QUADRANGLE LOCATION



0 2000 4000
SCALE IN FEET

FIGURE 1
SITE LOCATION MAP
STEWCO SITE

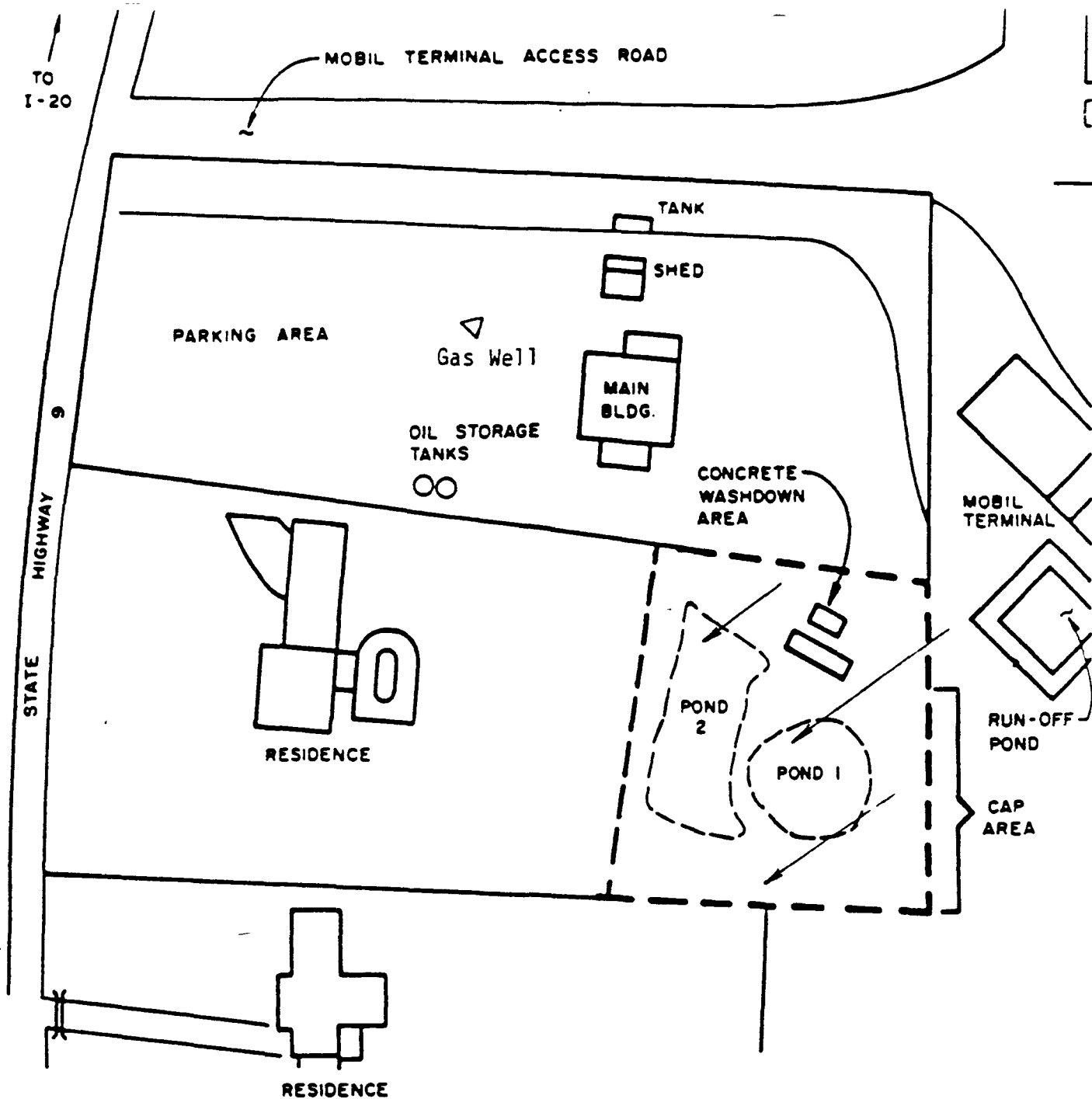

LEGEND

(---) LOCATION OF BACKFILLED
PONDS 1 AND 2

— SITE BOUNDARY

← NEAR-SURFACE GROUNDWATER FLOW DIRECTION



NOT TO SCALE

FIGURE 2
SITE MAP - LOCATION 1
STEWCO SITE

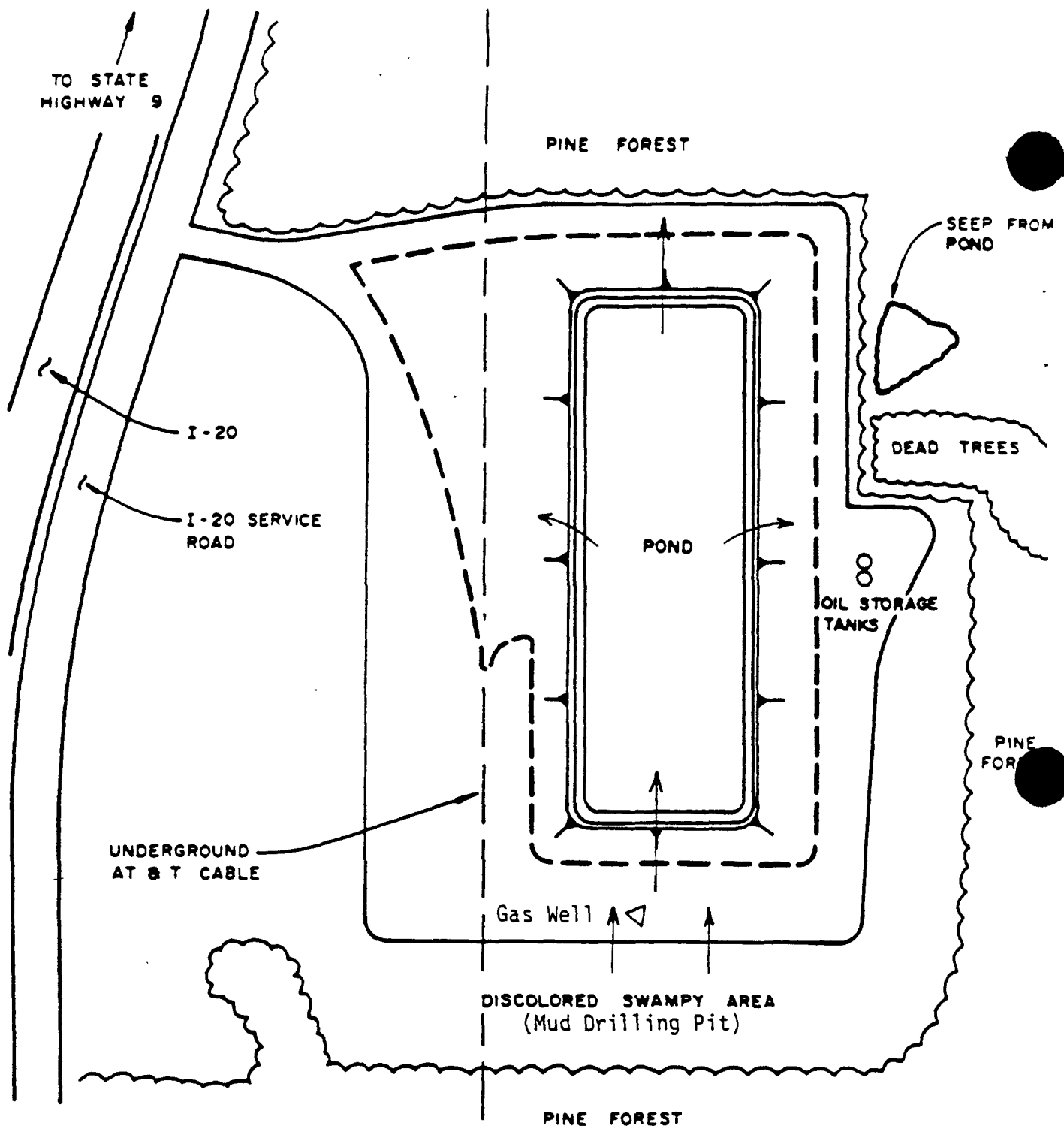

LEGEND



— — — SITE BOUNDARY

← NEAR-SURFACE GROUNDWATER FLOW DIRECTION



NOT TO SCALE

FIGURE - 3
SITE MAP - LOCATION 2
STEWCO SITE

Site History

From 1972 to 1979 R.A. Corbett Transport, Incorporated owned, operated and maintained a fleet of transport trucks engaged in contract hauling for the oil and gas industry and other businesses in the Waskom area. Materials hauled included glue, resin, gasoline, diesel, jet fuel and creosote. In July, 1979 R. A. Corbett Transport, Incorporated sold its interstate operating authority and terminal facilities to the Stewco, Incorporated Company which continued operations until declaring bankruptcy in 1983.

During active operation, wastewater was generated from high pressure washing of the outside of trucks and from steam cleaning the inside of tankers. An alkaline cleaning solution was used, making it necessary to neutralize the wastewater with acid. Wastewater and tank residue were directed to Pond 1 (154,000 gallon capacity) with overflow entering Pond 2 (270,000 gallon capacity). Surplus wastewater from these unlined ponds was trucked to a third pond (Location 2) approximately one mile away.

Field inspection reports and other correspondence concerning the site, available in the Texas Water Commission (TWC) files, formerly the Texas Department of Water Resources (TDWR), indicate numerous instances of noncompliance with permit requirements at Location 1. Violations included unauthorized surface discharges, degeneration of groundwater quality, inadequate freeboard, and inadequate operation of acid treatment mechanisms. TDWR recommended site remedial actions including the dewatering and proper disposal of evaporation pond contents and the implementation of a groundwater quality improvement program. Stewco, Inc. filed for Chapter 7 bankruptcy on May 6, 1983, with inadequate assets to conduct remedial activities. Site remedial actions recommended by the TDWR were not implemented.

Both locations were abandoned in early 1983 and the ponds continued to collect rainfall. Ponds 1 and 2 at Location 1 became full after site abandonment with a slight amount of water overflowing the dikes. This created a serious threat of dike collapse which could result in a substantial release of hazardous waste. Inspection of the site by the EPA Field Investigation Team (FIT) in November, 1983, recommended that EPA undertake removal actions.

An immediate removal action was conducted by EPA at Location 1 from March 31 to April 14, 1984. The action consisted of removing the source of contamination: 400,000 gallons of liquid wastes were pumped, treated, and discharged; 5,500 cubic yards of sludges from the bottom and sides of the disposal ponds were stabilized and trucked to the Chemical Waste Management Company Class A landfill at Port Arthur, Texas about 202 miles away. The pond disposal area was then backfilled with clean soil and a 10-mil plastic liner was placed across the area. Over the liner, two feet of compacted soil was then graded to the original site slope and seeded with bermuda grass.

No removal or remedial actions were taken at Location 2 since the level of contamination was much less than that at Location 1 and the pond was only 45% full with no evidence of dike failure.

The Stewco site, both locations, was ranked using the EPA Hazardous Ranking System in June, 1984. Although Location 1 had undergone an immediate removal action, the ranking was performed as if the removal never occurred. The site scored a 48.86 based on the potential groundwater route to the Wilcox Aquifer, which serves the City of Waskom, Texas, as well as numerous domestic users within a three mile radius of the site. At the time of ranking the constituents of concern were polynuclear aromatic hydrocarbons, phthalates, DDT, and aromatic solvents.

On November 13, 1987, the EPA committed funds to perform a Remedial Investigation at the site. Enforcement options were not available, although potentially responsible parties were notified. The Remedial Investigation fieldwork was completed in February, 1988. The results of this study were documented in the Remedial Investigation Report, completed in draft form in May 1988, and will be discussed in the remainder of the Decision Summary.

LAND USE AND NATURAL RESOURCES

Land use within a 1 mile radius of the two Stewco locations includes residential, recreational, industrial, and commercial. Natural resources in the vicinity of the site include groundwater, surface water, fish and game, arable land, forest woodlands, minerals, and oil and gas resources. The local economy is based on petroleum production, mining, timber production, cattle raising, and cotton production.

The corporate city limits of Waskom are located within a 1 mile radius of both Stewco locations as depicted on Figure 1. According to the 1980 census, the population of Harrison County is approximately 53,000. The city of Waskom is estimated at having a current population of about 2,000. Additional population not residing within the corporate limits of Waskom, but 3 miles of the Stewco locations, has been estimated at 1,300. The total number of people within a 3 mile radius of the site is approximately 3,300.

The area surrounding and on the Stewco site locations is suitable habitat for game and non-game species of wildlife. The study area can be generally characterized as rolling to hilly topography within the pine-hardwood section of the East Texas timber belt. The area has been heavily developed for oil and gas production and several oil and gas wells, pumping stations, and storage tanks are in close proximity to both Stewco locations.

Geology

The Stewco site is situated on the eastern edge of the East Texas Basin, a 15,000 square-mile area that is part of the Gulf Coastal Plain. The region is characterized by thick sediments, low-amplitude crustal warping, and some structural deformation. A broad upwarp, the Sabine Uplift, occurs beneath the Waskom area. Topography is mildly undulating, with surface elevations varying from 260 to 300 ft above Mean Sea Level (MSL).

The East Texas basin was formed by block faulting, and is filled with thick accumulations of consolidated and unconsolidated sediments, ranging from Jurassic to Tertiary in age. The strata include halite evaporate units which have produced salt domes in the center of the basin, 50 miles to the west of the site. As shown in Figure 4, strata outcropping in the

Figure 4
Geologic Outcrop Map

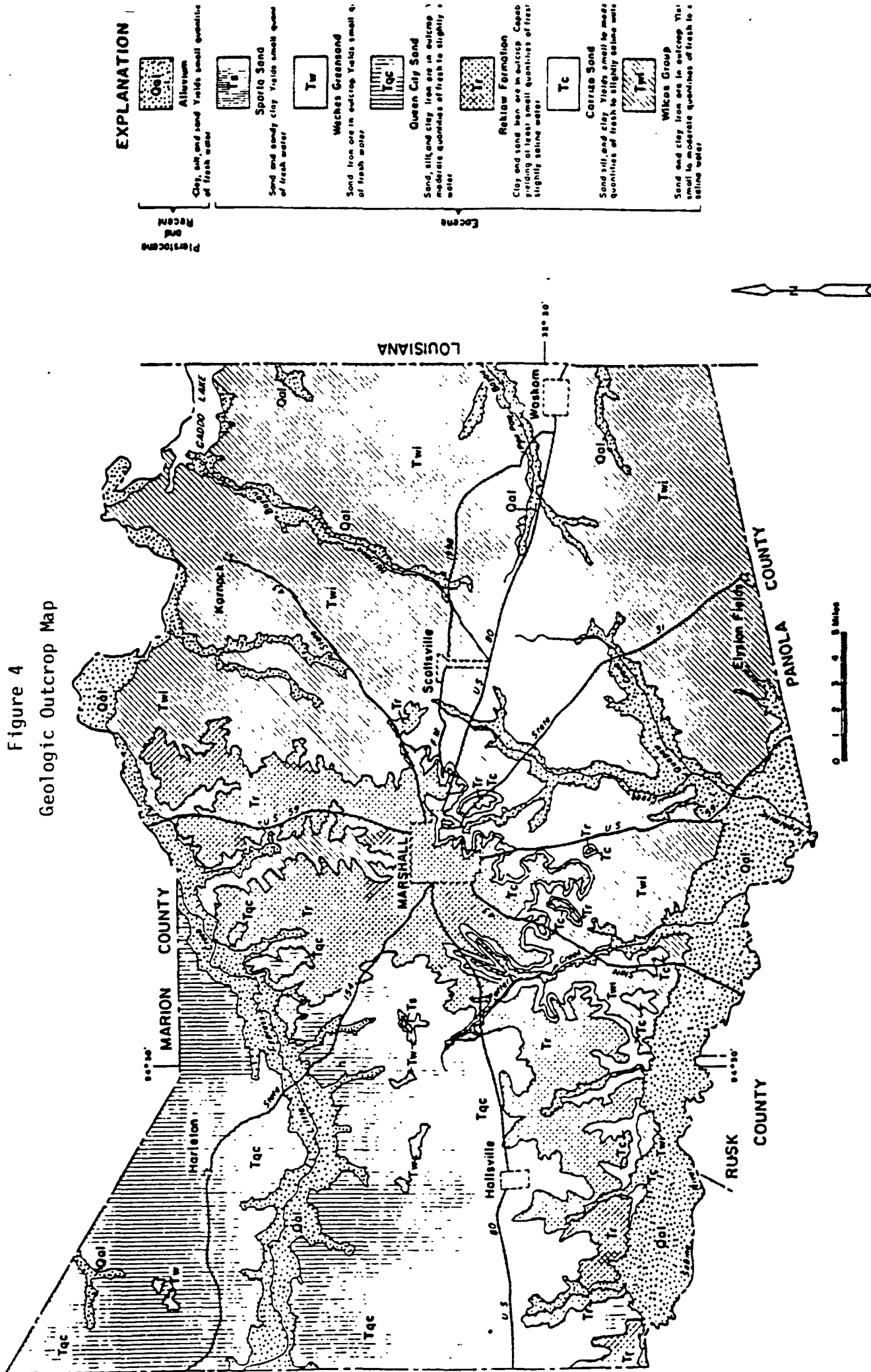

vicinity of the site belong to the Eocene Wilcox Group, which is composed of interbedded sand, silt, clay, shale, and lignite. The Wilcox Group is approximately 400 feet thick and is underlain by the finegrained Midway Group.

The distinction between consolidated and unconsolidated materials becomes uncertain due to overconsolidation of some sediments. The discontinuous nature of the strata and the distance between the two site locations requires separate characterization of Location 1 and Location 2, each having a distinctly different near surface geology--and hydrogeology. Figure 5 represents the subsurface at Location 1 and Figure 6 represents the subsurface at Location 2, as determined from the boring and well logs at each location during the Remedial Investigation fieldwork, February 1988. These figures will be discussed in the following section.

Hydrogeology

Regionally, the Wilcox Group is considered as a single aquifer for water supply purposes, even though it is stratified and heterogeneous. When considered as a single hydrologic unit, the Wilcox has an average transmissivity of 3,150 gpd/ft and an average hydraulic conductivity of 52 gpd/ft². The transmissivity is variable, depending on the relative proportion of sand to clay in the stratigraphic section. The direction of groundwater flow is related to surface topography, but is generally eastward or northeastward in east-central Harrison County. The native groundwater is a sodium bicarbonate type.

As the source of groundwater to the Waskom municipality, the Wilcox serves six pumping wells at an average daily pumping rate of between 250,000 and 300,000 gallons per day. The radius of influence for the pumping wells is not known. Both site locations are within the distribution area for municipal water. Shallow wells are located approximately 1 mile north of Location 1. A rural water authority serves the zone outside of the Waskom service area.

For site assessment purposes, the individual sand bodies within the Wilcox are considered separate aquifers. Again in reference to Figures 5 and 6, the first significant water bearing zone beneath each location differs in composition. In general, values in hydraulic conductivity in the near-surface saturated zone (both locations) are low to moderate.

Along the southern site boundary at Location 1, the near-surface aquifer extends from 9 feet down past 50 feet beneath the surface [Units B and D], Figure 5. On the northern portion of the site, the aquifer is separated into two zones by an aquitard [Unit C] which decreases in thickness from 13 feet to 0 feet [where Unit B and D form a single unconfined aquifer]. Groundwater flows beneath the site in a southwestward direction at an average rate of .05 foot/day.

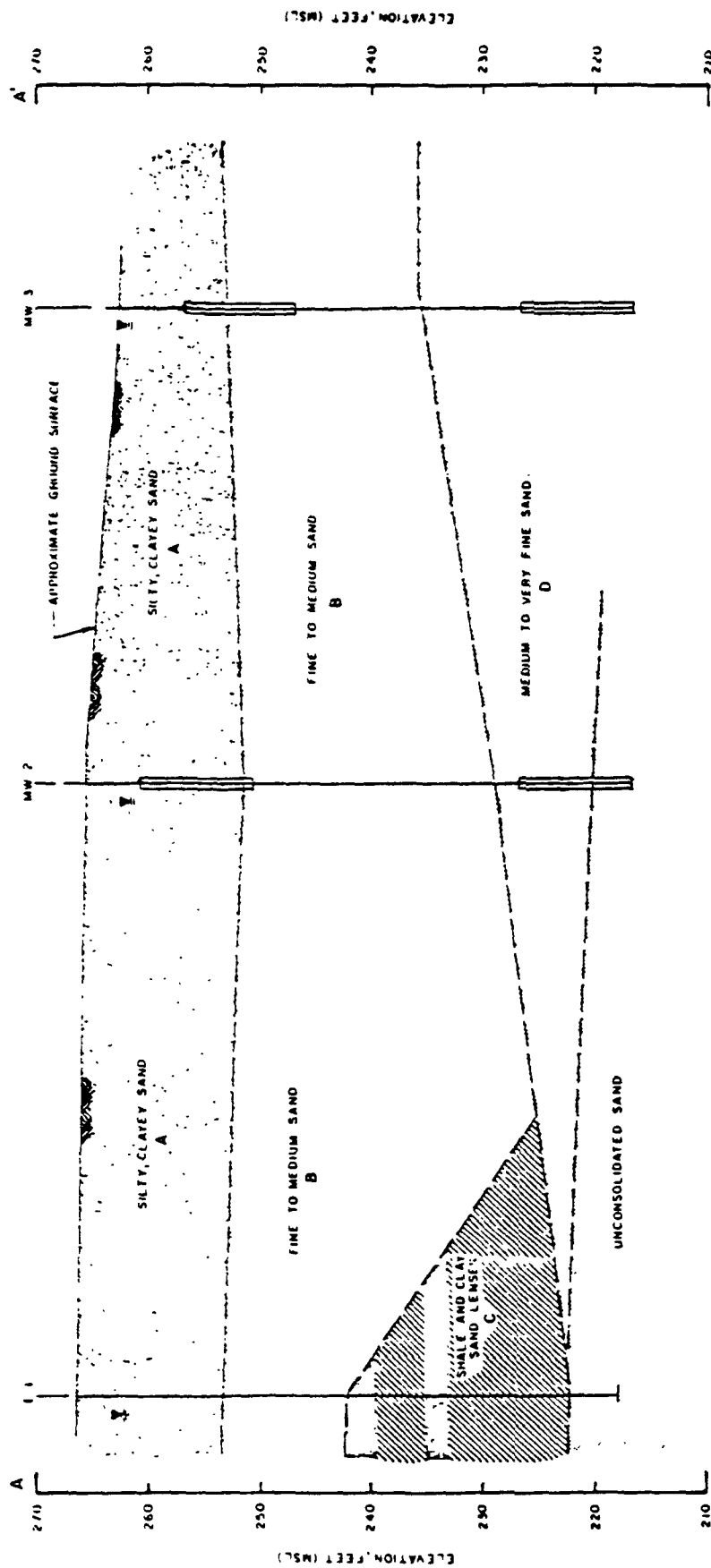

NOTE
DATA OBTAINED FROM
MONITORING WELLS AND
EXPLORATORY BORING

LEGEND
MW 2
MONITORING WELL NUMBER 2
WELL SCREEN
INFERRED STRATIGRAPHIC CONTACT
WATER TABLE

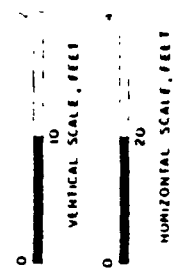
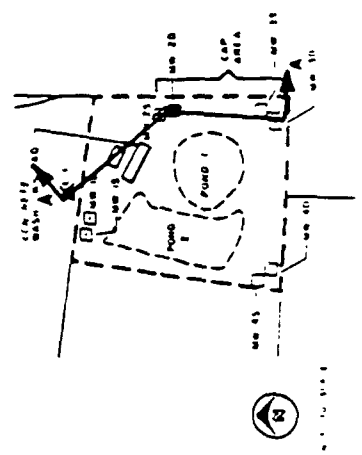

FIGURE 5
GEOLOGIC CROSS SECTION
LOCATION 1
STEWART FIELD



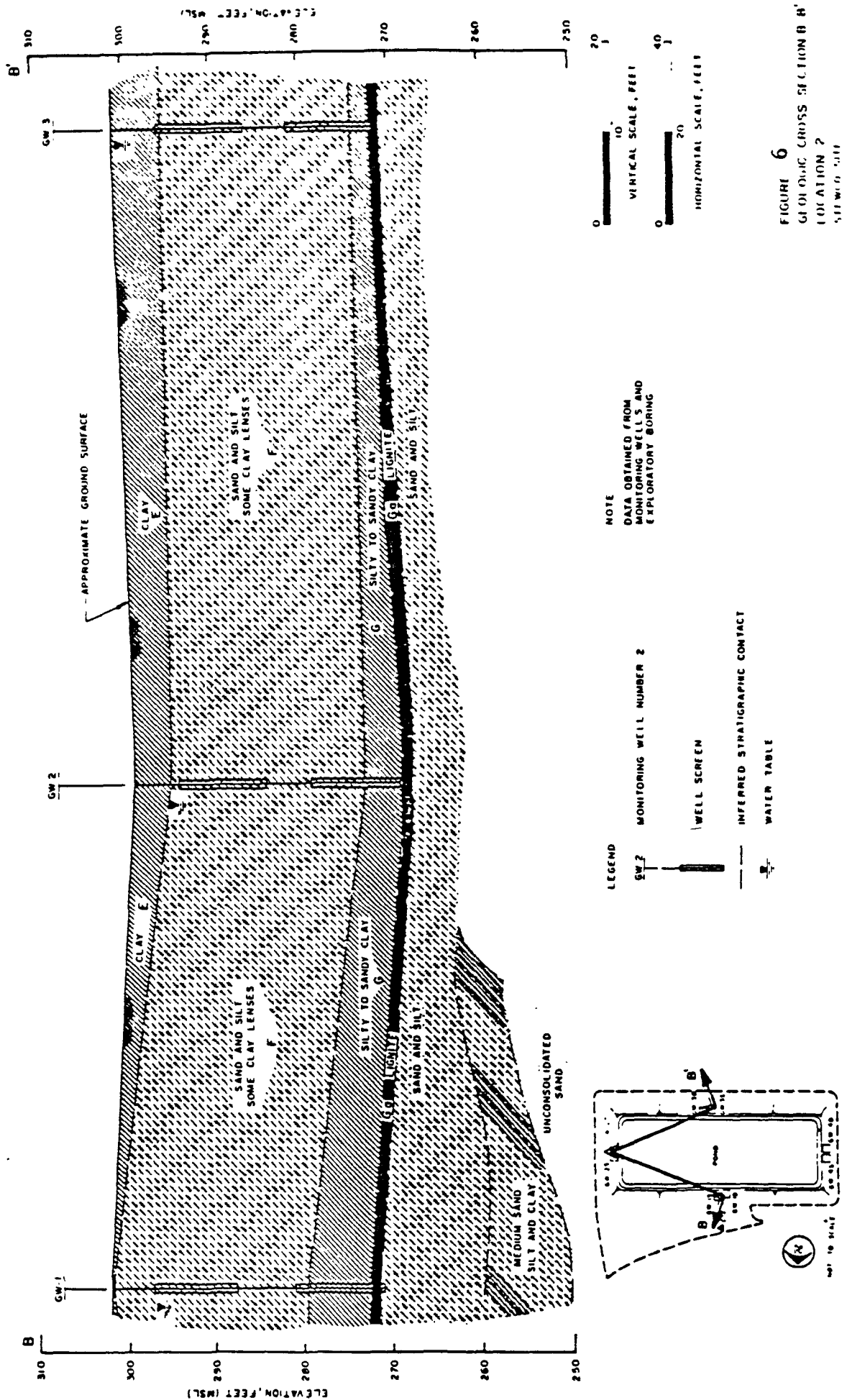

FIGURE 6
GEOLOGIC CROSS SECTION B-B'
LOCATION 2
SIT WITH G-11

At Location 2, the near-surface aquifer [Unit F] extends from about 6 feet down to 30 feet beneath the surface, Figure 6. A fine grained clay [Unit G,Ga] underlies this aquifer. On the north side of the pond, the surficial clay layer [Unit E] is less than 2 feet thick. Since the depth of the pond is 7 feet and the depth to the water table is generally 5 feet, the pond has become an integral part of the shallow groundwater system. Although the near surface groundwater flow beneath the site is generally to the east, flow from the pond is radial on the north, east, and south sides. The groundwater average flow velocity is .07 foot/day on the north and south sides of the pond and .2 foot/day on the east.

Private wells present in the area, Figure 7, are upgradient of both site locations (near-surface groundwater flow direction). These wells are probably completed in the Wilcox aquifer, although data in well construction were generally unavailable. The nearest domestic water well to either site location is at the J. B. Rudd residence, about 1850 feet northeast of Location 1.

Surface Water Hydrology

The surface water hydrology differs at each site location, but is primarily controlled by the slope and intervening terrain. Runoff from each site location into definite drainage pathways may be limited by the length of overland flow, therefore increasing the amount of precipitation infiltration into the ground surface.

At Location 1 the precipitation drains to the south from the cap area into a pasture where a natural spring and its drainage are intercepted, then to an unnamed tributary which flows into Cross Bayou. Site drainage from the main building area flows west along a fence line into a north-south drainage ditch adjacent to Highway 9 and then flows south to an unnamed tributary and then to Cross Bayou. The ponding of surface water runoff at Location 1 occurs in the southwest corner of the site, but most runoff will enter one of the two drainage pathways or infiltrate the soil prior to reaching either drainage pathway.

Surface water runoff at Location 2 drains to the north of the site in small drainage ditches to an east-west drainage area adjacent to the Interstate 20 service road. The length of overland flow limits the amount of runoff that may reach other surface water drainage patterns. If runoff does continue to flow from the service road drainage area, the runoff would enter an unnamed intermittent stream east of the site, then an unnamed tributary of Cross Bayou, then Cross Bayou. Runoff may also flow into an unnamed intermittent stream, then to an unnamed tributary, then to Cross Bayou. Surface water ponding at Location 2 is present and surface water runoff may be minimal as evidenced by the onsite ponding of water. Water collects in an onsite pond, in a low-lying area northeast of the pond, in a seepage area southeast of the pond, and in the areas east and south of the pond where the onsite gravel road is higher than the base of the pond's berms.

Cross Bayou flows across the Texas/Louisiana state line into Cross Lake, then back into Cross Bayou, which flows into the Red River. Cross Bayou is designated by the Louisiana Stream Control Commission to have water use for primary and secondary contact recreation, for propagation of fish and wildlife, and for domestic raw water supply.

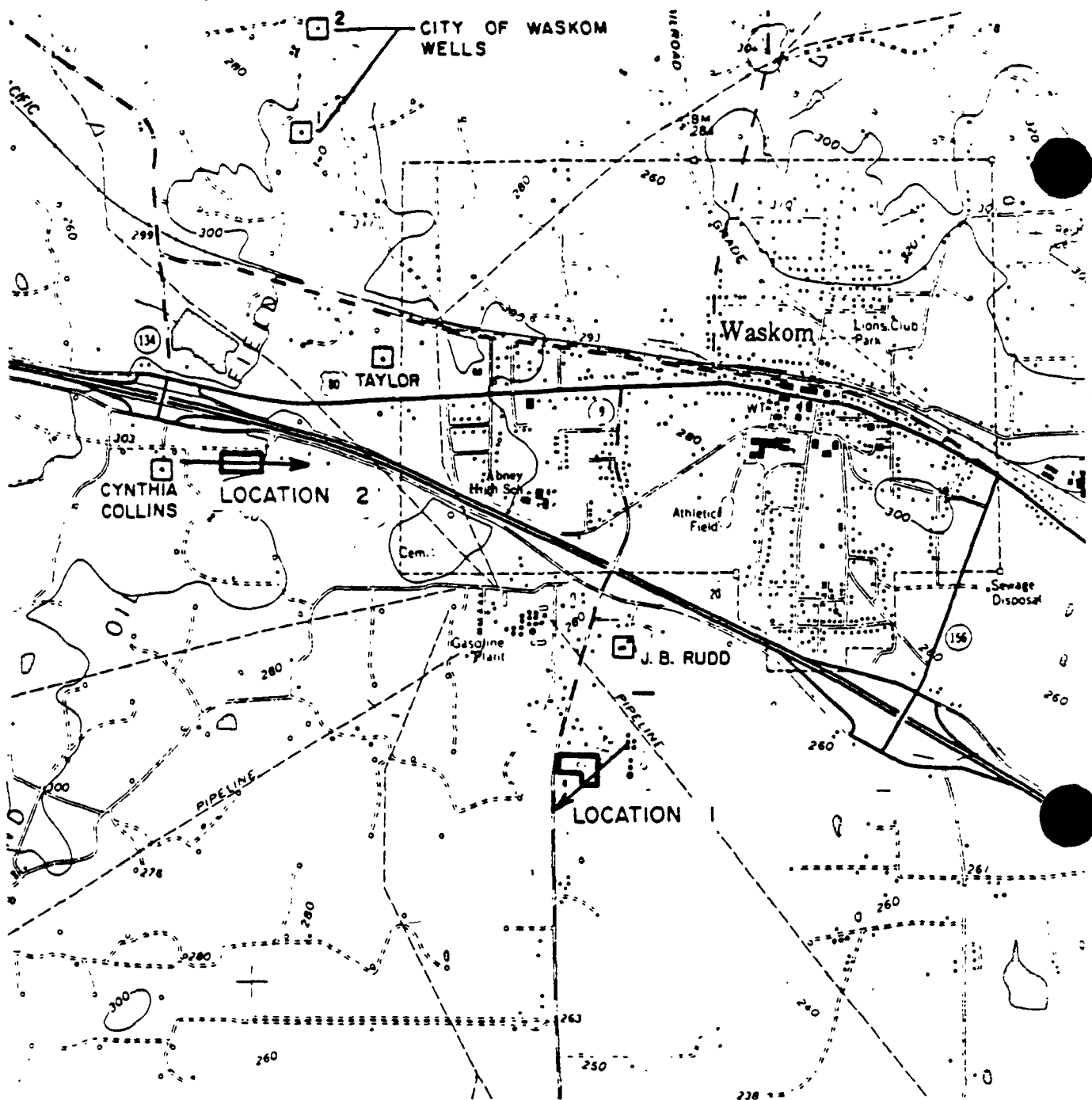

SOURCE U.S.G S TOPOGRAPHIC MAP
WASKOM, TEX-LA. QUADRANGLE
DATED 1962, PHOTOREVISED 1969
AND 1972, SCALE 1" = 2000'

LEGEND

□ OFF-SITE WATER WELL LOCATION



0 2000 4000

SCALE IN FEET



QUADRANGLE LOCATION

FIGURE 7
RESIDENTIAL WELL
LOCATIONS
STEWCO SITE

← NEAR-SURFACE GROUNDWATER FLOW DIRECTION

REMEDIAL INVESTIGATION RESULTS

The primary objectives of the Remedial Investigation were to acquire site-specific data needed to document the existence of hazardous substances and threats of releases of hazardous substances at the Stewco site. The Remedial Investigation focused on determining background conditions and the presence/absence and extent of contamination in various environmental media at each location of the Stewco site. From the information obtained during fieldwork activities (February 1988), the potential for future migration of contaminants was then evaluated. The site specific geology and hydrogeology were presented in the previous section.

In order to evaluate the effect of site contaminants on public health and the environment, contaminants of concern are selected by assessing their toxicity, concentration, and persistence. Health criteria have been developed for various chemicals in surface water and groundwater. However, since health criteria have not been developed for contaminants in soil and many chemicals are either naturally occurring in the environment or have resulted as part of common industrial activities, "background" concentrations are used for comparative purposes. In the absence of health criteria or background information, toxicity information is used to quantify risks associated with a chemical. In the absence of toxicity information, a chemical of potential concern is retained for qualitative evaluation in the risk assessment.

Tables 1 and 2 summarize the primary chemicals of concern for each media at Location 1 and at Location 2, respectively. Tables 3 and 4 compare those chemicals with available Applicable or Relevant and Appropriate Requirements (ARAR). For groundwater which is a potential drinking water source, Maximum Contaminant Level (MCL) concentrations are health based criteria set for maintaining groundwater quality. These same criteria may be used for the pond at Location 2 due to its interaction with the groundwater. In the absence of MCLs, Ambient Water Quality Criteria (AWCQ) are used for comparative purposes.

However, the origin of contamination at any site must also be evaluated to distinguish between those chemicals resulting from past site operations and those chemicals resulting from other sources in the site vicinity. All chemicals of concern, whether site related or non-site related, were evaluated in the Risk Assessment. Any such chemicals will be identified and discussed in the following subparts.

TABLE 1

PRIMARY ORGANIC CHEMICALS - STEWCO LOCATION 1

CHEMICAL DETECTED	CONCENTRATIONS BY MEDIA (ppb)			
	SUBSURFACE SOILS	GROUNDWATER	SURFACE WATER	SEDIMENTS
Not Attributed to Stewco:				
Benzene	53	14 ; 910		
Xylenes	41 ; 430	44		
Chloroform		22		
1,2-Dichloroethane		15 ; 60		
1,2-Dichloroethene		13		
Attributed to Stewco:				
Di-n-butylphthalate		3 - 6	58	
Bis(2-ethylhexyl)phthalate		4 ; 5		
4-Methyl-2-pentanone	27			
Ethylbenzene	12 ; 220			
Dibenzofuran	800 ; 41,000	19		
Carcinogenic PAHs	160 - 760**			90 ; 145
Noncarcinogenic PAHs	120 - 140,000	20 - 36	91*	70*

SINGLE AND DUAL VALUES REPRESENT THE ONLY DETECTIONS IN A MEDIA

ALL DETECTIONS INFREQUENT--PLEASE SEE RI REPORT FOR FREQUENCY OF DETECTIONS AND RELATION TO SURFACE SOILS.

Carcinogenic PAHs show range of class of compounds:

benzo(a)anthracene, chrysene, benzo(k)fluoranthene, benzo(a)pyrene, and indeno(1,2,3-cd)pyrene.

Noncarcinogenic PAHs show range of class of compounds:

acenaphthalene, phenanthrene, anthracene, fluoranthene, fluorene, and pyrene.

thracene only.

pyrene high value; also detected in surface soils. 110 ppb onsite and 56,000 ppb off-site (background).

TABLE 2

PRIMARY ORGANIC CHEMICALS - STEWCO LOCATION 2

CHEMICAL DETECTED	CONCENTRATIONS BY MEDIA (ppb)			
	SUBSURFACE SOILS	GROUNDWATER	SURFACE WATER	SEDIMENTS
Not Attributed to Stewco:				
Benzene		15		170 - 438
Xylenes		2 ; 5		420 ; 894
Attributed to Stewco:				
4-Methyl-2-pentanone		7		202 ; 640
2-Butanone		5 - 16		24 - 166
Bis(2-ethylhexyl)phthalate		10	2 - 3	5,140
Di-n-butyl phthalate				1,360
Carcinogenic PAHs				[730] - 2,200**
Noncarcinogenic PAHs		12 ; 20 *		[730] - 13,000

SINGLE AND DUAL VALUES REPRESENT THE ONLY DETECTIONS IN A MEDIA

ALL DETECTIONS INFREQUENT--PLEASE SEE RI REPORT FOR FREQUENCY OF DETECTIONS AND RELATION TO SURFACE SOILS.

Carcinogenic PAHs include:

benzo(a)anthracene, chrysene, benzo(b)fluoranthene, benzo(k)fluoranthene, and benzo(a)pyrene.

Noncarcinogenic PAHs include:

naphthalene, 2-methyl naphthalene, acenaphthalene, fluorene, phenanthrene, anthracene, fluoranthene, and pyrene.

* Anthracene only, in upgradient wells.

** Chrysene high value; also detected in surface soil at 110 ppb onsite and 56,000 ppb off-site (background).
[] Detection limits represent non-detection in a media for the lower end of a range of detections.

TABLE 3

COMPARISON OF POTENTIAL ARARS
STEWCO, INC., SITE

LOCATION 1

Groundwater Concentration
(All concentrations are in ug/liter)

Chemical	Downgradient		Offgradient Deep		Offgradient Shallow		ARAR	
	Shallow	Deep	Geo-metric Mean	Max	Geo-metric Mean	Max	MCL	AWQC
Not Attributed to Stewco:								
Benzene	ND	14	48	910	ND	ND	5*	[.67]
Chloroform	ND	ND	7	22	ND	ND	100	[.19]
1,2-Dichloroethane	ND	ND	6	15	12	60	5	[.94]
Barium	1,550	78	276	277	462	964	1,000	--
Attributed to Stewco:								
Bis(2-ethylhexyl)phthalate	ND	ND	ND	ND	4	4	--	21,000

ND = not detected.

MCL = maximum contaminant level

AWQC = ambient water quality criteria (for comparative purposes only)

[] = detection limit value for proposed standard of 0 ug/liter, 10×10^{-6} health risk

-- = no criteria established.

TABLE 4

COMPARISON OF POTENTIAL ARARS
STEWCO, INC., SITE

LOCATION 2

Groundwater Concentration
(All concentrations are in ug/liter)

Chemical	Shallow		Deep		Pond Water		ARAR	
	Geo- metric Mean	Max	Geo- metric Mean	Max	Average Case	Plausible Maximum Case	MCL	AWQC
Not Attributed to Stewco:								
Benzene	4	15	ND	ND	ND	ND	5	[.67]
Chlorobenzene	ND	ND	ND	ND	ND	ND	--	488
Barium	165	253	56	118	98	110	1,000	--
Cadmium	ND	ND	ND	11	ND	ND	10	10
Attributed to Stewco:								
Bis(2-ethylhexyl)phthalate	ND	ND	7	16	ND	ND	--	21,000

ND = not detected.

MCL = maximum contaminant level.

AWQC = ambient water quality criteria (for comparative purposes only)

[] = detection limit value for proposed standard of 0 ug/liter, 10⁻⁶ health risk

-- = no criteria available.

Location 1

Soils Investigation

Numerous polycyclic aromatic hydrocarbons (PAHs) were detected in the soils at Location 1. Those PAHs detected at Stewco are persistent and relatively immobile in the soil at the site. Although PAHs in the subsurface can be assumed to represent residual contamination remaining in the soils following the Emergency Removal Action in 1984, some surface soils in the cap area contain higher levels of certain PAHs. The concentration levels detected are within the expected background concentrations for this area of Texas, and in consideration of the surrounding industry.

Some inorganics in surface soils at Location 1 were elevated in comparison to surface soils in the site vicinity. However, no health effects are anticipated from these contaminants, as assessed in the risk analysis. Inorganics detected in subsurface soils at Location 1 were within expected background ranges for Northeast Texas.

Other organics were detected infrequently in the subsurface. These include pesticides and the volatile organics benzene, ethylbenzene, and xylene. The three pesticides detected were within expected background concentrations. Ethylbenzene was previously (1983 FIT investigation) detected in the original Pond 1 sediments, but at concentrations orders of magnitude higher than current data. Benzene and xylene were not detected in the original pond sediments during the 1983 FIT investigation or in the 1984 post-removal sampling by Emergency Response. A subsurface investigation report (1986) by a neighboring facility show these same substances to the east of the site in an area which should not be affected by Stewco past operations.

Surface Water and Sediments

Eleven organics were detected at relatively low concentrations and frequencies of detection. No significant organic or inorganic contamination were present in these samples.

Groundwater

PAH compounds found at concentrations above detection limits include acenaphthene, dibenzofuran, fluorene, and phenanthrene. These compounds are heavier than water and were detected only at low levels in the deep downgradient well at the southwest corner of the site [MW-4D]. None of the PAHs detected in the groundwater are believed to be carcinogenic (cancer causing). Although dibenzofuran is not currently classified as either a carcinogen or noncarcinogen, the low level detected should not present an adverse health risk if exposure to groundwater were to occur.

The only metal which was detected in higher concentrations downgradient than upgradient was aluminum, which was detected in both the shallow and deep wells at the southwest corner of the cap area [MW-4S, MW-4D] at concentrations of 199 and 279 ug/l, respectively. Although health criteria for this inorganic have not been developed, potential risk of health effects would be minimal if exposure were to occur. The other metals did not exhibit flow-related concentrations.

Off-gradient well samples at the northwest and southeast corners of the site were not influenced by residual PAHs beneath the cap area since the near-surface groundwater flows from the northeast to the southwest. However, volatile organics and metals were detected which have been determined to not be contributed by residuals from the former ponds. Although benzene and 1,2-dichloroethane and barium exceed MCLs, their pattern of occurrence and concentration would indicate that the site is not the source of these substances. Two other factors support this conclusion:

- 1) None of the volatiles or metal of concern were among those contaminants of significant magnitude which were detected in the 1983 FIT investigation.
- 2) A sub-surface investigation report by a neighboring facility [November 1986] shows volatiles contamination east and southeast of the cap area, an area unaffected by Stewco past operations.

The volatile contaminants do present a potential risk for health effects to occur if groundwater is ever utilized at Location 1. However, residents are currently utilizing the city water system which is upgradient and unaffected by the site. Barium presents no health hazard as assessed in the risk analysis.

Location 2

Soils Investigation

Organic chemicals were detected infrequently and at low concentrations in soils at Location 2. Three of the five detected were pesticides; these concentrations were below averages for cropland soils.

Inorganics in surface soil samples are similar to those levels detected at Location 1. None of these metals should pose a health risk, as assessed in the risk analysis. Levels of inorganics in subsurface soils are within background ranges for this area of Texas.

Surface Water and Sediment

Only one organic was detected in the pond surface water, di-n-butylphthalate at 3 ug/liter. Although no health criteria exist for this compound, the low concentration detected does not present a health threat. PAHs were not detected in the surface water. PAHs in pond sediments which are elevated from surface soils in the vicinity of the site include naphthalene, 2-methyl naphthalene, acenaphthene, dibenzofuran, fluorene, anthracene, benzo(a)anthracene, and benzo(a)pyrene. These concentrations are still within background concentration ranges for Northeast Texas.

Inorganics in pond surface water which appear at concentrations twice that of the upgradient groundwater, include barium, iron, and lead. However, none of these levels are above water quality criteria. Pond sediments contain inorganics at levels within background levels of surface soils in the area.

Twenty-four organics, other than PAHs, were detected in the pond sediments. Volatiles of concern in the sediments include benzene, chlorobenzene, and xylene. None of the volatiles of concern were detected in significant magnitude in the pond sediments during the 1983 FIT investigation. The concentrations detected do not pose a significant risk as assessed in the risk analysis.

Seep sediment samples showed no appreciable organic or inorganic contamination. Barium, magnesium, and zinc appeared elevated in the swampy area west of the pond. However, this area was a mud drilling pit for the gas well on the northwest side of the pond.

Groundwater

Semivolatile compounds detected include di-n-butyl phthalate and bis(2-ethylhexyl)phthalate and only one PAH, anthracene. Since these compounds were detected in the pond sediments at Location 2, it can be assumed that the pond is a potential source of these substances to the groundwater. However, due to the low concentrations of contaminants detected, groundwater quality is not significantly affected by the pond. Health risks were estimated as minimal if the groundwater at Location 2 is ever utilized privately.

The only metals detected in groundwater which are potentially contributed by the pond include barium and zinc. Barium was detected below its MCL of 1,000 ug/l. Although health criteria are not available for zinc, no health effects are anticipated from the levels detected.

Volatile organic compounds found at levels above the detection limit at Location 2 include benzene and xylene. Although benzene exceeds its MCL (5 ug/l), the only detection (15 ug/l) occurred in the upgradient shallow well [GW-4S] west of the pond. Xylene was detected in this same well and also in the shallow well south of the pond. No health criteria currently exist for xylene, but health effects are not anticipated for the low levels of xylene detected. Based on the previous sampling information (1983 FIT), the distribution of volatiles currently, and the other potential sources surrounding the site, the pond has been determined to not be contributing volatile organic compounds to the groundwater.

Site Risk Assessment Summary

The following public health evaluation (PHE) summary highlights the broad concerns raised as a result of the risk assessment process, but does not present the numerous assumptions and constraints employed in the PHE. Please refer to the Remedial Investigation Report to understand the full context of this brief summary.

The PHE was conducted using conservative assumptions according to the general risk assessment guidelines outlined by EPA (Superfund Public Health Evaluation Manual, 1986). The purpose of using conservative assumptions is to explore the potential for adverse health effects using conditions that tend to overestimate risk. This assures that the final estimates will usually be near or higher than the upper end of the range of actual exposures and risks. As a result, the assessment of risk should not be construed as presenting an absolute estimate of risk to human populations. Rather, it is a conservative analysis intended to indicate the potential for adverse impacts to occur.

Since many chemicals were detected infrequently at both locations, all chemicals of concern were retained for evaluation in the risk assessment. As evidenced in Tables 3 and 4, those chemicals of concern for each location which have Applicable or Relevant and Appropriate Requirements (ARARs) are not necessarily contributed by the site. Therefore, the potential for site related contaminants of concern to impact human health and the environment are evaluated separately and summarized in Tables 5 and 6.

Conservative exposure scenarios were developed which address those "maximum plausible cases" of exposure that current nearby residents may be subject to under current and future site use conditions. These "maximum plausible cases" assume an individual is exposed to the maximum concentration level detected onsite every time exposure occurs. For example, a trespassing youth at Location 1 may ingest 1.5 g/day of soil through hand to mouth interaction each time he visits the site between the ages of 6-16. Over an expected 70 year lifetime, he may have a two in one million chance of developing cancer due to the maximum concentration of carcinogenic PAHs onsite. This maximum concentration was used along with a factor for the most potent carcinogen onsite, benzo(a)pyrene, even though this compound represents only a minor portion of the carcinogenic PAHs detected onsite. Therefore, the estimated risk of two in one million is the extreme upper bound risk for Location 1. The actual risk is most probably lower and can even be zero.

The "worst case" scenario considers redevelopment of both locations under unrestricted future land and groundwater use onsite. Since a resident living onsite would have increased exposure to surface soils and even subsurface soils through yard-work, etc., the lifetime cancer risk for Location 1 is increased from two in one million to eight in ten thousand. However, this risk is again assuming that the resident is consistently exposed to the most potent carcinogen at the maximum concentration of PAHs detected onsite. Assuming that the resident also utilizes the groundwater beneath the site, this risk is not increased in terms of PAHs since no carcinogenic PAH was detected in the groundwater. Health risks from the detection of bis(2-ethylhexyl) phthalate, another semi-volatile compound detected in the groundwater, are significantly lower than this risk, and therefore, do not increase the chance of developing cancer.

In consideration of the volatiles detected at Location 1 which are believed to be coming from other sources in the vicinity of the site, a person who comes into contact with groundwater over their expected 70 year lifetime might have a one in one thousand chance of developing cancer. This assessment assumes that a person drinks 2 liters/day of water containing the maximum level concentration detected in groundwater onsite. This estimate also considers contact while showering since volatile organics can be absorbed through the skin or inhaled. Therefore, a high risk exists at Location 1 under the worst case scenario (where groundwater is utilized) that is not attributed to Stewco.

Although the same assumptions were used for Location 2, the risks are significantly lower than those at Location 1 since the only volatile detected was benzene and only at a very low concentration. Even if benzene detected in pond sediments were to leach out into the groundwater, exposure to the estimated concentrations might only present a risk of one in one billion. Therefore, risk from volatiles at Location 2, whether related to original contaminants or not, is minimal.

Table 5
EXCESS LIFETIME CANCER RISKS*
LOCATION 1

CURRENT USE EXPOSURE - Trespassing; no downgradient groundwater use.

Direct Contact with Soils	
Average Case	5×10^{-9}
Maximum Plausible Case	2×10^{-6}

"WORST CASE" EXPOSURE - Onsite residential, 70-year exposure.

Direct Contact with Soils	
Average Case	2×10^{-6}
Maximum Plausible Case	8×10^{-4}

Groundwater Use	
Average Case	8×10^{-8}
Maximum Plausible Case	3×10^{-7}

Risks associated with soils direct contact are driven by carcinogenic PAHs; however, soil levels are below those levels normally associated with Northeast Texas and in consideration of the surrounding industry.

Risks associated with groundwater use occur due to detection of bis(2-ethylhexyl)phthalate.

* Noncarcinogenic health effects were also evaluated and determined to be minimal (Hazard Indices all less than 1).

TABLE 6

EXCESS LIFETIME CANCER RISKS*
LOCATION 2

CURRENT USE EXPOSURE - Trespassing; no downgradient groundwater use.

Direct Contact with Soils, Surface Water, and Sediments	
Average Case	2×10^{-7}
Maximum Plausible Case	2×10^{-6}

Risk driven by carcinogenic PAHs; PAH levels are under those levels normally associated with Northeast Texas.

Inhalation from Pond Volatiles (estimated from sediments)	
Average Case	1×10^{-12}
Maximum Plausible Case	2×10^{-12}

"WORST CASE" EXPOSURE - Groundwater use is the only difference from the Current Use Exposure.

Groundwater Use	
Average Case	5×10^{-7}
Maximum Plausible Case	1×10^{-6}

Risk due to detection of bis(2-ethylhexyl)phthalate in downgradient deep well.

Groundwater Use	
Average Case	7×10^{-10}
Maximum Plausible Case	1×10^{-9}

Risk driven by the assumption that pond sediment contaminants leach into the groundwater (risks due to benzene).

* Noncarcinogenic health effects were also evaluated and determined to be minimal (Hazard Indices all less than 1).

STATUTORY DETERMINATION

Development of remedial alternatives was not warranted for either location on the following basis:

- o Residual contaminants associated with the former ponds at Location 1 and the existing pond at Location 2 do not pose a substantial risk to the public health or environment.
- o Applicable or Relevant and Appropriate Requirements (ARARs) may be chemical, location, or action specific for a Superfund site. However, none of these exist for the type of contaminants attributed to Stewco and in consideration of no further remedial action. Risk estimates were developed and evaluated in determining the adequate protection of human health and the environment.
- o The expenditure of additional funds to implement a remedy at Stewco would not result in significant additional protection of human health or the environment. Therefore, the decision to conduct no further action at Stewco is considered cost-effective.

Since the previous removal action was effective in mitigating the threats posed by the site to the public health, welfare, and the environment, further remediation of soils and/or groundwater would not substantially reduce the toxicity, mobility, or volume of contaminant residuals. Background concentrations of PAHs remain onsite and site contaminants are low in mobility as evidenced by the extremely low and infrequent concentrations detected in the subsurface and groundwater. Therefore, further remediation of the site is not warranted. The State and community support this decision. However, the followup investigation on the volatiles contamination not attributed to Stewco is of concern to area residents as well as the State. The Responsiveness Summary discusses this concern in more detail.

DOCUMENTATION OF SIGNIFICANT CHANGES

No significant changes to this Record of Decision were necessary from the Proposed Plan published in July 1988.

RESPONSIVENESS SUMMARY
STEWCO, INCORPORATED
RECORD OF DECISION

September, 1988

This community relations responsiveness summary is divided into two sections; The first section provides a brief history of community interest and concern raised during the remedial planning activities at the Stewco, Inc. Superfund site. The second section provides a brief summary of the community concerns raised during the public comment period and EPA responses to the comments.

BACKGROUND OF COMMUNITY INVOLVEMENT AND CONCERNS

On April 11, 1984, during the Immediate Removal Action at the Stewco site, the EPA conducted interviews of area residents. Those interviewed were primarily curious, rather than alarmed about the activities at the site. When the Stewco site was included on the National Priorities List in October 1984, the TDWR (now known as the Texas Water Commission) scheduled an initial meeting for the area residents. Approximately 25 residents attended the meeting that was conducted on May 22, 1985, at the Waskom City Hall. The primary concern of those in attendance was the need for a follow-up investigation to determine if the Immediate Removal eliminated the threat to public health and the environment.

In December 1987, EPA prepared and mailed an updated fact sheet on the Stewco site to all interested citizens on the mailing list. The fact sheet informed the citizens that EPA would be on site to conduct further sampling and perform a risk assessment in early 1988. After careful review of the sampling and risk data, EPA would then determine if further action would be needed at the site.

In March 1988 EPA completed a Remedial Investigation (RI). The results of the RI indicate that existing site contamination poses no significant public health threat at this time.

In July 1988, a fact sheet was prepared on the proposed plan of action at the site and mailed to all persons on the mailing list. EPA issued a news release on July 25, 1988, announcing the proposed plan of action.

The public comment period opened on July 25, 1988, and closed on August 23, 1988. On August 4, 1988, at 4:00 p.m. the EPA met with the Mayor of Waskom, Texas and the Editors of the local newspapers in the Waskom City Council Chamber to brief the citizens on the study findings. At 7:00 p.m. the EPA conducted a public meeting at this same location to brief the citizens on the study findings; 25 people attended the meeting.

SUMMARY OF COMMENTS RECEIVED DURING THE PUBLIC COMMENT PERIOD
AND EPA RESPONSES.

Although no written comments were received during the Public Comment Period, several issues were discussed at the Public Meeting held in Waskom on August 4, 1988. The following is a summary of the questions posed at the public meeting and documented in the transcript, accessible through the Administrative Record.

Issue #1: How does EPA work with the Texas Railroad Commission and other such agencies?

Response: In terms of solving the various problems encountered at Superfund sites, EPA must coordinate not only with State agencies such as the Railroad Commission but also with local agencies and other Federal laws relevant to a particular environmental problem. In this manner if one agency has authority where the others do not, the problem is still addressed. Also, where jurisdictions overlap, the agencies work together to ensure that the more stringent requirement is met.

Issue #2: What is RCRA's role in relation to Superfund?

Response: The Resource Conservation and Recovery Act (RCRA) program deals with the regulation of active industries which generate and dispose of hazardous waste. Superfund deals with sites where a business has disappeared or declared bankruptcy.

Issue #3: In terms of the ongoing contamination in the area surrounding Stewco from spills and the contamination in the aquifer, who will help alleviate the problem?

Response: The EPA and the TWC will investigate and pursue possible off-site sources in the area which appear to be contributing volatiles to the groundwater through regulations other than CERCLA. Off-site sources managing hazardous wastes are subject to investigation under RCRA. EPA has delegated authority to the Texas Water Commission (TWC) to carry out the hazardous waste program in the state of Texas. Off-site facilities not managing hazardous waste would need to be investigated under the authority of other regulations such as the Texas Administrative Code (TAC) 335.4. The TWC has also sent relevant information to the Railroad Commission for their review of the situation. For information on the results of the TWC investigation, the following person may be contacted:

Dana Elder
Community Relations Co-ordinator
Texas Water Commission
P.O. Box 13087, Capitol Station
Austin, Texas 78711-3087

Issue #4: Is the EPA interested in private wells, currently used for cattle water, which have brine contamination?

Response: Brine is not currently regulated by the EPA or the TWC. If the brine is associated with some type of oil and gas developmental activity, the Railroad Commission might be interested in the problem.

Issue #5: What is the level of benzene in the groundwater at Location 2 and what are the health hazards associated with it?

Response: A level of 15 ppb in the shallow well upgradient of the pond was the only detection of benzene in the groundwater at Location 2. Since no users are located downgradient of the pond, no health threats currently exist. Although benzene is found in greater concentrations in the sediments of the pond, health risks are negligible due to the type of contact involved.

Based on potential future use of the groundwater and several assumptions typifying the worst plausible case, (the benzene leaching out into the groundwater from sediments), a person might have a one in one billion chance of developing a case of cancer over an estimated 70 year lifetime. This risk is well below the action level that EPA utilizes for determining the need for remediation. Therefore, the main concern of benzene in groundwater remains focused at Location 1 where other programs will investigate the potential off-site sources upgradient of the site.

Issue #6: Are the lead levels in soils onsite and in the vicinity of the site safe?

Response: Lead concentrations onsite and in the site vicinity are well below EPA action levels and do not pose health risks as assessed in the Remedial Investigation.

APPENDIX A
ADMINISTRATIVE RECORD INDEX

September 20, 1988

Mrs. Cindy Kaleri
U.S. Environmental Protection Agency
First Interstate Bank Tower
1445 Ross Avenue, Suite 1000
Dallas, Texas 75202-2733

Dear Mrs. Kaleri:

Enclosed for your review is the Final copy of the Stewco, Inc. Administrative Record File Index, and the site sign-off form. I have made a few minor changes, Cindy, in regards to page count. Therefore, this Index will supercede the one I gave to you on last Friday. Please attach this new Administrative Record Index to your Record of Decision. I've provided you with 3 additional copies of this revised Index.

A copy of this Index will also be provided to David Polter, Office of Regional Counsel, for review.

If you have any questions or concerns, please feel free to contact me at 969-6978.

Sincerely,

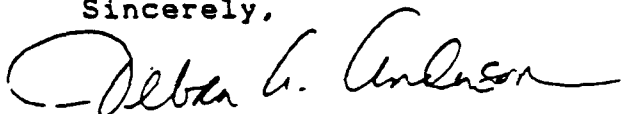

Debra A. Anderson
Paralegal/TES IV Staff

cc: Jim Wittwer w/o Enclosure

ADMINISTRATIVE RECORD INDEX

FINAL

SITE NAME: Stewco, Inc.

SITE NUMBER: TXD 0980699656

INDEX DATE: 09/20/88

ADMINISTRATIVE RECORD INDEX

FINAL

SITE NAME: Stewco, Inc.
SITE NUMBER: TXD 0980699656

DOCUMENT NUMBER: 1
DOCUMENT DATE: 06/27/80
NUMBER OF PAGES: 014
AUTHOR: Billy H. Boggs, Supervisor, District 5,
Enforcement and Field Operations Division
COMPANY/AGENCY: Texas Department of Water Resources
RECIPIENT: Gary Schroeder, Chief, Industrial Waste
Water and Solid Waste, Texas Department of
Water Resources
DOCUMENT TYPE: Memorandum and Attachments
DOCUMENT TITLE: Re: Enforcement Action Report prepared by
Chip Volz concerning Stewco, Inc., Permit
No.'s 02023 and 02024

DOCUMENT NUMBER: 2
DOCUMENT DATE: 10/02/80
NUMBER OF PAGES: 006
AUTHOR: Mary Woods
COMPANY/AGENCY: Texas Department of Water Resources
RECIPIENT: U.S. EPA Region VI-Site Files
DOCUMENT TYPE: Preliminary Assessment Report
DOCUMENT TITLE: Potential Hazardous Waste Site
Identification and Preliminary Assessment
Report for the Stewco, Inc. site in Waskom,
Harrison County, TX

DOCUMENT NUMBER: 3
DOCUMENT DATE: 05/20/82
NUMBER OF PAGES: 003
AUTHOR: David Anderson, Field Investigation Team
Ecology & Environment, Inc.
COMPANY/AGENCY: U.S. EPA Region VI Site Files
RECIPIENT: Photographs
DOCUMENT TYPE: Various photos of the Stewco, Inc. site,
that were taken of the pits, adjacent
dikes, skimmer ponds, oil drums, evaporator
pond, and of the monitoring wells

ADMINISTRATIVE RECORD INDEX

FINAL

SITE NAME: Stewco, Inc.
SITE NUMBER: TAD 0980699656

DOCUMENT NUMBER: 4
DOCUMENT DATE: 07/09/82
NUMBER OF PAGES: 004
AUTHOR: David Anderson, Field Investigation Team
COMPANY/AGENCY: Ecology and Environment, Inc.
RECIPIENT: Don Scheppers, Texas Department of Water Resources
DOCUMENT TYPE: Preliminary Assessment Report
DOCUMENT TITLE: Potential Hazardous Waste Site
Identification and Preliminary Assessment
for the Stewco, Inc. site in Waskom,
Harrison County, TX

DOCUMENT NUMBER: 5
DOCUMENT DATE: 10/20/83
NUMBER OF PAGES: 010
AUTHOR: David Anderson, Field Investigation Team
COMPANY/AGENCY: Ecology & Environment, Inc.
RECIPIENT: U.S. EPA Region VI Site Files
DOCUMENT TYPE: Photographs
DOCUMENT TITLE: Various photos of the Stewco, Inc. site,
that were taken of the pits, adjacent
dikes, skimmer ponds, oil drums,
evaporation ponds, and of the monitoring
wells.

DOCUMENT NUMBER: 6
DOCUMENT DATE: 11/01/83
NUMBER OF PAGES: 014
AUTHOR: David Anderson, Field Investigation Team -
Chemist
COMPANY/AGENCY: Ecology and Environment, Inc.
RECIPIENT: Dave Peters, Chief, Hazardous Waste
Section, U.S. EPA Region VI
DOCUMENT TYPE: Memorandum and Attachments
DOCUMENT TITLE: Re: A reconnaissance inspection of the
Stewco, Inc. site, Waskom, Harrison County,
TX on October 20, 1983

ADMINISTRATIVE RECORD INDEX

FINAL

SITE NAME: Stewco, Inc.
SITE NUMBER: TXD 0980699656

DOCUMENT NUMBER: 7
DOCUMENT DATE: 11/17/83
NUMBER OF PAGES: 136
AUTHOR: Engrid C. Crouch, Sample Personnel
COMPANY/AGENCY: Toxicon Laboratories, Inc.
RECIPIENT: U.S. EPA Region VI Site Files
DOCUMENT TYPE: Sample Data
DOCUMENT TITLE: EPA Case No. 2207 1982/01-08; which contains Traffic Reports 2001 - 2010, Toxicon Sample Records 2101 - 2105, Weekly reports 2201 - 2206, Custody Records, Sample Tags 3001 - 3002, 3201 - 3213

DOCUMENT NUMBER: 8
DOCUMENT DATE: 12/13/83
NUMBER OF PAGES: 007
AUTHOR: Russell Bartley, Acting Chief, Superfund/Operations Section
COMPANY/AGENCY: U.S. EPA Region VI
RECIPIENT: Charlie Gazda, Chief, Emergency Response Branch, U.S. EPA Region VI
DOCUMENT TYPE: Memorandum and Attachments
DOCUMENT TITLE: Re: Possible emergency response action for the Stewco, Inc. hazardous waste site in Waskom, Harrison County, TX

DOCUMENT NUMBER: 9
DOCUMENT DATE: 01/03/84
NUMBER OF PAGES: 001
AUTHOR: Andrew Puffer, Superfund Enforcement Section
COMPANY/AGENCY: U.S. EPA Region VI
RECIPIENT: Edward N. Maher, Jr., Trustee, Attorney and Counselor at Law
DOCUMENT TYPE: Record of Communication
DOCUMENT TITLE: Mr. Maher's insistence that he is not a Potentially Responsible Party for the Stewco, Inc. site; he is not an operating Trustee of Stewco, but a court assigned Trustee in the bankruptcy proceedings

ADMINISTRATIVE RECORD INDEX

FINAL

SITE NAME: Stewco, Inc.
SITE NUMBER: TXD 0980699656

DOCUMENT NUMBER: 10
DOCUMENT DATE: 01/13/84
NUMBER OF PAGES: 025
AUTHOR: Chief, Data Collection and Evaluation
Section
COMPANY/AGENCY: Texas Department of Water Resources
RECIPIENT: Director, Enforcement & Field Operations
Division, Texas Department of Water
Resources
DOCUMENT TYPE: Memorandum
DOCUMENT TITLE: Stewco Inc., Permit No's. 02023 and 02024,
that allowed the discharged of waste water
at the site

DOCUMENT NUMBER: 11
DOCUMENT DATE: 02/16/84
NUMBER OF PAGES: 032
AUTHOR: David Anderson, Field Investigation Team,
Chemist
COMPANY/AGENCY: Ecology and Environment, Inc.
RECIPIENT: Dave Peters, Chief, Hazardous Waste
Section, Ecology and Environment, Inc.
DOCUMENT TYPE: Memorandum and Attachments
DOCUMENT TITLE: Re: The field investigation team's
inspection of the Stewco, Inc. site in
Waskom, Harrison County, TX

DOCUMENT NUMBER: 12
DOCUMENT DATE: 02/17/84
NUMBER OF PAGES: 001
AUTHOR: George Buynoski, Public Health Advisor,
Center for Environmental Health
Centers for Disease Control
COMPANY/AGENCY: Centers for Disease Control
RECIPIENT: Bob Forrest, On-Scene Coordinator,
Emergency Response Branch, U.S. EPA Region
VI
DOCUMENT TYPE: Memorandum
DOCUMENT TITLE: Re: The unstable condition of the dikes
and the absence of an appropriate freeboard

ADMINISTRATIVE RECORD INDEX

FINAL

SITE NAME: Stewco, Inc.
SITE NUMBER: TXD 0980699656

DOCUMENT NUMBER: 16
DOCUMENT DATE: 04/06/84
NUMBER OF PAGES: 001
AUTHOR: George Buynoski, Public Health Advisor
COMPANY/AGENCY: Centers for Disease Control
RECIPIENT: Charles Gazda, Chief, Emergency Response
Branch, U.S. EPA Region VI
DOCUMENT TYPE: Memorandum
DOCUMENT TITLE: Re: Mr. Buynoski's response to Mr. Gazda's
inquiry regarding the discharged water from
pit No. 2

DOCUMENT NUMBER: 17
DOCUMENT DATE: 04/13/84
NUMBER OF PAGES: 001
AUTHOR: Tom Byson, Staff Writer
COMPANY/AGENCY: The Waskom Weekly
RECIPIENT: U.S. EPA Region VI Site Files
DOCUMENT TYPE: News Article
DOCUMENT TITLE: "EPA begins cleanup on local site":
Writers detailed account of what was
discussed at the public meeting regarding
Stewco's initial site cleanup

DOCUMENT NUMBER: 18
DOCUMENT DATE: 04/16/84
NUMBER OF PAGES: 004
AUTHOR: Dick Whittington, P.E. Regional
Administrator
COMPANY/AGENCY: U.S. EPA Region VI
RECIPIENT: Lee Thomas, Assistant Administrator and
Henry Van Cleave, Acting Director, U.S. EPA
Region VI
DOCUMENT TYPE: Memorandum
DOCUMENT TITLE: CERCLA Immediate Removal Action
Authorization - Stewco, Inc. site - Waskom,
Harrison County, TX

ADMINISTRATIVE RECORD INDEX

FINAL

SITE NAME: Stewco, Inc.
SITE NUMBER: TXD 0680699656

DOCUMENT NUMBER: 19
DOCUMENT DATE: 04/17/84
NUMBER OF PAGES: 006
AUTHOR: Samuel L. Nott, Chief, Superfund Branch
COMPANY/AGENCY: U.S. EPA Region VI
RECIPIENT: Charles Gazda, Chief, Emergency Response
Branch, U.S. EPA Region VI
DOCUMENT TYPE: Memorandum
DOCUMENT TITLE: Re: Community Relations On-site Discussion
at the Stewco site, in Waskom, Harrison
County, TX

DOCUMENT NUMBER: 20
DOCUMENT DATE: 04/18/84
NUMBER OF PAGES: 006
AUTHOR: Charles Gazda, Chief, Emergency Response
Branch
COMPANY/AGENCY: U.S. EPA Region VI
RECIPIENT: Mike Flaherty, Chief, Chemical Use Section,
U.S. EPA Region VI
DOCUMENT TYPE: Memorandum and Attachments
DOCUMENT TITLE: Re: The attached Community Relations
Profile for the Stewco, Inc. site in
Waskom, Harrison County, TX

DOCUMENT NUMBER: 21
DOCUMENT DATE: 04/24/84
NUMBER OF PAGES: 015
AUTHOR: Bill Langley, Deputy Director, Houston
Branch
COMPANY/AGENCY: U.S. EPA Region VI
RECIPIENT: Gerald Fontenot, Emergency Response Branch,
U.S. EPA Region VI
DOCUMENT TYPE: Sample Data
DOCUMENT TITLE: Stewco water samples AC0801, and field
blank AC0802

ADMINISTRATIVE RECORD INDEX

FINAL

SITE NAME: Stewco, Inc.
SITE NUMBER: TXD 0980699656

DOCUMENT NUMBER: 22
DOCUMENT DATE: 05/10/84
NUMBER OF PAGES: 003
AUTHOR: Charles Gazda, Chief, Emergency Response Branch
COMPANY/AGENCY: U.S. EPA Region VI
RECIPIENT: Samuel L. Nott, Chief, Superfund Branch, U.S. EPA Region VI
DOCUMENT TYPE: Correspondence
DOCUMENT TITLE: Re: Meeting held to review the soil data relative to closing out the site or evaluate the need to remove the waste contaminants

DOCUMENT NUMBER: 23
DOCUMENT DATE: 05/23/84
NUMBER OF PAGES: 003
AUTHOR: Charles Gazda, Chief, Emergency Response Branch
COMPANY/AGENCY: U.S. EPA Region VI
RECIPIENT: Sam Nott, Chief, Superfund Branch, U.S. EPA Region VI
DOCUMENT TYPE: Correspondence
DOCUMENT TITLE: Re: Meeting held to review and discuss the options available with respect to closing out the Immediate Removal Action at the Stewco, Inc. site in Waskom, Harrison County, TX

DOCUMENT NUMBER: 24
DOCUMENT DATE: 07/16/84
NUMBER OF PAGES: 356
AUTHOR: Denis C.K. Lin, Ph.D., Vice President and General Manager, Operations (ETC) Environmental Testing and Certification Corporation
COMPANY/AGENCY: R. Richard Thacker, Viar & Company, U.S. EPA Contract Laboratory Program, Sample Management Lab
RECIPIENT: Report
DOCUMENT TYPE: Sample Data Report for Case No. 2878, Stewco, Inc. site (Available for review at U.S. EPA Region VI, Dallas, TX)
DOCUMENT TITLE:

ADMINISTRATIVE RECORD INDEX

FINAL

SITE NAME: Stewco, Inc.
SITE NUMBER: TXD 0980699656

DOCUMENT NUMBER: 25
DOCUMENT DATE: 08/24/84
NUMBER OF PAGES: 003
AUTHOR: Allyn M. Davis, Director, Air and Waste
Management Division
COMPANY/AGENCY: U.S. EPA Region VI
RECIPIENT: Edward N. Maher, Jr., Attorney and
Counselor at Law
DOCUMENT TYPE: 104(e) Request For Information
DOCUMENT TITLE: Re: EPA's request for information
regarding disposal activities at the Stewco
site (This letter incorrectly references
the Crystal City Airport site, instead of
Stewco, Inc.)

DOCUMENT NUMBER: 26
DOCUMENT DATE: 11/08/84
NUMBER OF PAGES: 003
AUTHOR: Allyn M. Davis, Director, Air and Waste
Management Division
COMPANY/AGENCY: U.S. EPA Region VI
RECIPIENT: Kenneth Sitton, Former Owner of Stewco,
Inc.
DOCUMENT TYPE: 104(e) Request for Information
DOCUMENT TITLE: Re: EPA's request for information from Mr.
Sitton, regarding R.A. Corbett Transport
involvement with disposal activities at the
Stewco site

DOCUMENT NUMBER: 27
DOCUMENT DATE: 11/13/84
NUMBER OF PAGES: 003
AUTHOR: Allyn M. Davis, Director, Air and Waste
Management Division
COMPANY/AGENCY: U.S. EPA Region VI
RECIPIENT: Robert Andrews, Andrews Transport
DOCUMENT TYPE: 104(e) Request for Information
DOCUMENT TITLE: Re: EPA's request for information from Mr.
Andrews regarding his company's (formerly
known as R.A. Corbett Transport, Inc.)
involvement at the Stewco site

ADMINISTRATIVE RECORD INDEX

FINAL

SITE NAME: Stewco, Inc.
SITE NUMBER: TAD 0980699656

DOCUMENT NUMBER: 23
DOCUMENT DATE: 12/13/84
NUMBER OF PAGES: 003
AUTHOR: Allyn M. Davis, Director, Air and Waste
Management Division
COMPANY/AGENCY: U.S. EPA Region VI
RECIPIENT: Kenneth Sitton, Former Owner of Stewco,
Inc.
DOCUMENT TYPE: Correspondence
DOCUMENT TITLE: Mr. Sitton's response to EPA's 104(a)
request for information regarding questions
to be answered concerning R.A. Corbett
Transport disposal activities at the Stewco
site

DOCUMENT NUMBER: 29
DOCUMENT DATE: 01/07/85
NUMBER OF PAGES: 008
AUTHOR: David L. Hooper, Attorney
COMPANY/AGENCY: David L. Hooper & Associates, Attorneys and
Counselors at Law
RECIPIENT: Bill Hathaway, Air and Waste Management
Division, U.S. EPA Region
DOCUMENT TYPE: Correspondence
DOCUMENT TITLE: Andrews Transport response to EPA's request
for information regarding R.A. Corbett
Transport, Inc. involvement with disposal
activities at the Stewco site, in Waskom,
Harrison County, TX

DOCUMENT NUMBER: 30
DOCUMENT DATE: 01/09/85
NUMBER OF PAGES: 002
AUTHOR: Samuel L. Nott, Chief, Superfund Branch
COMPANY/AGENCY: U.S. EPA Region VI
RECIPIENT: Kenneth Sitton, Stewco, Inc.
DOCUMENT TYPE: Correspondence
DOCUMENT TITLE: Re: EPA's request for a more satisfactory
reply from Mr. Sitton, than was originally
received, regarding his disposal activities
at the Stewco, Inc. site in Waskom,
Harrison County, TX

ADMINISTRATIVE RECORD INDEX

FINAL

SITE NAME: Stewco, Inc.
SITE NUMBER: TXD 0980699556

DOCUMENT NUMBER: 31
DOCUMENT DATE: 01/22/85
NUMBER OF PAGES: 001
AUTHOR: Edward N. Maher, Jr., Trustee
COMPANY/AGENCY: Edward N. Maher, Attorney and Counselor at Law
RECIPIENT: Andrew J. Puffer, Superfund Enforcement Section, U.S. EPA Region VI
DOCUMENT TYPE: Correspondence
DOCUMENT TITLE: Mr. Maher's response as a Trustee, to EPA's inquiries regarding the Stewco site in Waskom, Harrison County, TX

DOCUMENT NUMBER: 32
DOCUMENT DATE: 01/28/85
NUMBER OF PAGES: 495
AUTHOR: Bennett J. Tyson, Program Manager / William Langley, Deputy Project Officer
COMPANY/AGENCY: EAL Corporation / U.S. EPA Region VI, Houston Branch
RECIPIENT: Keith Bradley, Hazardous Section, U.S. EPA Region VI
DOCUMENT TYPE: CLP Data Review
DOCUMENT TITLE: CLP Data Review for Case No. 2723, Stewco Inc., Waskom, Harrison County, TX

DOCUMENT NUMBER: 33
DOCUMENT DATE: 01/29/85
NUMBER OF PAGES: 001
AUTHOR: Kenneth Sitton
COMPANY/AGENCY: Former Owner of Stewco, Inc.
RECIPIENT: U.S. EPA Region VI Enforcement Staff
DOCUMENT TYPE: Correspondence
DOCUMENT TITLE: Mr. Sitton's response to EPA's request for information regarding disposal activities at the Stewco site in Waskom, Harrison County, TX

ADMINISTRATIVE RECORD INDEX

FINAL

SITE NAME: Stewco, Inc.
SITE NUMBER: TXD 0080699656

DOCUMENT NUMBER: 34
DOCUMENT DATE: 05/28/85
NUMBER OF PAGES: 008
AUTHOR: E. Wallace Cooper, On-Scene
Coordinator/Charles Gazda, Chief, Emergency
Response Branch
COMPANY/AGENCY: U.S. EPA Region VI
RECIPIENT: Sam Nott, Chief, Superfund Branch, U.S. EPA
Region VI
DOCUMENT TYPE: Memorandum and Attached Report
DOCUMENT TITLE: On-Scene Coordinator's After Action Report
for the Stewco, Inc. Site No. 66, in
Waskom, Harrison County, TX

DOCUMENT NUMBER: 35
DOCUMENT DATE: 06/10/85
NUMBER OF PAGES: 002
AUTHOR: Ralph Corbett
COMPANY/AGENCY: Stewco, Inc.
RECIPIENT: Drew Puffer, Superfund Enforcement Section,
U.S. EPA Region VI
DOCUMENT TYPE: Correspondence
DOCUMENT TITLE: Mr. Corbett's response to EPA's 104(e)
Notice Letter regarding the Stewco, Inc.
site in Waskom, Harrison County, TX

DOCUMENT NUMBER: 36
DOCUMENT DATE: 06/13/85
NUMBER OF PAGES: 001
AUTHOR: Mrs. James F. Pattee
COMPANY/AGENCY: Former Stockholder of Stewco, Inc.
RECIPIENT: Drew Puffer, Superfund Enforcement Section,
U.S. EPA Region VI
DOCUMENT TYPE: Correspondence
DOCUMENT TITLE: Mrs. Pattee's response to EPA's 104(e)
Notice Letter, regarding her being cited as
a Potentially Responsible Party, at the
Stewco, Inc. site

ADMINISTRATIVE RECORD INDEX

FINAL

SITE NAME: Stewco, Inc.
SITE NUMBER: TXD 0980699656

DOCUMENT NUMBER: 37
DOCUMENT DATE: 08/05/85
NUMBER OF PAGES: 003
AUTHOR: William B. Hathaway, Acting Director, Air & Waste Management Division
COMPANY/AGENCY: U.S. EPA Region VI
RECIPIENT: Howard Corbett, Part Owner of R.A. Corbett Transport
DOCUMENT TYPE: 104(e) Request For Information
DOCUMENT TITLE: The first 104(e) request for information letter regarding disposal activities by R.A. Corbett Transport, at the Stewco, Inc. site in Waskom, Harrison County, TX

DOCUMENT NUMBER: 38
DOCUMENT DATE: 10/10/85
NUMBER OF PAGES: 001
AUTHOR: Drew Puffer
COMPANY/AGENCY: U.S. EPA Region VI
RECIPIENT: U.S. EPA Region VI Site Files
DOCUMENT TYPE: Record of Communication
DOCUMENT TITLE: Communication that Mr. Puffer had with Mr. Corbett, regarding the 104(e) request for information that was sent to him for his response; and, his confusion regarding what was expected of him, by EPA

DOCUMENT NUMBER: 39
DOCUMENT DATE: 11/02/85
NUMBER OF PAGES: 003
AUTHOR: William B. Hathaway, Acting Director, Air and Waste Management Division
COMPANY/AGENCY: U.S. EPA Region VI
RECIPIENT: Howard B. Corbett, Part Owner of R.A. Corbett, Inc.
DOCUMENT TYPE: 104(e) Request for Information
DOCUMENT TITLE: EPA information request regarding R.A. Corbett Transport Co. disposal activities at Stewco, Waskom, Harrison County, TX and Mr. Corbett's response written on page 3 of the 08/05/85 request

ADMINISTRATIVE RECORD INDEX

FINAL

SITE NAME: Stewco, Inc.
SITE NUMBER: TXD 0980699656

DOCUMENT NUMBER: 40
DOCUMENT DATE: 03/01/86
NUMBER OF PAGES: 003
AUTHOR: Unspecified
COMPANY/AGENCY: Unspecified
RECIPIENT: U.S. EPA Region VI Site Files
DOCUMENT TYPE: Summary
DOCUMENT TITLE: The site summary for the Stewco Inc. site
in Waskom, Harrison County, TX

DOCUMENT NUMBER: 41
DOCUMENT DATE: 03/14/86
NUMBER OF PAGES: 272
AUTHOR: Thomas Osterman, Lab Personnel
COMPANY/AGENCY: Spectrix Corporation
RECIPIENT: U.S. EPA Region VI Site Files
DOCUMENT TYPE: Sample Data
DOCUMENT TITLE: Case No. 5692: Quality Control Report No.
170, for the Stewco Superfund site, Waskom,
Harrison County, TX

DOCUMENT NUMBER: 42
DOCUMENT DATE: 03/20/86
NUMBER OF PAGES: 030
AUTHOR: James E. Steibing, Chief, Surveillance
Branch
COMPANY/AGENCY: U.S. EPA Region VI
RECIPIENT: Carl Edlund, Chief, Superfund Program
Branch, U.S. EPA Region VI
DOCUMENT TYPE: Memorandum
DOCUMENT TITLE: Re: Sampling Inspection, Stewco, Inc. Site;
Sample Data FD411 (Well #3) dated 03/14/86,
and Case No. 5692, Quality Control Report
No. 5692 dated 05/23/86

ADMINISTRATIVE RECORD INDEX

FINAL

SITE NAME: Stewco, Inc.
SITE NUMBER: TXD 0980699656

DOCUMENT NUMBER: 43
DOCUMENT DATE: 07/31/86
NUMBER OF PAGES: 006
AUTHOR: E. Wallace Cooper, On-Scene Coordinator,
Emergency Response Branch
COMPANY/AGENCY: U.S. EPA Region VI
RECIPIENT: U.S. EPA Region VI Site Files
DOCUMENT TYPE: Removal Summary
DOCUMENT TITLE: EPA Emergency Response Immediate Removal
Summary for the Stewco site in Waskom, TX

DOCUMENT NUMBER: 44
DOCUMENT DATE: 10/03/86
NUMBER OF PAGES: 216
AUTHOR: Michael Daggett, Chief, Organics Lab
Section, Houston Lab
COMPANY/AGENCY: U.S. EPA Region VI
RECIPIENT: Keith Bradley, Hazardous Waste Section,
U.S. EPA Region VI
DOCUMENT TYPE: Sample Data
DOCUMENT TITLE: Case No. 5693: CLP Data Review (Stewco);
Organic sample No.'s FD411, FD411 MS, FD411
MSD, and FD412

DOCUMENT NUMBER: 45
DOCUMENT DATE: 10/16/86
NUMBER OF PAGES: 001
AUTHOR: Charles A. Gazda, Chief, Emergency Response
Branch
COMPANY/AGENCY: U.S. EPA Region VI
RECIPIENT: Stan Hitt, Texas Remedial Section, U.S. EPA
Region VI
DOCUMENT TYPE: Memorandum
DOCUMENT TITLE: Re: The rationale for not conducting a
removal action at the Stewco site No. 2, in
conjunction with the one being done at site
No. 1

ADMINISTRATIVE RECORD INDEX

FINAL

SITE NAME: Stewco, Inc.
SITE NUMBER: TXD 0980699656

DOCUMENT NUMBER: 46
DOCUMENT DATE: 01/02/87
NUMBER OF PAGES: 024
AUTHOR: Deborah Couchman, Remedial Project Manager,
Texas Remedial Section
COMPANY/AGENCY: U.S. EPA Region VI
RECIPIENT: George Pettigrew, Regional Representative,
Agency for Toxic Substances and Disease
Registry
DOCUMENT TYPE: Record of Communication
DOCUMENT TITLE: Re: Request for review and comments on the
Stewco, Inc. hazardous waste site
evaporation pond in Waskom, Harrison
County, TX

DOCUMENT NUMBER: 47
DOCUMENT DATE: 01/12/87
NUMBER OF PAGES: 003
AUTHOR: Carl Hickam, Senior Public Health Advisor
COMPANY/AGENCY: Agency for Toxic Substances and Disease
Control, Department of Health and Human
Services
RECIPIENT: Deborah Couchman, Texas Remedial Section,
U.S. EPA Region VI
DOCUMENT TYPE: Memorandum
DOCUMENT TITLE: Re: Agency for Toxic Substances and
Disease Registry's recommendation for the
Stewco, Inc. hazardous waste site
evaporation pond

DOCUMENT NUMBER: 48
DOCUMENT DATE: 01/16/87
NUMBER OF PAGES: 003
AUTHOR: Allyn M. Davis, Director, Hazardous Waste
Management Division
COMPANY/AGENCY: U.S. EPA Region VI
RECIPIENT: Robert Andrews, Andrews Transport Company
DOCUMENT TYPE: Correspondence
DOCUMENT TITLE: EPA's 104(e) Notice Letter to Mr. Andrews,
informing him of the fact that Andrews
Transport has been identified as a
Potentially Responsible Party for the
Stewco, Inc. site, in Waskom, TX

ADMINISTRATIVE RECORD INDEX

FINAL

SITE NAME: Stewco, Inc.
SITE NUMBER: TXD 0980659656

DOCUMENT NUMBER: 49
DOCUMENT DATE: 01/16/87
NUMBER OF PAGES: 003
AUTHOR: Allyn M. Davis, Director, Hazardous Waste
Management Division
COMPANY/AGENCY: U.S. EPA Region VI
RECIPIENT: Kerry Cammack, Trustee, Stewco, Inc.
DOCUMENT TYPE: Correspondence
DOCUMENT TITLE: Re: EPA's 104(e) Notice Letter to Mr.
Cammack, informing him that Stewco, Inc.
has been identified as a Potentially
Responsible Party

DOCUMENT NUMBER: 50
DOCUMENT DATE: 01/22/87
NUMBER OF PAGES: 002
AUTHOR: Deborah D. Couchman, Remedial Project
Manager, Texas Remedial Section
COMPANY/AGENCY: U.S. EPA Region VI
RECIPIENT: Carl R. Hickam, Senior Public Health
Advisor, Agency for Toxic Substances and
Disease Control
DOCUMENT TYPE: Memorandum
DOCUMENT TITLE: Re: Stewco hazardous waste Site 2
evaporation pond, laboratory analyses for
sludge and water

DOCUMENT NUMBER: 51
DOCUMENT DATE: 09/10/87
NUMBER OF PAGES: 004
AUTHOR: Cynthia J. Aduddell/Don Williams, Remedial
Project Managers, Texas Remedial Section
COMPANY/AGENCY: U.S. EPA Region VI
RECIPIENT: U.S. EPA Region VI Site Files
DOCUMENT TYPE: Memorandum
DOCUMENT TITLE: Re: Site Trip - Pre-Remedial
Investigation/Feasibility Study Project for
Stewco, Inc. Superfund site

ADMINISTRATIVE RECORD INDEX

FINAL

SITE NAME: Stewco, Inc.
SITE NUMBER: TXD 0980699656

DOCUMENT NUMBER: 52
DOCUMENT DATE: 10/02/87
NUMBER OF PAGES: 001
AUTHOR: Unspecified
COMPANY/AGENCY: U.S. EPA Region VI
RECIPIENT: Cindy Aduddell, Remedial Project Manager,
Texas Remedial Section, U.S. EPA Region VI
DOCUMENT TYPE: Aerial Photograph
DOCUMENT TITLE: Aerial photo of Stewco, Inc. area No. 1
site, in Waskom, Harrison County, TX

DOCUMENT NUMBER: 53
DOCUMENT DATE: 10/02/87
NUMBER OF PAGES: 001
AUTHOR: Unspecified
COMPANY/AGENCY: Unspecified
RECIPIENT: Cindy Aduddell, Remedial Project Manager,
Texas Remedial Section, U.S. EPA Region VI
DOCUMENT TYPE: Aerial Photograph
DOCUMENT TITLE: Aerial Photo of Stewco, Inc. area No. 2
site, in Waskom, Harrison County, TX

DOCUMENT NUMBER: 54
DOCUMENT DATE: 10/09/87
NUMBER OF PAGES: 002
AUTHOR: Allyn M. Davis, Director, Hazardous Waste
Management Division
COMPANY/AGENCY: U.S. EPA Region VI
RECIPIENT: Robert Andrews, Andrews Transport Company
DOCUMENT TYPE: Correspondence
DOCUMENT TITLE: Re: EPA's request to Mr. Andrews, as a
former contributor of hazardous waste at
Stewco, to voluntarily agree to perform the
work to abate the hazardous situation at
the Stewco site

ADMINISTRATIVE RECORD INDEX

FINAL

SITE NAME: Stewco, Inc.
SITE NUMBER: TXD 0980639656

DOCUMENT NUMBER: 55
DOCUMENT DATE: 10/13/87
NUMBER OF PAGES: 002
AUTHOR: Kerry N. Cammack, Attorney, Trustee in
Bankruptcy
COMPANY/AGENCY: Roberts, Harbour, Smith & Harris, Attorneys
at Law
RECIPIENT: Brent Truskowski, Enforcement Officer,
Superfund Compliance Section, U.S. EPA
Region VI
DOCUMENT TYPE: Correspondence
DOCUMENT TITLE: Re: Kenneth Sitton and wife, Bobbie
Sitton, Individually and d.b.a Stewco, Inc.,
bankruptcy case

DOCUMENT NUMBER: 56
DOCUMENT DATE: 10/15/87
NUMBER OF PAGES: 005
AUTHOR: Cynthia Aduddell, Remedial Project Manager,
Texas Remedial Section
COMPANY/AGENCY: U.S. EPA Region VI
RECIPIENT: U.S. EPA Region VI Site Files
DOCUMENT TYPE: Record of Communication
DOCUMENT TITLE: Re: Stewco, Inc. Remedial
Investigation/Feasibility Study Project
Offsite Access Agreement with Ray Renick, a
resident of Waskom, TX

DOCUMENT NUMBER: 57
DOCUMENT DATE: 10/26/87
NUMBER OF PAGES: 002
AUTHOR: Kerry N. Cammack, Attorney
COMPANY/AGENCY: Roberts, Harbour, Smith & Harris
RECIPIENT: Stanley G. Hitt, Chief, Texas Remedial
Section, U.S. EPA Region VI
DOCUMENT TYPE: Correspondence and Attachment
DOCUMENT TITLE: The Bankruptcy Trustee's signed copy of the
Consent for Access to Property

ADMINISTRATIVE RECORD INDEX

FINAL

SITE NAME: Stewco, Inc.
SITE NUMBER: TXD 0980699656

DOCUMENT NUMBER: 58
DOCUMENT DATE: 10/27/87
NUMBER OF PAGES: 002
AUTHOR: David L. Hooper, Attorney
COMPANY/AGENCY: David L. Hooper & Associates, Attorneys at Law
RECIPIENT: Allyn M. Davis, Director, U.S. EPA Region VI
DOCUMENT TYPE: Correspondence
DOCUMENT TITLE: Re: Mr. Hoopers denial that Andrews Transport Company is a Responsible Party at the Stewco, Inc. site in Waskom, Harrison County, TX

DOCUMENT NUMBER: 59
DOCUMENT DATE: 10/30/87
NUMBER OF PAGES: 003
AUTHOR: Stanley G. Hitt, Chief, Texas Remedial Section
COMPANY/AGENCY: U.S. EPA Region VI
RECIPIENT: Don Grubbs, Resident of Waskom, TX
DOCUMENT TYPE: Correspondence and Attachments
DOCUMENT TITLE: Re: EPA's request for Mr. Grubbs permission to come on to his property to do necessary testing, in regards to the Stewco site

DOCUMENT NUMBER: 60
DOCUMENT DATE: 11/23/87
NUMBER OF PAGES: 002
AUTHOR: Stanley G. Hitt, Chief, Texas Remedial Section
COMPANY/AGENCY: U.S. EPA Region VI
RECIPIENT: Don Grubbs, Resident of Waskom, TX
DOCUMENT TYPE: Correspondence
DOCUMENT TITLE: Re: EPA's request for access to Mr. Grubbs property to do necessary testing, in regards to the Stewco site

ADMINISTRATIVE RECORD INDEX

FINAL

SITE NAME: Stewco, Inc.
SITE NUMBER: TXD 0980699656

DOCUMENT NUMBER: 61
DOCUMENT DATE: 11/24/87
NUMBER OF PAGES: 003
AUTHOR: Stanley G. Hitt, Chief, Texas Remedial Section
COMPANY/AGENCY: U.S. EPA Region VI
RECIPIENT: Mr. and Mrs. Kenneth Sitton, Property Owners in Waskom, TX
DOCUMENT TYPE: Correspondence
DOCUMENT TITLE: Request by EPA, for access to property in Waskom, TX that the Sitton's own

DOCUMENT NUMBER: 62
DOCUMENT DATE: 12/15/87
NUMBER OF PAGES: 011
AUTHOR: Cynthia J. Aduddell, Remedial Project Manager, Texas Remedial Section
COMPANY/AGENCY: U.S. EPA Region VI
RECIPIENT: U.S. EPA Region VI Site Files
DOCUMENT TYPE: Memorandum and Attachments
DOCUMENT TITLE: Re: Stewco, Inc. Pre-Remedial Investigation Reconnaissance Survey and photographs

DOCUMENT NUMBER: 63
DOCUMENT DATE: 12/21/87
NUMBER OF PAGES: 003
AUTHOR: Allyn M. Davis, Director, Hazardous Waste Management Division
COMPANY/AGENCY: U.S. EPA Region VI
RECIPIENT: Andrews Transport Company, c/o David L. Hooper & Associates, Attorneys at Law
DOCUMENT TYPE: Correspondence
DOCUMENT TITLE: Re: Request from EPA for information concerning Andrews Transport Company (d.b.a. R.A. Corbett Transport, Inc.) involvement at the Stewco, Inc. site, Waskom, Harrison County, TX

ADMINISTRATIVE RECORD INDEX

FINAL

SITE NAME: Stewco, Inc.
SITE NUMBER: TXD 0980699556

DOCUMENT NUMBER: 64
DOCUMENT DATE: 12/31/87
NUMBER OF PAGES: 051
AUTHOR: John Frederick, Site Health and Safety Coordinator
COMPANY/AGENCY: ICF Technology, Inc.
RECIPIENT: Cynthia Kaleri, Remedial Project Manager, Texas Remedial Section, U.S. EPA Region VI
DOCUMENT TYPE: Report
DOCUMENT TITLE: Re: Health & Safety Plan sampling (soil/sediment, water) and Monitoring Well Construction, development, and sampling

DOCUMENT NUMBER: 65
DOCUMENT DATE: 01/05/88
NUMBER OF PAGES: 001
AUTHOR: Mr. and Mrs. James L. Young
COMPANY/AGENCY: Residents of Waskom, TX
RECIPIENT: Cynthia Aduddell, Remedial Project Manager, Texas Remedial Section, U.S. EPA Region VI
DOCUMENT TYPE: Consent Form
DOCUMENT TITLE: Consent for Access to Property granted to EPA, by the Youngs, to do necessary testing on their property

DOCUMENT NUMBER: 66
DOCUMENT DATE: 01/11/88
NUMBER OF PAGES: 002
AUTHOR: Allyn M. Davis, Director, Hazardous Waste Management Division
COMPANY/AGENCY: U.S. EPA Region VI
RECIPIENT: Kenneth Sitton, Former Owner of the Stewco site
DOCUMENT TYPE: Correspondence
DOCUMENT TITLE: Re: Request from EPA to provide information concerning Mr. Sitton's involvement at the Stewco site in Waskom, Harrison County, TX

ADMINISTRATIVE RECORD INDEX

FINAL

SITE NAME: Stewco, Inc.
SITE NUMBER: TXD 0180699856

DOCUMENT NUMBER: 67
DOCUMENT DATE: 01/14/88
NUMBER OF PAGES: 010
AUTHOR: Cynthia J. Aduddell, Remedial Project Manager
COMPANY/AGENCY: U.S. EPA Region VI
RECIPIENT: U.S. EPA Region VI Files
DOCUMENT TYPE: Memorandum and Attachments
DOCUMENT TITLE: Stewco Remedial Investigation/Feasibility Study Project Initiation Meeting

DOCUMENT NUMBER: 68
DOCUMENT DATE: 01/25/88
NUMBER OF PAGES: 002
AUTHOR: George L. Pettigrew, Regional Representative
COMPANY/AGENCY: Agency for Toxic Substances and Disease Registry, Department of Health and Human Services
RECIPIENT: Cynthia Aduddell, Remedial Project Manager, Texas Remedial Section, U.S. EPA Region VI
DOCUMENT TYPE: Memorandum
DOCUMENT TITLE: Re: Health consultation - Draft Work Plan for Stewco, Inc. site, in Waskom, Harrison County, TX

DOCUMENT NUMBER: 69
DOCUMENT DATE: 01/26/88
NUMBER OF PAGES: 006
AUTHOR: Cynthia J. Aduddell, Remedial Project Manager, Texas Remedial Section
COMPANY/AGENCY: U.S. EPA Region VI
RECIPIENT: John McCann, Site Manager, ICF Technology, Inc.
DOCUMENT TYPE: Correspondence
DOCUMENT TITLE: Re: EPA's preliminary comments on the Stewco Draft Work Plan

ADMINISTRATIVE RECORD INDEX

FINAL

SITE NAME: Stewco, Inc.
SITE NUMBER: TXD 0980699656

DOCUMENT NUMBER: 70
DOCUMENT DATE: 01/29/88
NUMBER OF PAGES: 001
AUTHOR: Barbara Grubbs (Mrs. Don Grubbs)
COMPANY/AGENCY: Resident of Waskom, TX
RECIPIENT: Cynthia Aduddell, Remedial Project Manager,
Texas Remedial Section, U.S. EPA Region VI
DOCUMENT TYPE: Consent Form
DOCUMENT TITLE: Consent for Access to Property that was
agreed to and signed by Mrs. Grubbs

DOCUMENT NUMBER: 71
DOCUMENT DATE: 01/31/88
NUMBER OF PAGES: 002
AUTHOR: Ralph Corbett
COMPANY/AGENCY: Former Stockholder of Stewco, Inc.
RECIPIENT: Brent Truskowski, Enforcement Officer,
Superfund Compliance Section, U.S. EPA
Region VI
DOCUMENT TYPE: Correspondence
DOCUMENT TITLE: Re: Mr. Corbetts' response to EPA's 104(e)
request for information regarding his
involvement with the Stewco site in Waskom,
Harrison County, TX

DOCUMENT NUMBER: 72
DOCUMENT DATE: 02/09/88
NUMBER OF PAGES: 001
AUTHOR: Cynthia Aduddell, Remedial Project Manager,
Texas Remedial Section
COMPANY/AGENCY: U.S. EPA Region VI
RECIPIENT: George Pettigrew, Regional Representative,
Agency for Toxic Substance and Disease
Registry
DOCUMENT TYPE: Memorandum
DOCUMENT TITLE: Draft Remedial Investigation Work Plan
comments for Stewco, Inc. site

ADMINISTRATIVE RECORD INDEX

FINAL

SITE NAME: Stewco, Inc.
SITE NUMBER: TXD 0980699656

DOCUMENT NUMBER: 73
DOCUMENT DATE: 02/10/88
NUMBER OF PAGES: 197
AUTHOR: Staff Consultants
COMPANY/AGENCY: ICF Technology, Inc.
RECIPIENT: Cynthia Aduddell, Remedial Project Manager,
Texas Remedial Section, U.S. EPA Region VI
DOCUMENT TYPE: Report
DOCUMENT TITLE: Quality Assurance Project Plan for the
Stewco site in Waskom, Harrison County, TX

DOCUMENT NUMBER: 74
DOCUMENT DATE: 02/23/88
NUMBER OF PAGES: 001
AUTHOR: Cynthia J. Aduddell, Remedial Project
Manager, Texas Remedial Section
COMPANY/AGENCY: U.S. EPA Region VI
RECIPIENT: John McCann, Site Project Manager, ICF
Technology, Inc.
DOCUMENT TYPE: Record of Communication
DOCUMENT TITLE: Re: Work Plan final revisions - Stewco
site; Remedial Investigation/Feasibility
Study project

DOCUMENT NUMBER: 75
DOCUMENT DATE: 02/29/88
NUMBER OF PAGES: 074
AUTHOR: Staff Consultants
COMPANY/AGENCY: ICF Technology, Inc.
RECIPIENT: Cynthia Kaleri, Remedial Project Manager,
Texas Remedial Section, U.S. EPA VI
DOCUMENT TYPE: Report
DOCUMENT TITLE: Final Work Plan for Remedial Investigation
Activities at the Stewco, Inc. site in
Waskom, Harrison County, TX

ADMINISTRATIVE RECORD INDEX

FINAL

SITE NAME: Stewco, Inc.
SITE NUMBER: TXD 0980699656

DOCUMENT NUMBER: 76
DOCUMENT DATE: 03/10/88
NUMBER OF PAGES: 001
AUTHOR: Jonn P. McCann, Site Project Manager
COMPANY/AGENCY: ICF Technology, Inc.
RECIPIENT: Cindy Kaleri, Remedial Project Manager,
Texas Remedial Section, U.S. EPA Region VI
DOCUMENT TYPE: Correspondence
DOCUMENT TITLE: Re: The final Quality Assurance Project
Plan, and the Work Plan for the Stewco site
in Waskom, Harrison County, TX

DOCUMENT NUMBER: 77
DOCUMENT DATE: 03/10/88
NUMBER OF PAGES: 060
AUTHOR: Diann Ayers, Chief, Houston Branch
COMPANY/AGENCY: U.S. EPA Region VI
RECIPIENT: JoAnn Miller, CLP Manager, U.S. EPA Region
VI
DOCUMENT TYPE: Memorandum and Attached Sample Report
DOCUMENT TITLE: Case No. 8860: Sample Data report, Notice
of Intent to Dispose of Samples; and,
Residential Well Sample Data (Available for
review at U.S. EPA Region VI, Dallas, TX)

DOCUMENT NUMBER: 78
DOCUMENT DATE: 03/24/88
NUMBER OF PAGES: 001
AUTHOR: Robert G. Forrest, Chief, Office of Quality
Assurance
COMPANY/AGENCY: U.S. EPA Region VI
RECIPIENT: Cynthia J. Aduddell, Remedial Project
Manager, Texas Remedial Section, U.S. EPA
Region VI
DOCUMENT TYPE: Memorandum
DOCUMENT TITLE: Re: Approval of Stewco, Inc. site Quality
Assurance Project Plan

ADMINISTRATIVE RECORD INDEX

FINAL

SITE NAME: Stewco, Inc.
SITE NUMBER: TXD 0980699656

DOCUMENT NUMBER: 79
DOCUMENT DATE: 03/25/88
NUMBER OF PAGES: 360
AUTHOR: Michael L. Daggett, Chief, Organics Lab
Section
COMPANY/AGENCY: U.S. EPA Region VI
RECIPIENT: JoAnn Miller, CLP Manager, U.S. EPA Region
VI
DOCUMENT TYPE: CLP Data Review
DOCUMENT TITLE: Quality Assurance/Quality Control Reports
for Sample Data Case No. 8860/3578F

DOCUMENT NUMBER: 80
DOCUMENT DATE: 04/06/88
NUMBER OF PAGES: 554
AUTHOR: Lab Personnel
COMPANY/AGENCY: SRW Associates/ICF Technology
Company/Versar, Inc.
RECIPIENT: Cindy J. Kaleri, Remedial Project Manager,
Texas Remedial Section, U.S. EPA Region VI
DOCUMENT TYPE: Raw Data (1 of 21)
DOCUMENT TITLE: Case No. 8860: Sample Analysis Data, SASF
No. 3578 F, Volatile Inorganic Analysis
Data Sheets, Sample Preparation Packages
(Available for review at U.S. EPA Region
VI, Dallas, TX)

DOCUMENT NUMBER: 81
DOCUMENT DATE: 04/06/88
NUMBER OF PAGES: 422
AUTHOR: Lab Personnel
COMPANY/AGENCY: SRW Associates/ICF Technology
Company/Versar, Inc.
RECIPIENT: Cindy A. Kaleri, Remedial Project Manager,
Texas Remedial Section, U.S. EPA Region VI
DOCUMENT TYPE: Raw Data (2 of 21)
DOCUMENT TITLE: Case No 8860: Sample Analysis Data,
Volatile Inorganic Analysis Data Sheets,
Sample Preparation Packages (Available for
review at U.S. EPA Region VI, Dallas, TX)

ADMINISTRATIVE RECORD INDEX

FINAL

SITE NAME: Stewco, Inc.
SITE NUMBER: TXD 0980699656

DOCUMENT NUMBER: 82
DOCUMENT DATE: 04/06/88
NUMBER OF PAGES: 531
AUTHOR: Lab Personnel
COMPANY/AGENCY: SRW Associates/ICF Technology
Company/Versar, Inc.
RECIPIENT: Cindy A. Kaleri, Remedial Project Manager,
Texas Remedial Section, U.S. EPA Region VI
DOCUMENT TYPE: Raw Data (3 of 21)
DOCUMENT TITLE: Case No. 8860: Sample Analysis Data,
Volatile Inorganic Analysis Data Sheets,
Sample Preparation Packages (Available for
review at U.S. EPA Region VI, Dallas, TX)

DOCUMENT NUMBER: 83
DOCUMENT DATE: 04/06/88
NUMBER OF PAGES: 727
AUTHOR: Lab Personnel
COMPANY/AGENCY: SRW Associates/ICF Technology
Company/Versar, Inc.
RECIPIENT: Cindy A. Kaleri, Remedial Project Manager,
Texas Remedial Section, U.S. EPA Region VI
DOCUMENT TYPE: Raw Data (4 of 21)
DOCUMENT TITLE: Case No. 8860: Sample Analysis Data,
Volatile Inorganic Analysis Data Sheets,
Sample Preparation Packages (Available for
review at U.S. EPA Region VI, Dallas, TX)

DOCUMENT NUMBER: 84
DOCUMENT DATE: 04/06/88
NUMBER OF PAGES: 643
AUTHOR: Lab Personnel
COMPANY/AGENCY: SRW Associates/ICF Technology
Company/Versar, Inc.
RECIPIENT: Cindy A. Kaleri, Remedial Project Manager,
Texas Remedial Section, U.S. EPA Region VI
DOCUMENT TYPE: Raw Data (5 of 21)
DOCUMENT TITLE: Case No. 8860: Sample Analysis Data,
Volatile Inorganic Analysis Data Sheets,
Sample Preparation Packages (Available for
review at U.S. EPA Region VI, Dallas, TX)

ADMINISTRATIVE RECORD INDEX

FINAL

SITE NAME: Stewco, Inc.
SITE NUMBER: TXD 0980699656

DOCUMENT NUMBER: 85
DOCUMENT DATE: 04/06/88
NUMBER OF PAGES: 268
AUTHOR: Lab Personnel
COMPANY/AGENCY: SRW Associates/ICF Technology
Company/Versar, Inc.
RECIPIENT: Cindy A. Kaleri, Remedial Project Manager,
Texas Remedial Section, U.S. EPA Region VI
DOCUMENT TYPE: Raw Data (6 of 21)
DOCUMENT TITLE: Case No. 8860: Sample Analysis Data,
Volatile Inorganic Analysis Data Sheets,
Sample Preparation Packages (Available for
review at U.S. EPA Region VI, Dallas, TX)

DOCUMENT NUMBER: 86
DOCUMENT DATE: 04/06/88
NUMBER OF PAGES: 068
AUTHOR: Lab Personnel
COMPANY/AGENCY: SRW Associates/ICF Technology
Company/Versar, Inc.
RECIPIENT: Cindy A. Kaleri, Remedial Project Manager,
Texas Remedial Section, U.S. EPA Region VI
DOCUMENT TYPE: Raw Data (7 of 21)
DOCUMENT TITLE: Case No. 8860: Sample Analysis Data,
Volatile Inorganic Analysis Data Sheets,
Sample Preparation Packages (Available for
review at U.S. EPA Region VI, Dallas, TX)

DOCUMENT NUMBER: 87
DOCUMENT DATE: 04/06/88
NUMBER OF PAGES: 365
AUTHOR: Lab Personnel
COMPANY/AGENCY: SRW Associates/ICF Technology
Company/Versar, Inc.
RECIPIENT: Cindy A. Kaleri, Remedial Project Manager,
Texas Remedial Section, U.S. EPA Region VI
DOCUMENT TYPE: Raw Data (8 of 21)
DOCUMENT TITLE: Case No. 8860: Sample Analysis Data,
Volatile Inorganic Analysis Data Sheets,
Sample Preparation Packages (Available for
review at U.S. EPA Region VI, Dallas, TX)

ADMINISTRATIVE RECORD INDEX

FINAL

SITE NAME: Stewco, Inc.
SITE NUMBER: TXD 0980698656

DOCUMENT NUMBER: 88
DOCUMENT DATE: 04/06/88
NUMBER OF PAGES: 648
AUTHOR: Lab Personnel
COMPANY/AGENCY: SRW Associates/ICF Technology
Company/Versar, Inc.
RECIPIENT: Cindy A. Kaleri, Remedial Project Manager,
Texas Remedial Section, U.S. EPA Region VI
DOCUMENT TYPE: Raw Data (9 of 21)
DOCUMENT TITLE: Case No. 8860: Sample Analysis Data,
Volatile Inorganic Analysis Data Sheets,
Sample Preparation Packages (Available for
review at U.S. EPA Region VI, Dallas, TX)

DOCUMENT NUMBER: 89
DOCUMENT DATE: 04/06/88
NUMBER OF PAGES: 413
AUTHOR: Lab Personnel
COMPANY/AGENCY: SRW Associates/ICF Technology
Company/Versar, Inc.
RECIPIENT: Cindy A. Kaleri, Remedial Project Manager,
Texas Remedial Section, U.S. EPA Region VI
DOCUMENT TYPE: Raw Data (10 of 21)
DOCUMENT TITLE: Case No. 8860: Sample Analysis Data,
Volatile Inorganic Analysis Data Sheets,
Sample Preparation Packages (Available for
review at U.S. EPA Region VI, Dallas, TX)

DOCUMENT NUMBER: 90
DOCUMENT DATE: 04/06/88
NUMBER OF PAGES: 400
AUTHOR: Lab Personnel
COMPANY/AGENCY: SRW Associates/ICF Technology
Company/Versar, Inc.
RECIPIENT: Cindy A. Kaleri, Remedial Project Manager,
Texas Remedial Section, U.S. EPA Region VI
DOCUMENT TYPE: Raw Data (11 of 21)
DOCUMENT TITLE: Case No. 8860: Sample Analysis Data,
Volatile Inorganic Analysis Data Sheets,
Sample Preparation Packages (Available for
review at U.S. EPA Region VI, Dallas, TX)

ADMINISTRATIVE RECORD INDEX

FINAL

SITE NAME: Stawco, Inc.
SITE NUMBER: TXD 0980699656

DOCUMENT NUMBER: 94
DOCUMENT DATE: 04/06/88
NUMBER OF PAGES: 402
AUTHOR: Lab Personnel
COMPANY/AGENCY: SRW Associates/ICF Technology
Company/Versar, Inc.
RECIPIENT: Cindy A. Kaleri, Remedial Project Manager,
Texas Remedial Section, U.S. EPA Region VI
DOCUMENT TYPE: Raw Data (15 of 21)
DOCUMENT TITLE: Case No. 8860: Sample Analysis Data,
Volatile Inorganic Analysis Data Sheets,
Sample Preparation Packages (Available for
review at U.S. EPA Region VI, Dallas, TX)

DOCUMENT NUMBER: 95
DOCUMENT DATE: 04/06/88
NUMBER OF PAGES: 618
AUTHOR: Lab Personnel
COMPANY/AGENCY: SRW Associates/ICF Technology
Company/Versar, Inc.
RECIPIENT: Cindy A. Kaleri, Remedial Project Manager,
Texas Remedial Section, U.S. EPA Region VI
DOCUMENT TYPE: Raw Data (16 of 21)
DOCUMENT TITLE: Case No. 8860: Sample Analysis Data,
Volatile Inorganic Analysis Data Sheets,
Sample Preparation Packages (Available for
review at U.S. EPA Region VI, Dallas, TX)

DOCUMENT NUMBER: 96
DOCUMENT DATE: 04/06/88
NUMBER OF PAGES: 033
AUTHOR: Lab Personnel
COMPANY/AGENCY: SRW Associates/ICF Technology
Company/Versar, Inc.
RECIPIENT: Cindy A. Kaleri, Remedial Project Manager,
Texas Remedial Section, U.S. EPA Region VI
DOCUMENT TYPE: Raw Data (17 of 21)
DOCUMENT TITLE: Case No. 8860: Sample Analysis Data,
Volatile Inorganic Analysis Data Sheets,
Sample Preparation Packages (Available for
review at U.S. EPA Region VI, Dallas, TX)

ADMINISTRATIVE RECORD INDEX

FINAL

SITE NAME: Stewco, Inc.
SITE NUMBER: TXD 0980699656

DOCUMENT NUMBER: 97
DOCUMENT DATE: 04/06/88
NUMBER OF PAGES: 462
AUTHOR: Lab Personnel
COMPANY/AGENCY: SRW Associates/ICF Technology
Company/Versar, Inc.
RECIPIENT: Cindy A. Kaleri, Remedial Project Manager,
Texas Remedial Section, U.S. EPA Region VI
DOCUMENT TYPE: Raw Data (18 of 21)
DOCUMENT TITLE: Case No. 8860: Sample Analysis Data,
Volatile Inorganic Analysis Data Sheets,
Sample Preparation Packages (Available for
review at U.S. EPA Region VI, Dallas, TX)

DOCUMENT NUMBER: 98
DOCUMENT DATE: 04/06/88
NUMBER OF PAGES: 518
AUTHOR: Lab Personnel
COMPANY/AGENCY: SRW Associates/ICF Technology
Company/Versar, Inc.
RECIPIENT: Cindy A. Kaleri, Remedial Project Manager,
Texas Remedial Section, U.S. EPA Region VI
DOCUMENT TYPE: Raw Data (19 of 21)
DOCUMENT TITLE: Case No. 8860: Sample Analysis Data,
Volatile Inorganic Analysis Data Sheets,
Sample Preparation Packages (Available for
review at U.S. EPA Region VI, Dallas, TX)

DOCUMENT NUMBER: 99
DOCUMENT DATE: 04/06/88
NUMBER OF PAGES: 398
AUTHOR: Lab Personnel
COMPANY/AGENCY: SRW Associates/ICF Technology
Company/Versar, Inc.
RECIPIENT: Cindy A. Kaleri, Remedial Project Manager,
Texas Remedial Section, U.S. EPA Region VI
DOCUMENT TYPE: Raw Data (20 of 21)
DOCUMENT TITLE: Case No. 8860: Sample Analysis Data,
Volatile Inorganic Analysis Data Sheets,
Sample Preparation Packages (Available for
review at U.S. EPA Region VI, Dallas, TX)

ADMINISTRATIVE RECORD INDEX

FINAL

SITE NAME: Stewco, Inc.
SITE NUMBER: TXD 0980699656

DOCUMENT NUMBER: 100
DOCUMENT DATE: 04/06/88
NUMBER OF PAGES: 472
AUTHOR: Lab Personnel
COMPANY/AGENCY: SRW Associates/ICF Technology
Company/Versar, Inc.
RECIPIENT: Cindy A. Kaleri, Remedial Project Manager,
Texas Remedial Section, U.S. EPA Region VI.
DOCUMENT TYPE: Raw Data (21 of 21)
DOCUMENT TITLE: Case No. 8860: Sample Analysis Data,
Volatile Inorganic Analysis Data Sheets,
Sample Preparation Packages (Available for
review at U.S. EPA Region VI, Dallas, TX)

DOCUMENT NUMBER: 101
DOCUMENT DATE: 04/14/88
NUMBER OF PAGES: 003
AUTHOR: Allyn M. Davis, Director, Hazardous Waste
Management Division
COMPANY/AGENCY: U.S. EPA Region VI
RECIPIENT: Cliff Pearson, Environmental Advisor, Mobil
Corporation
DOCUMENT TYPE: Correspondence
DOCUMENT TITLE: Request for information and sampling data
regarding the Mobil property that is
adjacent to the Stewco site, in Waskom,
Harrison County, TX

DOCUMENT NUMBER: 102
DOCUMENT DATE: 04/20/88
NUMBER OF PAGES: 002
AUTHOR: Oscar Cabra, Jr., P.E., Chief, Water Supply
Branch
COMPANY/AGENCY: U.S. EPA Region VI
RECIPIENT: Martha McKee, Chief, Superfund Compliance
Section, U.S. EPA Region VI
DOCUMENT TYPE: Memorandum
DOCUMENT TITLE: Comments on the potential groundwater
problems in residential wells discuss
during the Remedial Investigation, for the
Stewco, Inc. site, Waskom, Harrison County,
TX

ADMINISTRATIVE RECORD INDEX

FINAL

SITE NAME: Stewco, Inc.
SITE NUMBER: TXD 0980699656

DOCUMENT NUMBER: 103
DOCUMENT DATE: 05/10/88
NUMBER OF PAGES: 451
AUTHOR: C.L. Pearson, Environmental Advisor
COMPANY/AGENCY: Mobil Oil Corporation
RECIPIENT: Cynthia Kaleri, Remedial Project Manager,
Texas Remedial Section, U.S. EPA Region VI
DOCUMENT TYPE: Correspondence and Attached Reports
DOCUMENT TITLE: Re: Mobil's response to EPA's request for
information

DOCUMENT NUMBER: 104
DOCUMENT DATE: 05/12/88
NUMBER OF PAGES: 004
AUTHOR: Cynthia J. Kaleri, Remedial Project
Manager, Texas Remedial Section
COMPANY/AGENCY: U.S. EPA Region VI
RECIPIENT: U.S. EPA Region VI Files
DOCUMENT TYPE: Meeting Summary
DOCUMENT TITLE: Meeting held on 05/12/88, to discuss the
Stewco, Inc. Preliminary Risk Assessment

DOCUMENT NUMBER: 105
DOCUMENT DATE: 05/16/88
NUMBER OF PAGES: 002
AUTHOR: Cynthia J. Kaleri, Remedial Project
Manager, Texas Remedial Section
COMPANY/AGENCY: U.S. EPA Region VI
RECIPIENT: John McCann, Site Manager, ICF Technology,
Inc.
DOCUMENT TYPE: Record of Communication
DOCUMENT TITLE: Re: Stewco groundwater issue (identified
at Risk Assessment Meeting)

ADMINISTRATIVE RECORD INDEX

FINAL

SITE NAME: Stewco, Inc.
SITE NUMBER: TXD 0980699656

DOCUMENT NUMBER: 106
DOCUMENT DATE: 05/17/88
NUMBER OF PAGES: 001
AUTHOR: John P. McCann, Site Manager
COMPANY/AGENCY: ICF Technology
RECIPIENT: Cynthia J. Kaleri, Remedial Project
Manager, Texas Remedial Section, U.S. EPA
Region VI
DOCUMENT TYPE: Correspondence
DOCUMENT TITLE: Re: Stewco site Remedial Investigation
Draft Risk Assessment Submittal

DOCUMENT NUMBER: 107
DOCUMENT DATE: 05/19/88
NUMBER OF PAGES: 001
AUTHOR: Cynthia J. Kaleri, Remedial Project
Manager, Texas Remedial Section
U.S. EPA Region VI
COMPANY/AGENCY: U.S. EPA Region VI
RECIPIENT: George Pettigrew, Region VI
Representative, Agency for Toxic
Substances and Disease Registry
DOCUMENT TYPE: Record of Communication
DOCUMENT TITLE: Re: The submittal of a request for a
Health Assessment to be done for the Stewco
site in Waskom, Harrison County, TX

DOCUMENT NUMBER: 108
DOCUMENT DATE: 05/23/88
NUMBER OF PAGES: 001
AUTHOR: John P. McCann, Site Manager
COMPANY/AGENCY: ICF Technology
RECIPIENT: Cynthia J. Kaleri, Remedial Project
Manager, Texas Remedial Section, U.S. EPA
Region VI
DOCUMENT TYPE: Correspondence
DOCUMENT TITLE: Re: Stewco site Remedial Investigation -
Agency Review of Draft Remedial
Investigation Report

ADMINISTRATIVE RECORD INDEX

FINAL

SITE NAME: Stewco, Inc.
SITE NUMBER: TXD 0980699656

DOCUMENT NUMBER: 109
DOCUMENT DATE: 06/03/88
NUMBER OF PAGES: 004
AUTHOR: Victor Chapman, Lab Personnel, Houston Branch
COMPANY/AGENCY: U.S. EPA Region VI
RECIPIENT: David Cook, U.S. EPA Region VI
DOCUMENT TYPE: Sample Data
DOCUMENT TITLE: Case No. 8860: Quality Assurance/Quality Control Compliance review of Contract Compliance Screening (CCS) Resubmitted Data (Available for review at U.S. EPA Region VI, Dallas, TX)

DOCUMENT NUMBER: 110
DOCUMENT DATE: 06/06/88
NUMBER OF PAGES: 002
AUTHOR: Cynthia J. Kaleri, Remedial Project Manager, Texas Remedial Section
COMPANY/AGENCY: U.S. EPA Region VI
RECIPIENT: Kathleen O'Reilly, Hydrogeologist, Superfund Programs Branch, U.S. EPA Region VI
DOCUMENT TYPE: Memorandum
DOCUMENT TITLE: Stewco superfund site - BTX Contamination, Review of Subsurface Investigation - Mobil Oil Terminal, Waskom, Harrison County, TX

DOCUMENT NUMBER: 111
DOCUMENT DATE: 06/06/88
NUMBER OF PAGES: 005
AUTHOR: Cynthia J. Kaleri, Remedial Project Manager, Texas Remedial Section
COMPANY/AGENCY: U.S. EPA Region VI
RECIPIENT: U.S. EPA Region VI Files
DOCUMENT TYPE: Summary
DOCUMENT TITLE: A synopsis of the Subsurface Investigation Report - November 1986, Mobil Terminal, Waskom, Harrison County, TX

ADMINISTRATIVE RECORD INDEX

FINAL

SITE NAME: Stewco, Inc.
SITE NUMBER: TXD 0980699656

DOCUMENT NUMBER: 112
DOCUMENT DATE: 06/15/88
NUMBER OF PAGES: 003
AUTHOR: Cynthia J. Kaleri, Remedial Project
Manager, Texas Remedial Section
COMPANY/AGENCY: U.S. EPA Region VI
RECIPIENT: John P. McCann, Site Manager, ICF
Technology
DOCUMENT TYPE: Correspondence
DOCUMENT TITLE: Comments regarding the draft Remedial
Investigation Report for the Stewco project

DOCUMENT NUMBER: 113
DOCUMENT DATE: 06/16/88
NUMBER OF PAGES: 002
AUTHOR: Cynthia J. Kaleri, Remedial Project
Manager, Texas Remedial Section
COMPANY/AGENCY: U.S. EPA Region VI
RECIPIENT: U.S. EPA Region VI Files
DOCUMENT TYPE: Memorandum
DOCUMENT TITLE: Re: Trip report concerning Stewco's Field
Audit of February 22, 1988

DOCUMENT NUMBER: 114
DOCUMENT DATE: 06/16/88
NUMBER OF PAGES: 006
AUTHOR: Cynthia J. Kaleri, Remedial Project
Manager, Texas Remedial Section
COMPANY/AGENCY: U.S. EPA Region VI
RECIPIENT: U.S. EPA Region VI Files
DOCUMENT TYPE: Memorandum
DOCUMENT TITLE: Stewco, Inc. Remedial
Investigation/Feasibility Study Fieldwork
Audit; February 2 - 3, 1988

ADMINISTRATIVE RECORD INDEX

FINAL

SITE NAME: Stewco, Inc.
SITE NUMBER: TXD 0980699656

DOCUMENT NUMBER: 115
DOCUMENT DATE: 06/16/88
NUMBER OF PAGES: 003
AUTHOR: Greg Tipple, Remedial Investigation Unit
Head, Superfund Section, Hazardous and
Solid Waste Division
COMPANY/AGENCY: Texas Water Commission
RECIPIENT: Cynthia J. Kaleri, Remedial Project
Manager, Texas Remedial Section, U.S. EPA
Region VI
DOCUMENT TYPE: Correspondence and Attachments
DOCUMENT TITLE: Re: Texas Water Commission comments on the
draft Remedial Investigation report and
Risk Assessment for the Stewco, Inc. site in
Waskom, Harrison County, TX

DOCUMENT NUMBER: 116
DOCUMENT DATE: 06/21/88
NUMBER OF PAGES: 001
AUTHOR: Greg Tipple, Remedial Investigation Unit
Head, Superfund Section, Hazardous and
Solid Waste Division
COMPANY/AGENCY: Texas Water Commission
RECIPIENT: Robin Gelston-Walls, Texas State
Coordinator, U.S. EPA Region VI
DOCUMENT TYPE: Correspondence
DOCUMENT TITLE: Re: Applicable or Relevant and Appropriate
Requirements (ARAR's) for the Stewco Inc.
site in Waskom, Harrison County, TX

DOCUMENT NUMBER: 117
DOCUMENT DATE: 06/22/88
NUMBER OF PAGES: 001
AUTHOR: Stanley G. Hitt, Chief, Texas Remedial
Section
COMPANY/AGENCY: U.S. EPA Region VI
RECIPIENT: Guanita Reiter, Chief, Oversight Section,
U.S. EPA Region VI
DOCUMENT TYPE: Memorandum
DOCUMENT TITLE: Re: Superfund/RCRA Coordination in
Resolution of an Identified Groundwater
Problem in East Texas

ADMINISTRATIVE RECORD INDEX

FINAL

SITE NAME: Stewco, Inc.
SITE NUMBER: TXD 0980699656

DOCUMENT NUMBER: 118
DOCUMENT DATE: 06/27/88
NUMBER OF PAGES: 002
AUTHOR: Cynthia J. Kaleri, Remedial Project
Manager, Texas Remedial Section
COMPANY/AGENCY: U.S. EPA Region VI
RECIPIENT: John P. McCann, Site Manager, ICF
Technology Company
DOCUMENT TYPE: Correspondence and Attachments
DOCUMENT TITLE: Re: Ms. Kaleri's comments on Texas Water
Commission's comments for the draft
Remedial Investigation Report

DOCUMENT NUMBER: 119
DOCUMENT DATE: 06/28/88
NUMBER OF PAGES: 008
AUTHOR: Victor Chapman, ESAT, Houston Branch
COMPANY/AGENCY: U.S. EPA Region VI
RECIPIENT: David Cook, U.S. EPA Region VI
DOCUMENT TYPE: Sample Data
DOCUMENT TITLE: Quality Assurance/Quality Control
Compliance Review of Contract Compliance
Screening (CCS) Resubmitted Data

DOCUMENT NUMBER: 120
DOCUMENT DATE: 07/29/88
NUMBER OF PAGES: 001
AUTHOR: Jerry W. Mullican, Director of Underground
Injection Control, Oil and Gas Division
Railroad Commission of Texas
COMPANY/AGENCY: Railroad Commission of Texas
RECIPIENT: David H. Sorrell, P.E., Chief, Superfund
Section, Texas Water Commission
DOCUMENT TYPE: Correspondence
DOCUMENT TITLE: Re: Determinations of ARAR's for the
Stewco, Inc. site, Tarrant County, Texas

ADMINISTRATIVE RECORD INDEX

FINAL

SITE NAME: Stewco, Inc.
SITE NUMBER: TXD 0980699656

DOCUMENT NUMBER: 121
DOCUMENT DATE: 08/04/88
NUMBER OF PAGES: 043
AUTHOR: Carl Edlund, Branch Chief, Cynthia Kaleri,
Remedial Project Manager, Laura Price,
Community Relation
COMPANY/AGENCY: U.S. EPA Region VI
RECIPIENT: U.S. EPA Region VI Site Files
DOCUMENT TYPE: Transcript
DOCUMENT TITLE: Re: Public meeting on the Proposed Plan of
Action for the Stewco, Inc. site

DOCUMENT NUMBER: 122
DOCUMENT DATE: 08/09/88
NUMBER OF PAGES: 033
AUTHOR: Lawrence E. Pewitt, P.E., Director, Permits
Division
COMPANY/AGENCY: Texas Air Control Board
RECIPIENT: David H. Sorrells, P.E., Chief, Superfund
Section, Texas Water Commission
DOCUMENT TYPE: Correspondence and Attachments
DOCUMENT TITLE: Re: ARAR's for Stewco Inc. site, that
exceeds federal requirements for the
remedial alternatives that are being
considered

DOCUMENT NUMBER: 123
DOCUMENT DATE: 08/16/88
NUMBER OF PAGES: 001
AUTHOR: L.D. Thurman, P.E., Chief, Bureau of
Environmental Health
COMPANY/AGENCY: Texas Department of Health
RECIPIENT: Bryan W. Dixon, P.E., Director, Hazardous
and Solid Waste Division, Texas Water
Commission
DOCUMENT TYPE: Correspondence
DOCUMENT TITLE: Re: Applicable ARAR's which may apply to
the remedial action proposals for the
Stewco, Inc. site

ADMINISTRATIVE RECORD INDEX

FINAL

SITE NAME: Stewco, Inc.
SITE NUMBER: TXD 0980699656

DOCUMENT NUMBER: 124
DOCUMENT DATE: 08/22/88
NUMBER OF PAGES: 001
AUTHOR: Geraldo H. Garcia, Remedial Investigation
Unit, Superfund Section
COMPANY/AGENCY: Texas Water Commission
RECIPIENT: Robin Gelston-Walls, Texas State
Coordinator, U.S. EPA Region VI
DOCUMENT TYPE: Correspondence
DOCUMENT TITLE: Re: Identification of ARAR's for the
Stewco, Inc. Superfund site

DOCUMENT NUMBER: 125
DOCUMENT DATE: 08/23/88
NUMBER OF PAGES: 001
AUTHOR: Geraldo H. Garcia, Remedial Investigation
Unit, Superfund Section,
COMPANY/AGENCY: Texas Water Commission
RECIPIENT: Cynthia Kaleri, Remedial Project Manager,
Texas Remedial Section, U.S. EPA Region VI
DOCUMENT TYPE: Correspondence
DOCUMENT TITLE: Re: Written comments concerning the draft
Record of Decision (ROD) for the Stewco,
Inc. Superfund site

DOCUMENT NUMBER: 126
DOCUMENT DATE: 09/08/88
NUMBER OF PAGES: 002
AUTHOR: Geraldo H. Garcia, Superfund Section,
Hazardous and Solid Waste Division
COMPANY/AGENCY: Texas Water Commission
RECIPIENT: Cynthia Kaleri, Remedial Project Manager,
U.S. EPA Region VI
DOCUMENT TYPE: Transmittal Letter
DOCUMENT TITLE: Re: Texas Water Commission comments on
Stewco, Inc. Superfund site's
Responsiveness Summary

ADMINISTRATIVE RECORD INDEX

FINAL

SITE NAME: Stewco, Inc.
SITE NUMBER: TXD 0980699656

DOCUMENT NUMBER: 130
DOCUMENT DATE: 09/16/88
NUMBER OF PAGES: 001
AUTHOR: Cindy Kaleri, Remedial Project Manager,
Texas Remedial Section
COMPANY/AGENCY: U.S. EPA Region VI
RECIPIENT: George Pettigrew, Region VI Representative,
Agency for Toxic Substance and Disease
Registry
DOCUMENT TYPE: Record of Communication
DOCUMENT TITLE: Re: Draft Health Assessment for the
Stewco, Inc. Superfund site. in Waskom,
Harrison County, TX, that was sent by R.
William Knouse, ATSDR, Atlanta

DOCUMENT NUMBER: 131
DOCUMENT DATE: 09/16/88
NUMBER OF PAGES: 040
AUTHOR: Texas Remedial Section Staff
COMPANY/AGENCY: U.S. EPA Region VI
RECIPIENT: U.S. EPA Region VI Site Files
DOCUMENT TYPE: ROD and Attachments
DOCUMENT TITLE: Record of Decision for the Stewco, Inc.
Superfund site, in Waskom, Harrison County,
TX

ENVIRONMENTAL
PROTECTION
AGENCY
DALLAS, TEXAS
LIBRARY